

[Handwritten signature]



Recorded this
Day of Dec^r 1781
Deliver to Capt. James

State of South Carolina

Pursuant to a warrant from John Thomas
 Esq. Commissioner of Locations dated the 11th day of Aug^t 1781
 have I do measure and laid out unto Lewis Saxson Two
 hundred and fifty acres of land situate in Ninety
 six District on a branch of a River called Hendrick's Creek
 below the Ancient Boundary line bounded North on Ebenezer
 Ship and land laid out upon the Widow Hannah's lot on the
 James Farmer and James Wallace's land and on the
 above said shape and marks as the above plat represents

State of South Carolina Surveyed by me this 20th day of Oct^r 1781

Pursuant to a
 Warrant from John Thomas Esq.
 Commissioner of Locations dated
 the 11th day of Aug^t 1781 I have
 do measure and laid out unto
 Lewis Saxson a tract of land
 containing 150 Acres of land
 situate in Ninety six district
 on a branch of the Rudy River
 called Walnut Creek below
 the Ancient Boundary line
 bounded North on James
 Lindley's land and on William
 McCoy's land and all other
 sides on vacant land and
 hath such shape and marks
 as the above plat represents

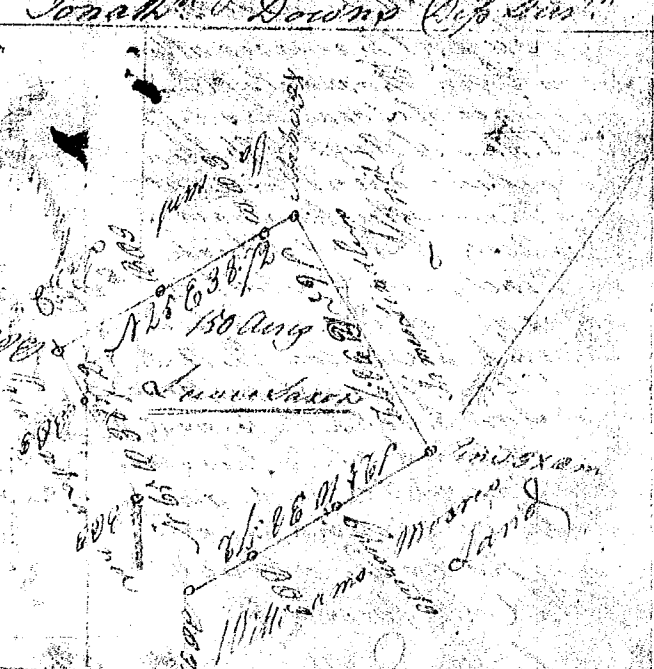

Surveyed by me this 21st day of Oct^r 1781

Jonathan Cowley Deput