

State of South Carolina

(236)

Pursuant to a warrant from John Thomas Esq. Commissioner of Locations dated 31st of August 1784 I have admeasured and laid out unto John Alexander a tract of one hundred & Ninety four acres of land Situate in Ninety six District West of the ancient Boundary line on Lachman's fork of the Needy fork of Cuddy River Bounding on all sides by Vacant Land & hath such stake & marks as the annexed plat Represents Survey this 31st Day of Aug. 1784
 Recorded this 10th Dec. 1784

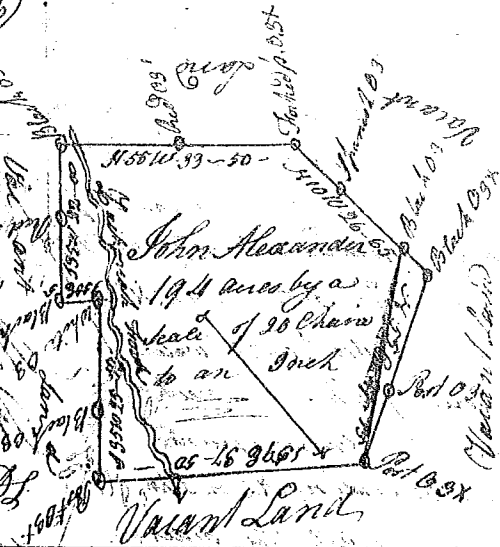

State of Carolina

Pursuant to a warrant from John Thomas Esq. Com. of Locations dated the 2^d July 1784 I have admeasured & laid out unto David McKay a tract of one hundred & Eleven acres of land Situate in Ninety six District West of the ancient Indian Boundary on the branches of North fork Santee River Bounding N. of Henry Wood's N.E. of John Goodlett's & on all other sides on Vacant Land and hath such stake & marks as the annexed plat Represents Survey this 27th of Sept. 1784
 Recorded this 10th of Dec. 1784



State of South Carolina

Pursuant to a warrant from John Thomas Esq. Commissioner of Locations dated the 16th July 1784 I have admeasured & laid out unto Stephen Vaughn a tract of Three hundred & Sixty one acres of land Situate in Ninety six District East of the ancient Indian Boundary line on the upper most branch of the upper fork of the Needy fork of Cuddy River Bounding N.E. on land laid out to William Foster & Water from Dixon S.E. to M. Blucas and on all other sides by Vacant Land and hath such stake & marks as the above plat Represents Survey this 15th Sept. 1784
 Recorded this 10th Dec. 1784

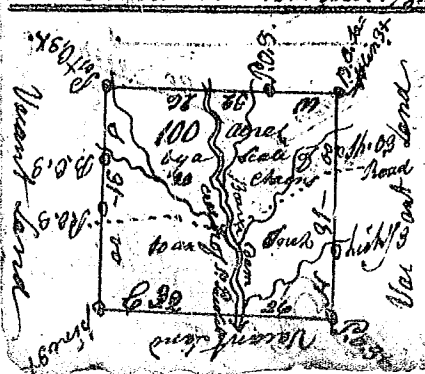
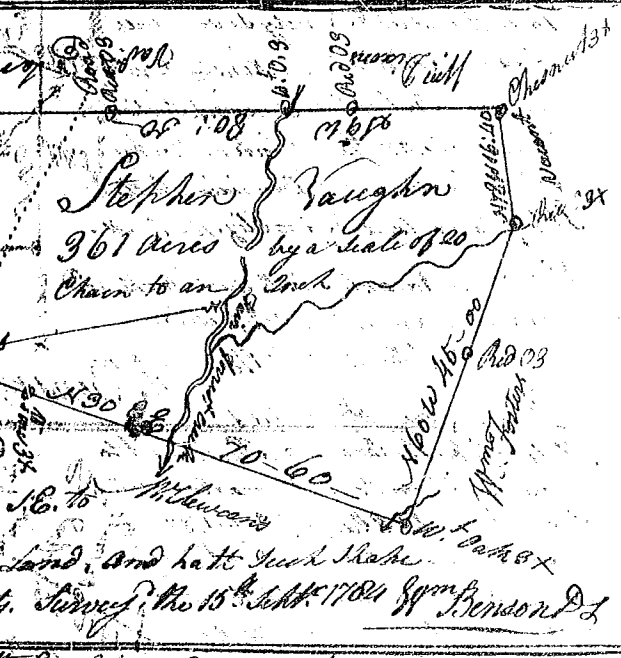

State of South Carolina Pursuant to a warrant from John Thomas Esq. Com. of Locs. dated the 6th of August 1784 I have admeasured & laid out unto Daniel McColhoma a tract of one hundred acres of land Situate in Ninety six District East of ancient Indian Boundary line on the Beaver dam creek of the Needy River Bounding on all sides by Vacant Land & hath such stake & marks as the annexed plat Represents Survey this 23rd of Oct. 1784
 Recorded this 10th Dec. 1784

Wm Benson Esq.