

State of South Carolina

257

Pursuant to a warrant from John Thomas Esq. Com' of Location bearing date the 15th of Sept. 1784 I have re-measured & laid out unto Anquish Campbell a tract of land containing one hundred & forty acres situated in the District of Ninety Six

in the waters of Enoree River below the ancient boundary bounding John Black's stock land & one Adams land & Alexander Caldwell's land and Caroleys land on land of one Linches & Moses Hatcher's land, all on lands of Thomas Murphy & hath such stakes form land marks as the annexed plat represents

Survey, the 10th Oct. 1784

by John Thomas Esq. Com' of Location
Recorded the 29th Nov. 1784

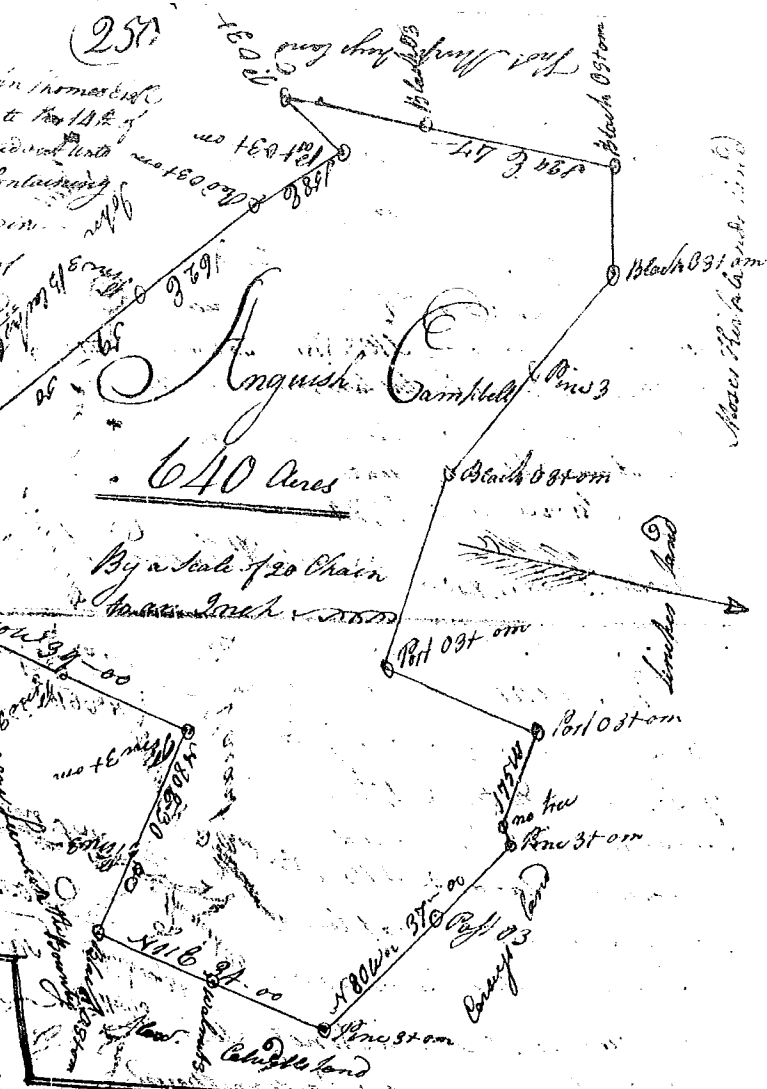

640 Acres

By a scale of 20 Chain
to an Inch

State of South Carolina

Pursuant to a warrant from

John Thomas Esq. Com' of Location bearing date the 15th of Sept. 1784 I have laid out unto David Caldwell a tract of land containing 300 acres situated in the District of Ninety Six

in the waters of Raytowns Creek or Peedy River below the ancient boundary bounding all on land of Nathaniel Hamiltons & on land of Wm. Aubrey & on land of Thos. Cook & on land of Lewis Brantion & hath such stakes form land marks as the annexed plat represents

Survey, the 25th Nov. 1784

Recorded the 29th Nov. 1784

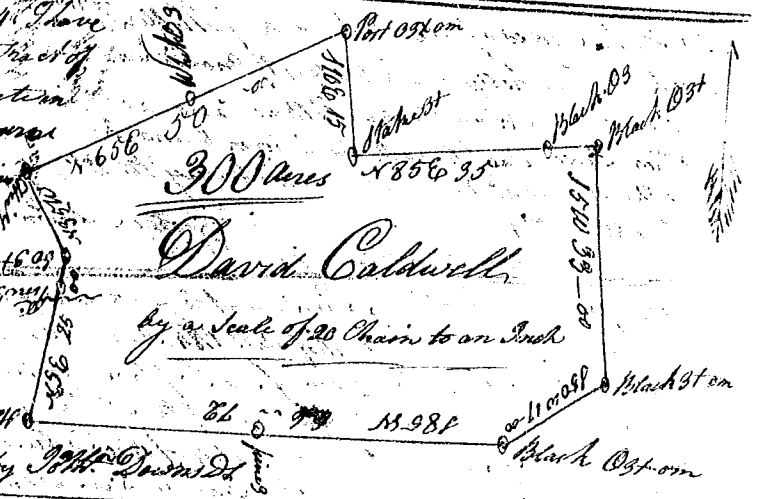

300 Acres

David Caldwell

by a scale of 20 Chain to an Inch

State of South Carolina

Pursuant to a warrant from John Thomas Esq. Com' of Location dated the 14th of Sept. 1784 I have re-measured & laid out unto Drury Harrington a tract of land containing one hundred & fifty acres situated in the District East of the old boundary on a branch of Quinceys creek of the waters of Broad River

bounded by John Thomas's provision all other sides except the North side & hath such stakes form land marks as the annexed plat represents

Survey, the 25th Sept. 1784

Recorded the 15th Dec. 1784



150 Acres

Drury Harrington

by a scale of 20 Chain to an Inch

James Browns land

George Salmon