

State of South Carolina  
 Pursuant to a warrant from John Thomas Esq. Com. Suror dated the 23<sup>rd</sup> day of Aug. 1784 I have admeasured & laid out unto Jeremiah Fowler a tract of land containing 300 acres. Situated in 9<sup>th</sup> District East of the Old Boundary on both sides of Cass creek of Cherokee River Broad River Boundary on all sides on Nat. and cont. both such from & marks as the former Plat represents. Surveyed the 13<sup>th</sup> Sept. 1784

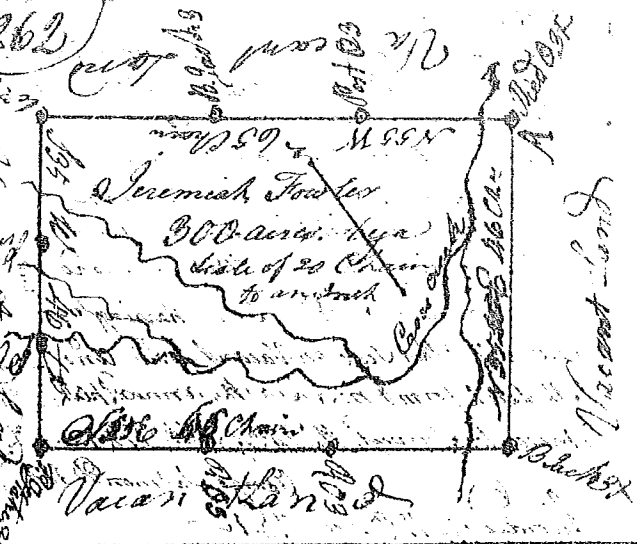

Recorded the 18<sup>th</sup> Dec. 1784  
 Geo. Salmon D. Sur.

State of South Carolina  
 Pursuant to a warrant from John Thomas Esq. Com. Suror dated the 25<sup>th</sup> of August 1784 I have admeasured & laid out unto Joseph Churchland a tract of land containing 204 acres. Situated in the 9<sup>th</sup> District East of the Old Boundary on both sides of a branch of Cherokee Creek waters of Enoree River Youngs Run & W. on land laid out for Joshua Thomas Esq. on W. on Fowler's land all other sides on Va. land & north side such from & marks as the former Plat represents. Surveyed the 30<sup>th</sup> & 31<sup>st</sup> of August 1784 George Salmon D. Sur.

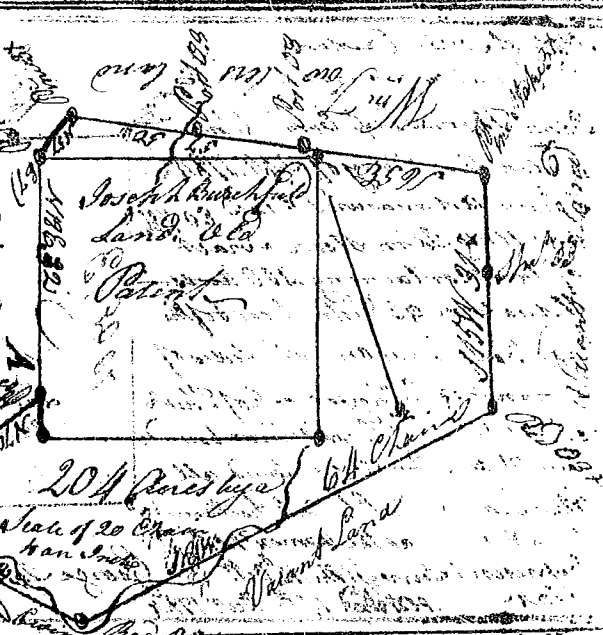

Recorded the 18<sup>th</sup> Dec. 1784  
 Geo. Salmon D. Sur.

State of South Carolina  
 Pursuant to a warrant from John Thomas Esq. Com. Suror dated the 25<sup>th</sup> of Aug. 1784 I have admeasured & laid out unto John Arnold a tract of land containing four hundred & twenty acres. Situated in Ninety six District East of the Old Boundary on both sides of Cherokee Creek of Broad River Boundary on the N. W. on Va. land and Thomas Bonner's land W. on Thomas Bonner's land & on John Arnold's land. All other sides on Va. land & north side such from & marks as the former Plat represents. Surveyed the 6<sup>th</sup> Sept. 1784



Recorded the 18<sup>th</sup> Dec. 1784  
 Geo. Salmon D. Sur.

Recorded the 18<sup>th</sup> Dec. 1784  
 Geo. Salmon D. Sur.