

State of South Carolina

(265)

Pursuant to a warrant from John Thomas Esq. Commissioner of Locations

dated the 16th day of Aug. 1784. I have examined & laid out unto Thomas Cole a Tract of Land containing Two Hundred acres Situated in Ninety six District East of the Ancient Boundary on the Beaverdam fork of Thickety creek upper of Broad River Bounding on all sides on Vacant Land & hath such form & marks as the annexed plat Represents Survey the 6th of Sept. 1784

Recorded the 31st day of Dec. 1784 Geo. Salmon Esq.

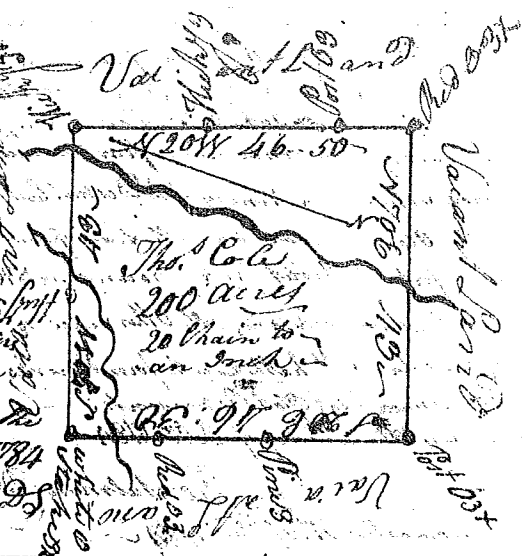

State of South Carolina Pursuant to a warrant from John Thomas Esq. Commissioner of Locations dated the 23rd day of Aug. 1784. I have examined & laid out unto John Dewberry a Tract of Land containing Two Hundred acres Situated in 96 District East of the Old Boundary on both sides of Buddocks fork of Thickety creek waters of Broad River Bounding on all sides on Vacant Land & hath such form & marks as the annexed plat Represents Survey the 23rd day of Aug. 1784

Recorded the 31st day of Dec. 1784 Geo. Salmon Esq.



State of South Carolina Pursuant to a warrant from John Thomas Esq. Commissioner of Locations dated the 18th day of August 1784. I have examined & laid out unto John Foster a Tract of Land containing One Hundred acres Situated in Ninety six District East of the Old Boundary on both sides of Thickety creek of Broad River Bounding on all sides on Vacant Land and hath such form & marks as the annexed plat Represents Survey the 8th of Sept. 1784

Recorded the 31st day of Dec. 1784 Geo. Salmon Esq.



State of South Carolina

Pursuant to a warrant from John Thomas Esq. Commissioner of Locations dated the 15th day of Aug. 1784. I have examined & laid out unto Matthew Gentry a Tract of Land containing Two Hundred acres Situated in Ninety six District East of the Old Boundary on both sides of Thickety creek of Broad River Bounding on all sides on Vacant Land and hath such form & marks as the annexed plat Represents Survey the 25th of Aug. 1784

Recorded the 31st day of Dec. 1784 Geo. Salmon Esq.



Recorded the 31st day of Dec. 1784 Geo. Salmon Esq.

Laid down by a scale of 20 Chain to an Inch