

336) North Carolina

Pursuant to a warrant from John Thomas Esquire Comr. of Saluda

I have admeasured & laid out unto Wm Gauguens a tract of land containing one hundred forty four acres situate on the waters of Little river bounding to the N. on land of S. Gaccin, to the S. on land of Henry Butters & Co on land Philip Tragers East on land of John Christons & James Planket and hath such firm marks as the above State represents.

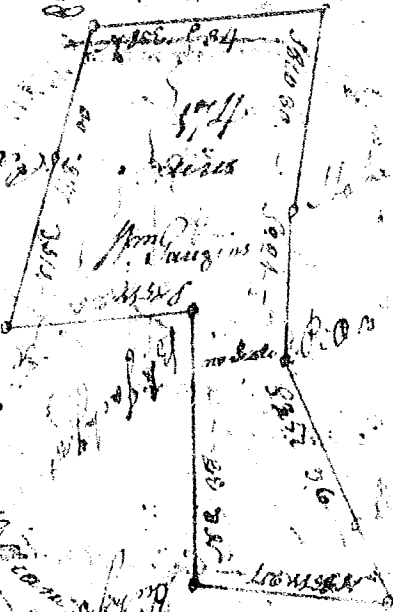

Certified the 1<sup>st</sup> July 1788 Wm Callwell Esq. Surveyor

Recorded 23<sup>rd</sup> Feb<sup>y</sup> 1789

North Carolina Pursuant to a warrant from John Thomas Esq. Comr. of Saluda dated the 3<sup>rd</sup> May 87 I have admeasured

laid out unto Henry Willson a tract of 320 acres of land bounded by the above named persons and her such firm marks as the above State represents. Surveyed the 18<sup>th</sup> July 1787

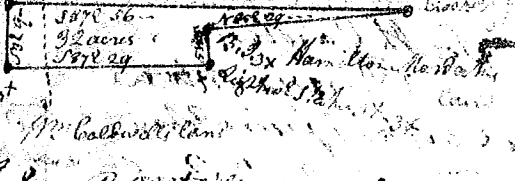

Recorded 23<sup>rd</sup> Feb<sup>y</sup> 1788

North Carolina Pursuant to a warrant from John Thomas Esq. Comr. of Saluda dated the 3<sup>rd</sup> May 87 I have admeasured & laid out unto Henry Willson a tract of Ten acres of land situate in S. District on a branch of Little river; bounded by the above named persons and hath such firm marks as the above State represents.

Surveyed the 18<sup>th</sup> July 1787

Recorded the 23<sup>rd</sup> Feb<sup>y</sup> 1788  
North Carolina Pursuant to a warrant from John Thomas Esq. Comr. of Saluda dated the 3<sup>rd</sup> May 87 I have admeasured & laid out unto Henry Willson a tract of land on the Downy containing 30 acres of situate on the waters of Saluda river bounding to the N. on land of John Lewis West on land of James Planket & Co on land of Gibson Jones. Certified the 13<sup>th</sup> July 1787



Will. Callwell Esq.

Recorded 23<sup>rd</sup> Feb<sup>y</sup> 1789 Wm Gauguens the Surveyor on the boundary of Henry Willson the not specified in the Certificate