

South Carolina Pursuant to a warrant
 from John Thomas Esq. Clerk of the
 District dated the 24th Aug. 1793. I have
 administered and laid out unto
 North Middleton a tract of land in
 said District containing one thousand
 acres lying on a branch of Saluda River
 in Greenville County. I have marked
 the same with markers, battens & bounding
 as the above plat represents.
 Done this 31st Aug. 1793
 Tho. Middleton

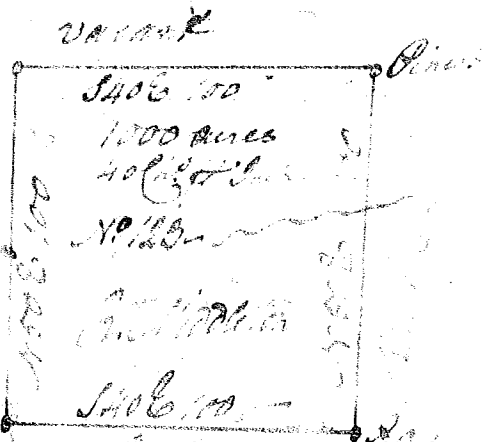

Recorded the 13th Dec. 1794
 South Carolina Pursuant to a warrant
 from John Thomas Esq. Clerk of the
 District dated the 24th Aug. 1793. I have
 administered and laid out unto
 North Middleton a tract of land in
 said District containing one thousand
 acres lying on a branch of Saluda
 River in Greenville County. I have marked
 the same with markers, battens & bounding
 as the above plat represents.
 Done this 31st Aug. 1793
 Tho. Middleton

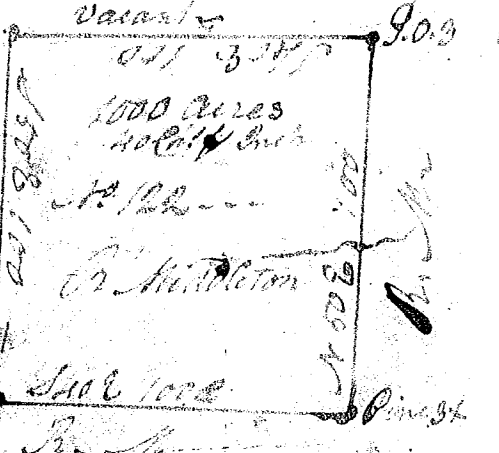

Recorded the 13th Dec. 1794
 South Carolina Pursuant to a warrant
 from John Thomas Esq. Clerk of the
 District dated the 24th Aug. 1793. I have
 administered and laid out unto
 North Middleton a tract of land in
 said District containing one thousand
 acres lying on a branch of Saluda River
 in Greenville County. I have marked
 the same with markers, battens & bounding
 as the above plat represents.
 Done this 31st Aug. 1793
 Tho. Middleton

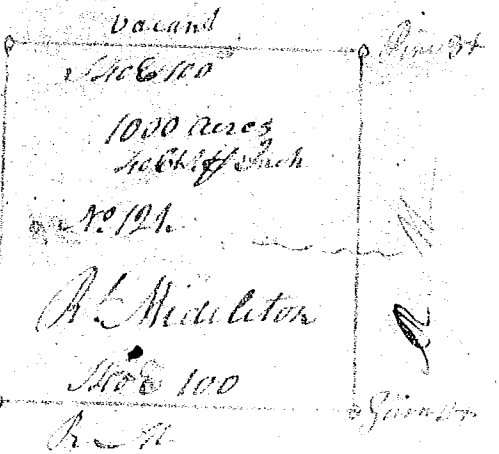

Recorded the 13th Dec. 1794
 South Carolina Pursuant to a warrant
 from John Thomas Esq. Clerk of the
 District dated the 24th Aug. 1793. I have
 administered and laid out unto
 North Middleton a tract of land in
 said District containing one thousand
 acres lying on a branch
 of Saluda River in Greenville County.
 I have marked the same with markers, battens &
 bounding as the above plat represents.
 Done this 31st Aug. 1793
 Tho. Middleton

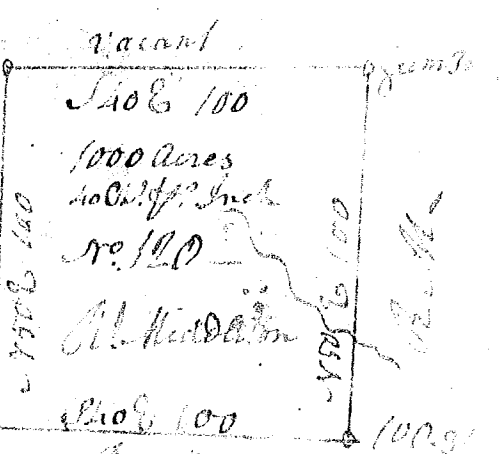

Recorded the 13th Dec. 1794
 By Tho. Middleton