

State of South Carolina (5)

Pursuant to a Warrant from John Thomas Esq. Commissioner of Locations, Dated the 12<sup>th</sup> day of Oct. 1784. I have Admeasured and laid out unto William Wood son of Moses, a Tract of Land Containing Three Hundred and Twenty Acres, Situate in Ninety Six District East of the Old Boundary, on both sides of Thorley creek of Lawson's Fork Waters of Broad River, Bounding N. Eastwardly on Thomas Bennett & Vacant Land S. on P. Bennett & Vacant Land all other sides on Vacant Land and hath such shape and marks as the annexed Plat Represents, Surveyed the 22<sup>nd</sup> Oct. 1784.  
Recorded the 21<sup>st</sup> Jan'y 1785. George Salmon D. Sur.

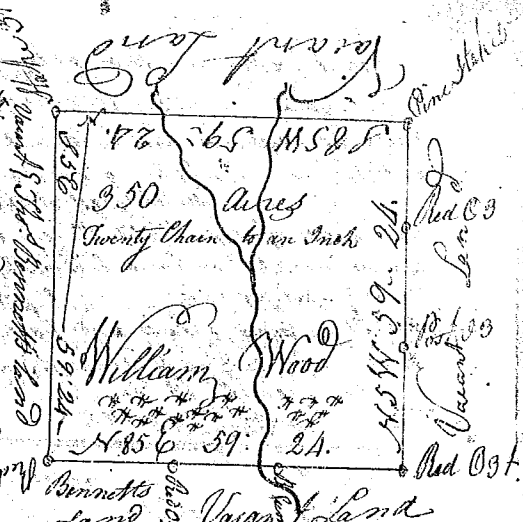

State of South Carolina, Pursuant to a Warrant from John Thomas Esq. Commissioner of Locations, Dated the 26<sup>th</sup> of Sept. 1784. I have admeasured and laid out unto James Blackwell a Tract of Land containing Four Hundred Acres, Situate in Ninety Six District East of the Old Boundary, on both sides of such creek of Broad River, Bounding on all sides on Vacant Land and hath such form & marks as the annexed plat Represents Surveyed the 12<sup>th</sup> day of Oct. 1784.

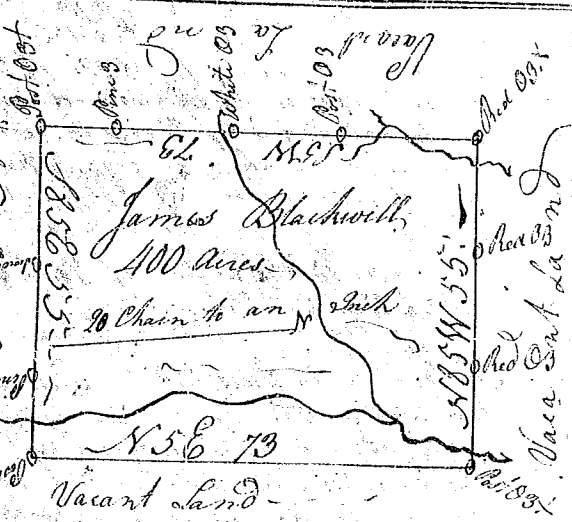

Recorded the 21<sup>st</sup> Jan'y 1785. George Salmon D. Sur.

State of South Carolina

Pursuant to a Warrant from John Thomas Esq. Commissioner of Locations (Dated the 28<sup>th</sup> day of Nov. 1784). I have Admeasured and laid out unto Thomas Still a Tract of Land containing Four Hundred Acres, Situate in Ninety Six District West of the Old Boundary on both sides of Bush creek of Enore River Bounding on all sides on vacant Land and hath such shape and marks as the annexed plat Represents



Surveyed the 4<sup>th</sup> day of Dec. 1784. Recordd the 21<sup>st</sup> Jan'y 1785. George Salmon D. Sur.

State of South Carolina

Pursuant to a warrant Laid down by a scale of 20 Chain to an Inch. from John Thomas Esq. Commissioner of Locations dated the 30<sup>th</sup> day of Sept. 1784. I have Admeasured and laid out unto Mary Jones a Tract of Land containing One Hundred & Forty Acres Situate in Ninety Six District East of the Old Boundary on both sides of Coward Creek of the Katty Waters of Broad River Bounding S. Eastwardly on David Allins Land Westwardly on David Humphreys Land all other sides on Vacant Land and hath such shape and marks as the above plat Represents Surveyed the 1<sup>st</sup> Dec. 1784.

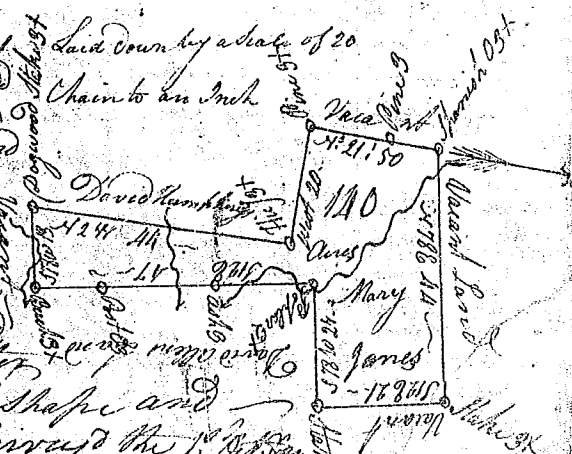

Recorded the 21<sup>st</sup> Jan'y 1785. George Salmon D. Sur.

George Salmon D. Sur.