

State of South Carolina

Pursuant to a warrant from John Thomas Esq. Commissioner of Locations in 96 District No. Saluda River. I have admeasured and laid out unto David Sawyer a tract of Land containing five hundred and forty acres, on Cone Creek of Saluda River east of the Indian boundary in said District, and hath such shape marks and boundaries as the annexed Plat represents.

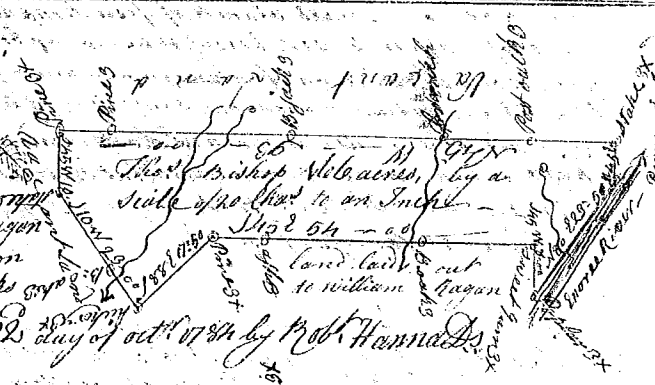

State of South Carolina Pursuant to a warrant from John Thomas Esq. Commissioner of Locations in 96 District No. Saluda River. I have admeasured and laid out unto Thomas Bishop a tract of Land containing one hundred and sixty acres, on the N. side of Snowe Run below the Indian boundary bounded S. by said River & by land laid out to William Hagan N. on Joseph Pearson's Land, all other sides on Vacant Land, and hath such shape and marks as the above Plat represents.



State of South Carolina Pursuant to a warrant from John Esq. Commissioner of Locations in 96 District No. Saluda River. I have admeasured and laid out unto James Finley a tract of Land containing three hundred and twenty acres on the South fork of Duncan's Creek below the Indian boundary, bounding N. and N.W. part on Land laid out to John Pollock, and Part on Land laid out to James Pollock and Part on Land laid out to Samuel Ewing, W. by on Land laid out to Elizabeth Walcutt, all other sides on Vacant Land, and hath such shape and marks as the annexed Plat represents.

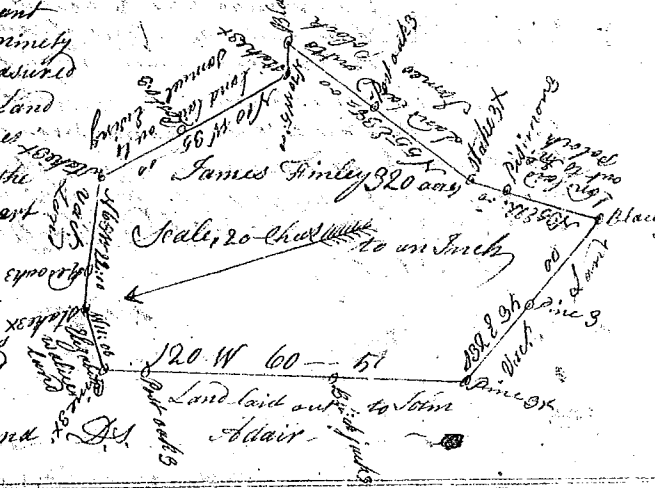

State of S. Carolina Pursuant to a warrant from John Thomas Esq. Com. Locations in 96 District No. Saluda River. I have admeasured and laid out unto William Teague a Tract of 200 acres of Land on Baywards Creek below the Indian boundary, bounding S. by on John Cannon's N. by on John M. Davis S. on Lewis Saxon all other sides on Land laid out to the Owners mentioned, & hath such shape and marks as the annexed Plat represents.

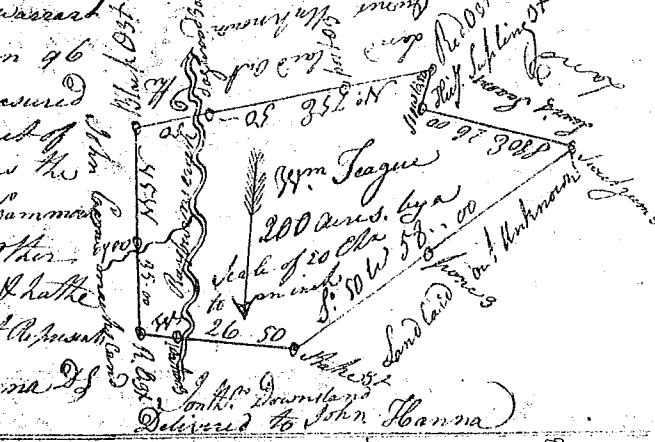

State of S. Carolina Pursuant to a warrant from John Thomas Esq. Com. Locations in 96 District No. Saluda River. I have admeasured and laid out unto Adam Gordon a Tract of 100 acres of Land on a branch of Duncan's Creek below the Indian boundary bounding N.W. by on Land laid out to Philimon Harvey & W. on Land laid out to John Cunningham & all other sides Vacant, & hath such shape and marks as the annexed Plat represents.

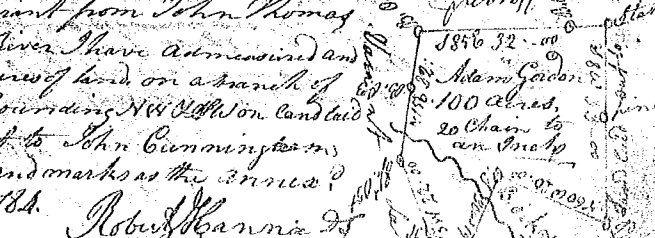

Recorded the 3rd February 1785

Robert Hanna Esq. Surveyed to John Hanna