

State of South Carolina

(27)

Pursuant to a warrant from John Thomas Esq. Commissioner of Locations in Ninety six District North Saluda River I have admeasured and laid out unto Hulet Sullewant tract of Land containing seventy one acres, on the branch creek, below the Indian Boundary, bounded N.W. on Covingham's land, all other sides the owners unknown and hath such shape and Marks as the above Plat Represents.  
Surveyed 10 November 1784 by Robert Hanna D.S.  
Recorded 9th febr. 1785



State of South Carolina

Pursuant to a warrant from John Thomas Esq. Commissioner of Locations in Ninety six District No Saluda River, I have admeasured and laid out unto Nathaniel Newman tract of Land containing three hundred acres on the branches of Emory and Derbins Creek below the Indian boundary bounded N. on Edward Pugh's land, N.W. on Holaway Power's land, S. on land laid out to Hodelai Moore, all other sides on Vacant Land, and hath such shape and Marks as the annexed Plat Represents.  
Surveyed the 19th Nov. 1784 Robt. Hanna D.S.  
Recorded 10 febr. 1785

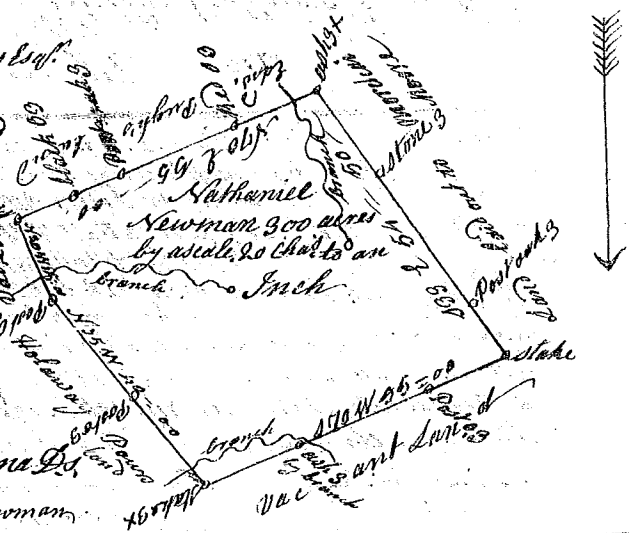

State of South Carolina

Pursuant to a warrant from John Thomas Esq. Commissioner of Locations in Ninety six District No Saluda River, I have admeasured and laid out unto William Taylor tract of Land containing one hundred and thirty six acres, on the branch of Little River, below the Indian Boundary, bounding E. on land laid out to Robert Tinsley N.W. on land laid out to William Price N.W. on John Tinsley's land N.E. on land laid out to Ellenor Spence, and hath such other Marks and boundaries as the above Plat Represents.  
Surveyed 21 Sept. 1784 by Robert Hanna D.S.  
Recorded 10 febr. 1785

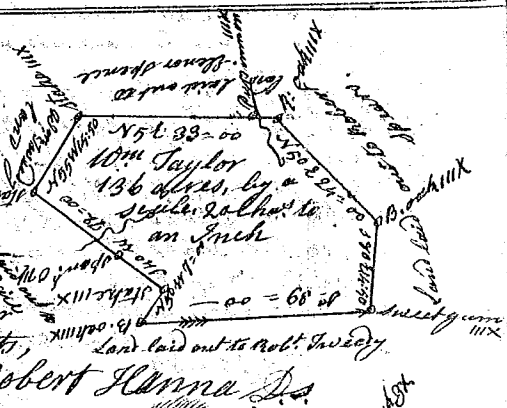

State of South Carolina

Pursuant to a warrant from John Thomas Esq. Commissioner of Locations in Ninety six District No Saluda River, I have admeasured and laid out unto William Taylor tract of Land containing one hundred acres on a branch of Little River called Todd Creek below the Indian boundary, bounding S. on land laid out to Michael Waldrop, S.W. on land laid out to Robert Tinsley and now in Possession of John Copeland, all other sides on Vacant Land, and hath such shape and Marks as the above Plat Represents.  
Surveyed 22 Sept. 1784 by Robert Hanna D.S.  
Recorded 10th febr. 1785

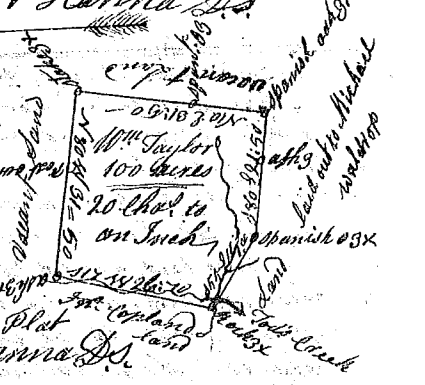

State of South Carolina

Pursuant to a warrant from John Thomas Esq. Commissioner of Locations in Ninety six District North Saluda River, I have admeasured and laid out unto John Stephens tract of Land containing one hundred and forty five acres, on the North side of Saluda River below the Indian Boundary, bounding S.E. by said River E. by said River claimed by said John Stephens S.W. by land laid out to Samuel Hughson and vacant Land, and hath shape and Marks as the above Plat Represents.  
Surveyed the 14th Nov. 1784  
Recorded 10th febr. 1785

