

State of S<sup>c</sup> Carolina Pursuant to a warrant from  
 John Thomas Commissioner of Locations in Ninety  
 six district of Saluda river, I have admeasured and  
 laid out unto Robert Wood a tract of Land containing  
 Two hundred and fifty acres on the south side  
 of Enoree River below the Indian Boundary  
 Bounding SW on land laid out to James Dono  
 all other sides on Vacant Land, and hath  
 shape and Marks as the annexed Plat  
 Represents, Survey'd 31 Dec<sup>r</sup> 1784  
 Recorded 19<sup>th</sup> Feby<sup>r</sup> 1785. By Rob<sup>t</sup> Hanna D<sup>ca</sup>

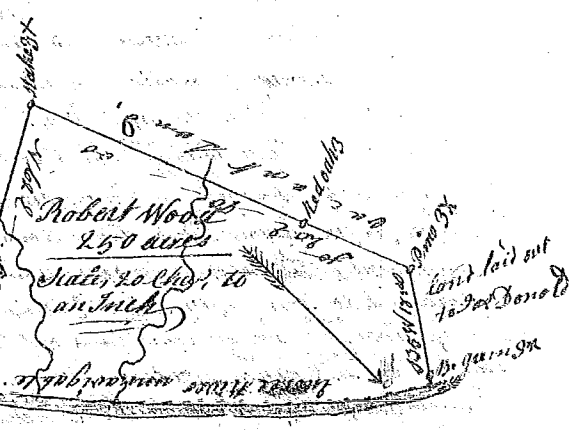

State of S<sup>c</sup> Carolina Pursuant to a warrant from John Thomas  
 Commissioner of Locations dated the 4<sup>th</sup> day of Oct<sup>r</sup> 1784, I have  
 admeasured and laid out unto John Brooks a tract of one  
 hundred and ninety one acres of land, situate in Ninety six  
 district East of the Indian Boundary, on the S<sup>th</sup> fork of the S<sup>th</sup>  
 fork of Tyger River, bounding on all sides on Vacant Land &  
 hath such shape and Marks as the annexed Plat Represents  
 Survey'd 9<sup>th</sup> day Nov<sup>r</sup> 1784, by Robert Hanna D<sup>ca</sup>  
 Recorded the 19<sup>th</sup> Feby<sup>r</sup> 1785. W<sup>m</sup> Benson D<sup>ca</sup>

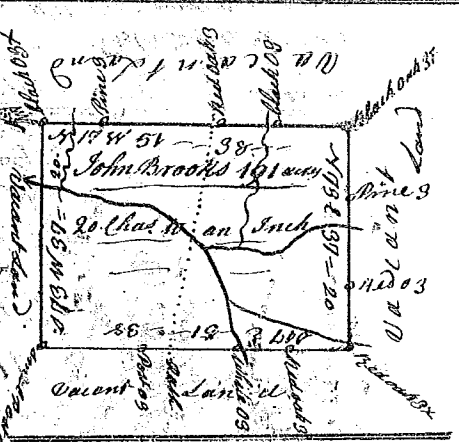

State of S<sup>c</sup> Carolina Pursuant to a warrant from John Thomas Esq<sup>r</sup>  
 Commissioner of Locations dated the 3<sup>d</sup> day of Feby<sup>r</sup> 1785, I have  
 admeasured and laid out unto John Leach a tract of one hundred  
 and sixteen acres of land, situate in Ninety six district East of the  
 ancient Boundary of the south fork of the North fork of Tyger River  
 bounding on all sides on Vacant Land, and hath such shape and  
 Marks as the annexed Plat Represents, Survey'd 1<sup>st</sup> Feby<sup>r</sup> 1785,  
 recorded 19<sup>th</sup> Feby<sup>r</sup> 1785, W<sup>m</sup> Benson D<sup>ca</sup>  
 By John Leach

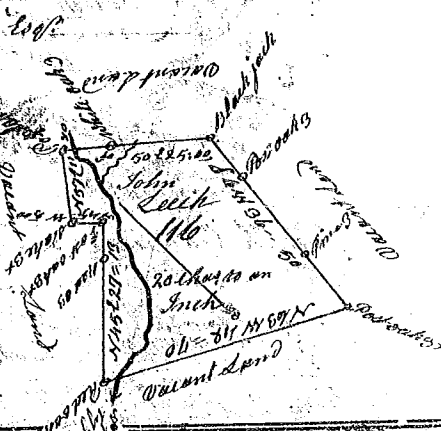

State of S<sup>c</sup> Carolina Pursuant to a warrant from  
 John Thomas Commissioner of Locations Dated the  
 5<sup>th</sup> day of Feby<sup>r</sup> 1785, I have admeasured and  
 laid out unto John Leach a tract of Land con-  
 taining Two hundred and forty six acres  
 situate in Ninety six District East of the an-  
 cient Boundary on Middle Tyger River  
 Bounding SW, SE, NE on Land unknown  
 NE on John Mc Carters SW to Jas. Halls and on  
 all other sides on Vacant Land, and hath such shape  
 and Marks as the above Plat Represents,  
 Survey'd the 1<sup>st</sup> Feby<sup>r</sup> 1785. W<sup>m</sup> Benson D<sup>ca</sup>  
 recorded the 19<sup>th</sup> Feby<sup>r</sup> 1785



State of South Carolina Pursuant to a warrant from John Thomas  
 Esq<sup>r</sup> Commissioner of Locations in Ninety six District N<sup>o</sup> Saluda River  
 I have admeasured and laid out unto James McIntoch a  
 tract of Land containing Sixty Acres on a small Branch of  
 Warring Creek below the Indian Downage, Bounding North  
 part on land laid out to W<sup>m</sup> Fowler & part on land unknown N<sup>W</sup> on land  
 laid out to Dan<sup>l</sup> Walker & S<sup>W</sup> on land laid out to James Galobay  
 and hath such shape and marks as the annexed plat Represents  
 Survey'd the 28<sup>th</sup> January 1783. By Robert Hanna D<sup>ca</sup>  
 Recorded the 19<sup>th</sup> February 1785. Delivered to Samuel McIntoch

