

State of S. Carolina 96 District East of the
 Ancient Boundary Pursuant to a war-
 rant from John Thomas, Comm. Locations
 dated the 17th March 1785. I have admeasured
 & laid out unto James Blenfield a tract
 of land containing two Hundred acres, situate
 between the forks of Broad & Saluda Rivers, on
 both sides of Ferguson's Creek, bounded to the
 S. E. by the line of All Other sides on vacant
 Land & hath such the shape and marks as the above
 Plat represents, Survey by the 17th March 1785
 Recorded the 9th April 1785
 Delivered to Wm Moore

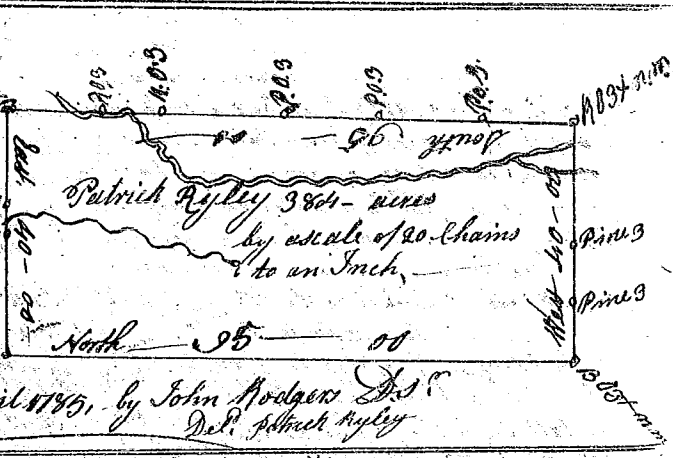

State of S. Carolina Pursuant to a war-
 rant from John Thomas, Commissioner
 of Locations for the district of ninety six
 North side of Saluda River dated 5th March
 1785. I have admeasured and laid out unto
 Patrick Ryley a tract of three Hundred and
 eighty four acres, of land situate above the
 Old Boundary Line, & district of ninety six
 district, on a branch of Needy River bounding
 E on Joseph Kelt and Patrick Ryley, the other
 sides on land not known, and hath such
 shape form and marks as the above
 Plat represents, Survey the 28th day of April 1785, by John Rodgers De.
 Recorded the 11th day of April 1785



State of South Carolina Pursuant to a warrant from
 John Thomas Commissioner of Locations dated the 18th day of
 February 1785. I have admeasured and laid out unto
 William Prater a tract of one hundred acres of land
 below the ancient boundary, situate in Ninety six district
 North side Saluda River bounding N.W. on Joseph Chapman
 N.E. on Joseph Chapman, all other sides on vacant land
 and hath such shape and marks as the above
 Plat represents, Survey 15 Feb'y 1785
 Recorded the 10th April 1785
 John Martin De.

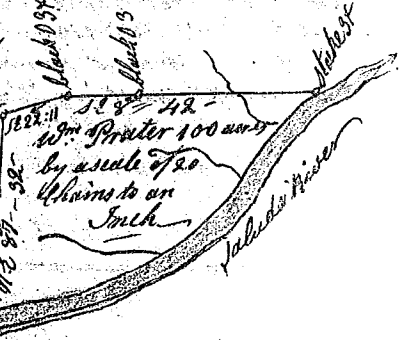

State of S. Carolina 96 district
 Pursuant to a warrant from
 John Thomas Commissioner
 of Locations for the district of
 the N. of Saluda River, I have
 Surveyed and laid out unto
 Patty Prince a tract of land
 containing 550 acres situate
 above the ancient boundary line
 above the west of the road, on the
 waters of the golden grove, East of the
 road on the waters of Needy River
 bounded N. w. by William Miller
 Land, S. w. by vac't land, westwardly by
 Benj. Rice land, Eastwardly by Taps. Hobbys
 land, and has such shape and marks as the
 above Plat represents, Survey 14th Decr 1784
 Recorded the 14 April 1785, James Sed. Corn De.

