

State of South Carolina

Pursuant to a warrant from John Thomas, Esq. Commissioner of locations dated 23^d April 1785, I have admeasured and laid out unto David McJey a tract of Land containing one Hundred and fifty eight acres in Ninety six District West of the ancient boundary on a branch of Hamiltons Creek & branches of ... Creek of Saluda River bounding S& on land laid out to Mary White N& to Jacob Garner, on all other sides on Vacant Land, and hath such shape and Marks as the above plat represents, Surveyed the 25^d April 1785 by Wm. Benson Esq.

Recorded the 29^d May 1785, -

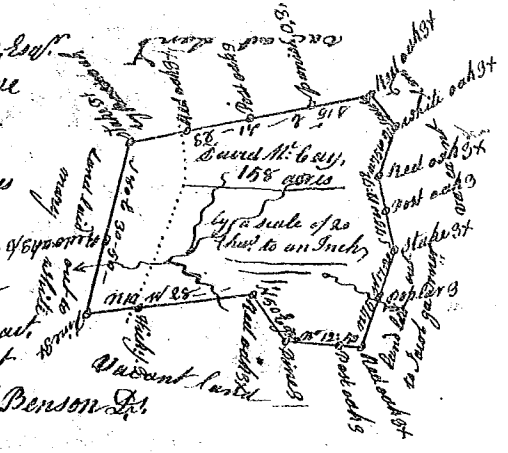

State of S. Carolina

Pursuant to a warrant from John Thomas, Commissioner of locations of Saluda, I have admeasured and laid out unto Robert Prince a tract of two hundred acres of land, as an Ensign in one of the Independent Companies of this State, in ninety six District, on the head branches of Enoree, and branches of Saluda River S.W. of Enoree Mountain, on all sides on Vacant Land, and hath such shape and Marks as the above plat represents. Surveyed 22^d April 1785

Recorded 24th May 1785, -

Robert Prince Esq.

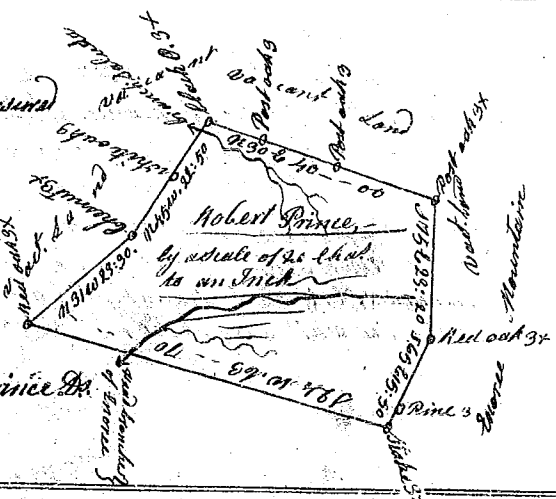

State of South Carolina, Pursuant to a warrant to John Thomas, Esq. Commissioner of locations dated 6th April 1785, I have admeasured and laid out unto Robert Goodgion a tract of one Hundred and forty nine acres of land, in ninety six District East of the ancient boundary on the branches of middle Tygar River, bounding on all sides on Vacant Land and hath such shape and Marks as the above Plat repres. Surveyed the 22^d April 1785,

Recorded 24th May 1785, -

Wm. Benson Esq.

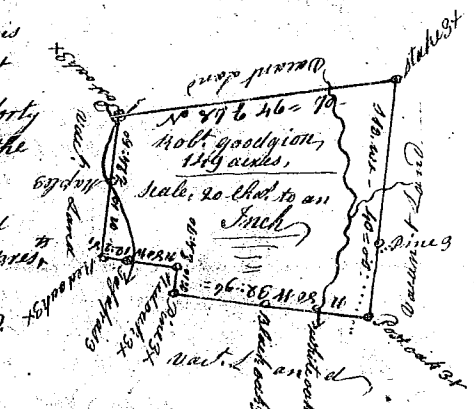

State of South Carolina

Pursuant to a warrant from John Thomas Esq. Commissioner of Locations, Dated the 10th day of May 1785. I have admeasured & laid out unto Benjamin Bridges a Tract of Two Hundred & Eighteen Acres of Land. Situate in Ninety six District N. side Saluda West of the old boundary, on the Branches of Longpointers Creek of Reedy River, and hath such shape marks & Boundaries as the annexed Plat Represents. Surveyed the 10th May 1785

Recorded the 24th May 1785

Joseph Whitmer Esq. Surveyor

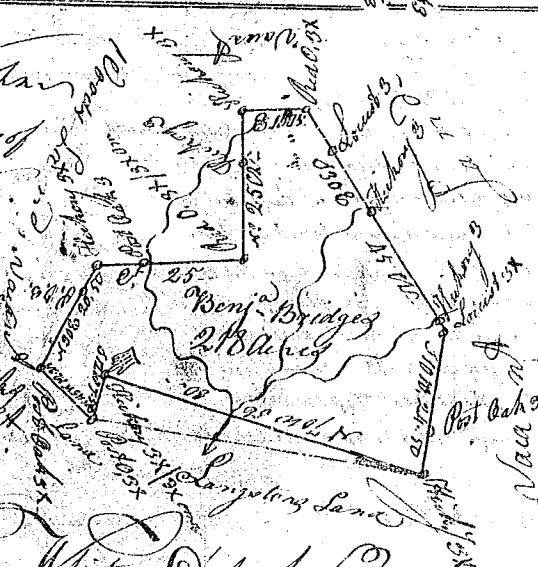

Land owned by a piece of 200 Chain to a Junip