

State of S^c Carolina Pursuant to a warrant from
 John Thomas Esq. Comm^r of Locations Dated the 22^d April 1785
 I have admeasured & laid out unto Hardy Roberts a Tract of
 five Hundred & fifty one acres
 of Land. Situate in 96th
 District North side Saluda River
 West of the Old Boundary
 Lying on both sides of Longtons
 Creek of Ready River & Mountain
 Creek of Enore River and Math Creek
 Shape marks Buttings & Boundings as the
 annex^d plat Represents Survey^d the 29th May 1785
 Recorded the 24th May 1785
 J^o Whitner Esq^r

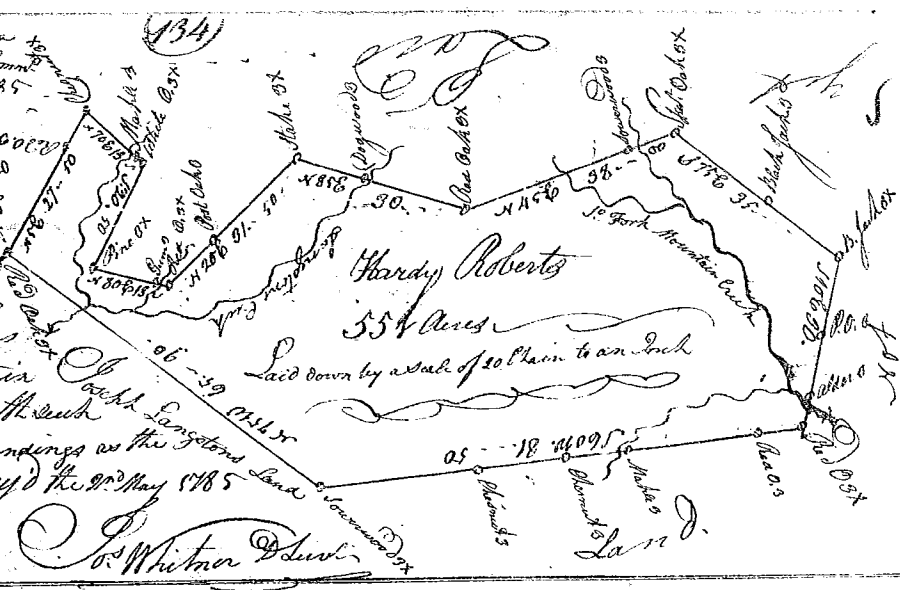

State of S^c Carolina Pursuant to a warrant from
 John Thomas Esq. Comm^r of Locations Dated the 20th April
 1785. I have admeasured & laid out unto Edwin Smith a
 Tract of 608 acres of Land. Situate in Ninety
 six District West of the Old Boundary Lying on
 the N^e side of Saluda River and Math Creek
 Shape marks Buttings & Boundings as the
 annex^d plat Represents
 Survey^d the 7th May 1785
 Recorded the 24th May 1785
 J^o Whitner Esq^r

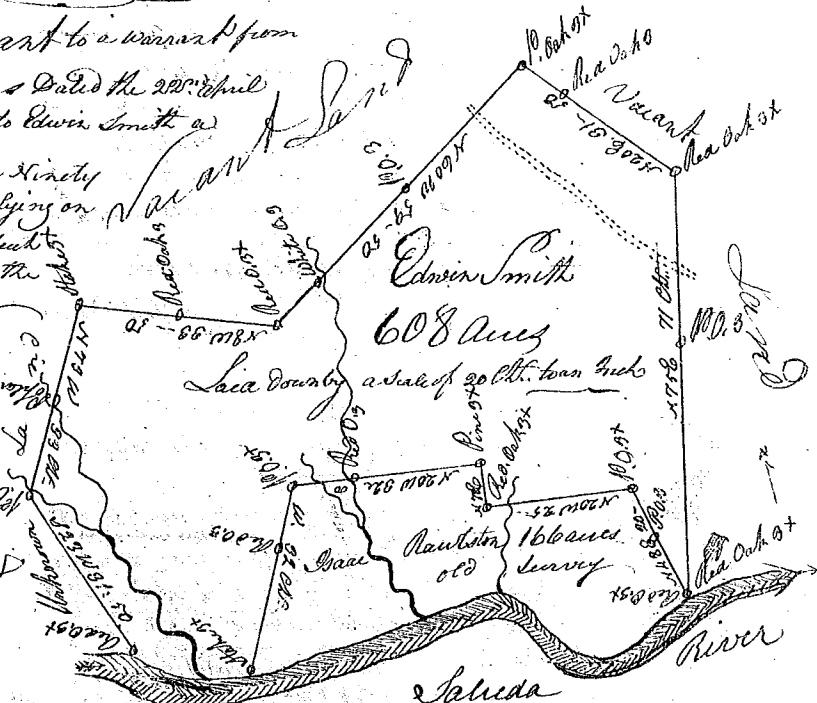

State of South Carolina Pursuant to a warrant from
 John Thomas Esq. Comm^r of Locations Dated the 14th
 Day of May 1785. I have admeasured & laid out unto
 Daniel Bush a Tract of one Thousand & Sixty Eight
 Acres of Land. Situate in Ninety six District West of
 the Old Boundary on Mill Creek of Saluda River and
 Math Creek Shape marks Buttings & Boundings as the
 annex^d plat Represents Survey^d the 4th of May 1785
 Recorded the 24th May 1785
 J^o Whitner Esq^r

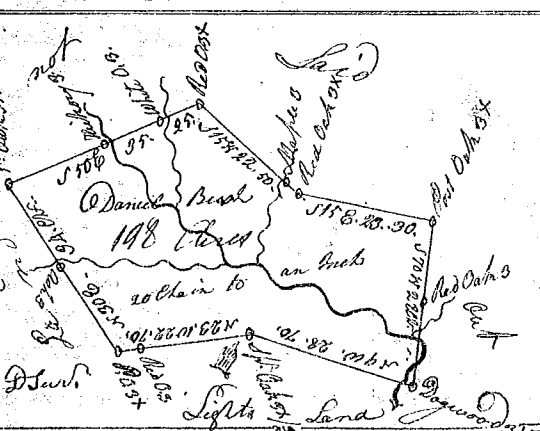

State of S^c Carolina Pursuant to a warrant from
 John Thomas Esq. Comm^r of Locations Dated the 14th day of
 May 1785. I have admeasured & laid out unto Joseph Maxwell
 a Tract of one Thousand acres of Land. Situate in Ninety six District
 South of Saluda River west of the Old Boundary. Bounding on all
 Sides on vacant Land & Math Creek. Shape marks as the annex^d
 Plat Represents. Survey^d the 16th of May 1785
 Recorded the 24th May 1785
 J^o Whitner Esq^r

