

Pursuant to a warrant from John Thomas Commissioner of Locations dated the 2^d May 1785, I have admeasured and laid out unto John Daniel Kern a tract of five hundred and thirty three acres of land, in ninety six district West of the ancient boundary on Needy River and branches of Hooper's Creek of Sabel's River, putting wild bounding, as the above plat represents.

Survey, 24. May 1785, H. Benson Es.
Recorded the 25. May 1785,

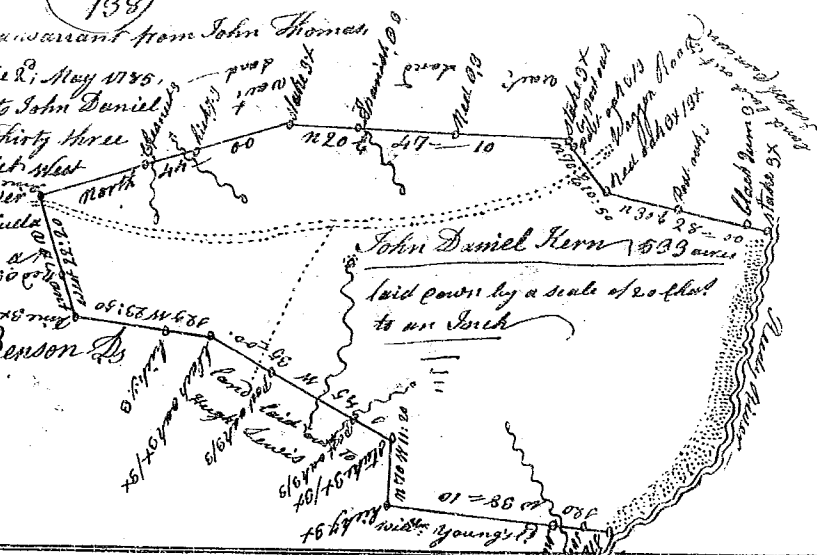

Pursuant to a warrant from John Thomas Commissioner of Locations dated the 23^d Feby. 1785, I have admeasured and laid out unto Jeronias Langston, a tract of land containing four hundred and eighty nine acres, N^o of Sabel's, on Sabel's branch, waters of Needy River West of the Indian boundary line, bounded Southly by James M^o Roy and Robert Puncamp lands N^o by by J^o M^o Roy's land, E. by Thomas Woods land, all other side by Nat. land, and hath such shape and marks as the above Plat represents.

Survey, 20. May 1785, by J^o Wofford Es.
Recorded 25. May 1785, J^o Joseph Langston

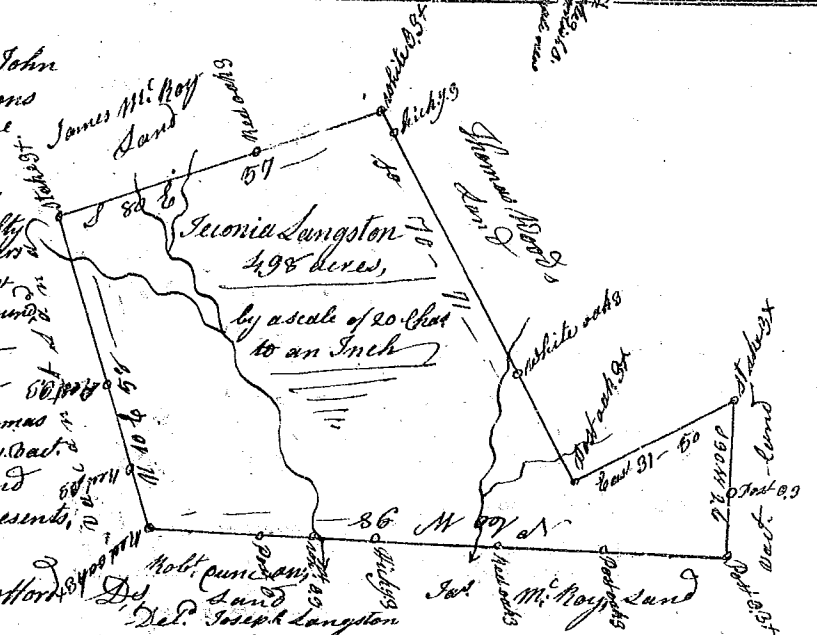

Pursuant to a warrant from John Thomas Commissioner of Location, I have admeasured and laid out unto John Griffin a tract of one hundred and fifty acres of land, situate in ninety six district on the waters of Broad's Creek and hath such shape and marks, buttings by boundaries as the above Plat represents.

Survey, the 26 April 1785
Recorded the 26. May 1785, Charles Sims Es.



Pursuant to a warrant from John Thomas Commissioner of Locations dated the 4th day of March 1785, I have admeasured and laid out unto James Braden a tract containing one hundred and fifty two acres, of land below the ancient boundary line, situate in Ninety six, on both sides of Needy River, bounded Northward on Phil. Braden's land, all other sides by said River and vacant land, and hath such form and marks as the above Plat represent.

Survey, 17th March 1785
Recorded 27. May 1785, by John Boudle Es.

