

State of S^c Carolina

Pursuant to a warrant from John Thomas Commissioner of locations North of Saluda I have admeasured and laid out unto Robert Prince a Tract Two hundred and thirty acres of land situate in ninety six District on a branch of Enoree River butting and bounding, and hath such other shape and Marks as the above plat Represents.

Survey, 2^d day of April 1785, by Rob^t Prince D^r,
Recorded the 21 day of June 1785

Del. m^r Hooper del

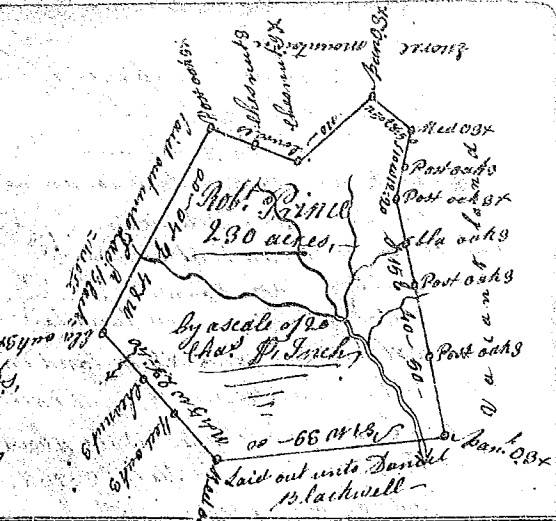

State of S^c Carolina

Pursuant to a warrant from John Thomas Commissioner of locations North of Saluda I have admeasured and laid out unto Lachariah Blackwell His at law to Daniel Blackwell Jun^r D^r, a tract of two hundred acres of land on the County, situate in ninety six District, on the head branches of Enoree River, butting and bounding, and hath such other shape and Marks as the above plat Represents, Survey, 2^d day April 1785,

Recorded 21 day June 1785, Robert Prince D^r,
Del. m^r Hooper del

Del. m^r Hooper del

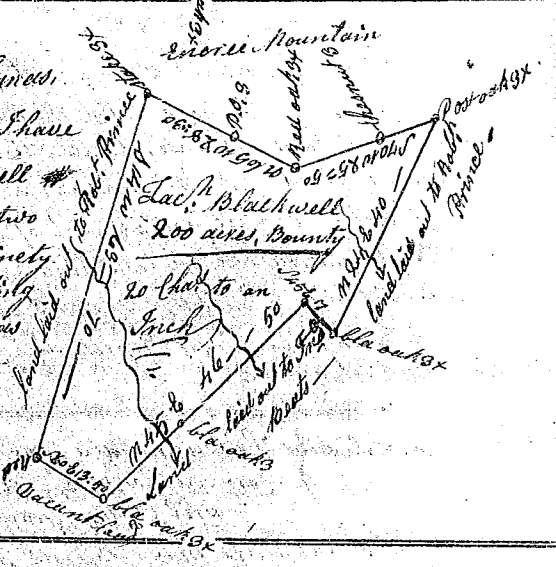

State of South Carolina Pursuant to a warrant from John Thomas Commissioner of locations North of Saluda River, I have admeasured and laid out unto William Powell a tract of two hundred acres of land on the County, situate in ninety six District on horse creek of main broad river, including John Spivey's old Improvement, hath such buttings and boundings and other shape and Marks as the above Plat Represents, Survey, 2^d June 1785,

Recorded the 21 June 1785, Rob^t Prince D^r,
Del. m^r Hooper del

Del. m^r Hooper del

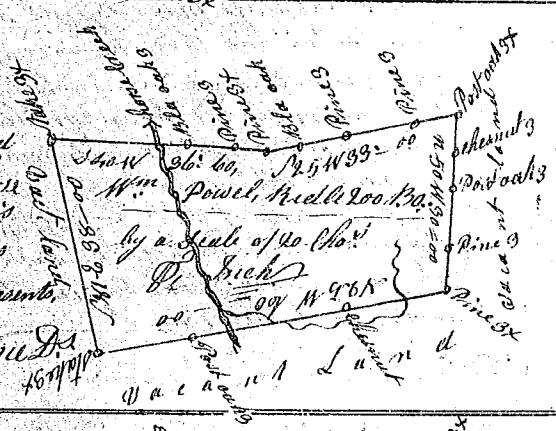

State of S^c Carolina Pursuant to a warrant from John Thomas Commissioner of locations North of Saluda River I have admeasured and laid out unto John Hunt a tract of land of two hundred acres, on the County situate in ninety six District, on horse creek of main broad river, and hath such buttings & bounding and Shape and Marks as the above Plat Represents, Survey, 2^d June 1785,

Recorded the 21 June 1785, by Robert Prince D^r,
Del. m^r Hooper del

Del. m^r Hooper del

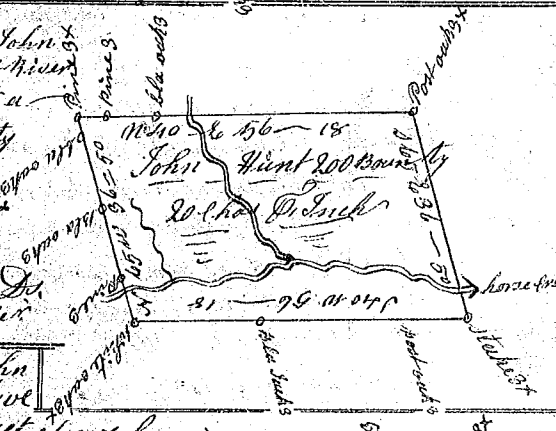

State of South Carolina Pursuant to a warrant from John Thomas Commissioner of locations North of Saluda I have admeasured and laid out unto John Blackwell a tract of one hundred and twenty four acres of land situate in ninety six District on such creek of main broad river, and has such buttings and boundings, and other shape and Marks as the above plat Represents, Survey, 3^d day June 1785,

Recorded 21 day June 1785, Rob^t Prince D^r,
Del. m^r Hooper del

Del. m^r Hooper del

