

State of South Carolina Pursuant Dated 17th of March 1785
 from John Thomas Commissioner of locations on the side
 Saluda, I have admeasured and laid out a tract of
 three hundred and twelve acres of land, unto John
 Thomson, situate in 96 district below the ancient
 boundary on a branch of Sandy Run, south side
 Pacolite River, bounding on all sides with vacant
 land, and hath shape and Marks as the above
 Plat Represents Survey, the 18th May 1785.

Recorded 4th July 1785, by J. Martin Esq,
 Del. Cap. Thomson

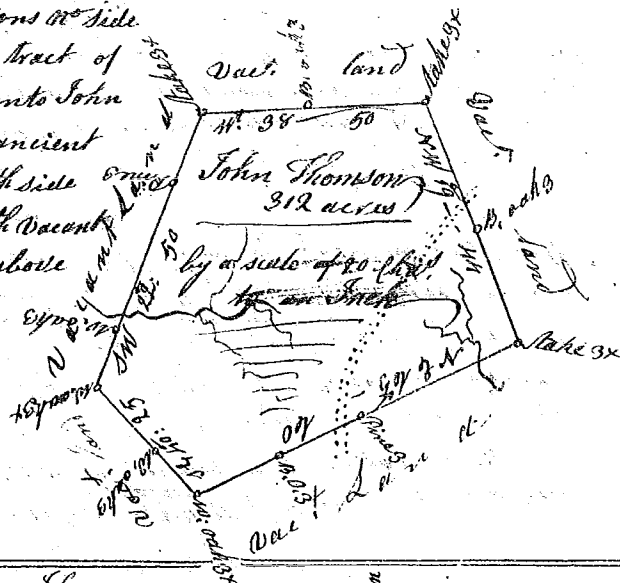

State of S. Carolina Pursuant to a warrant from John
 Thomas, Commissioner of locations dated 9th of June 1785,
 I have admeasured and laid out unto James Kennedy
 a tract of one hundred and thirty eight acres of land
 in 96 district below the ancient boundary south
 side of broad River, bounded NW on Laurence House
 SE on James Kennedy & Tho. Kennedy W on Robt.
 Montgomery, all other sides on vacant land,
 and hath such shape and Marks as the above Plat
 Represents, Survey, the 16th June 1785, J. Martin Esq,
 Recorded 8 July 1785.

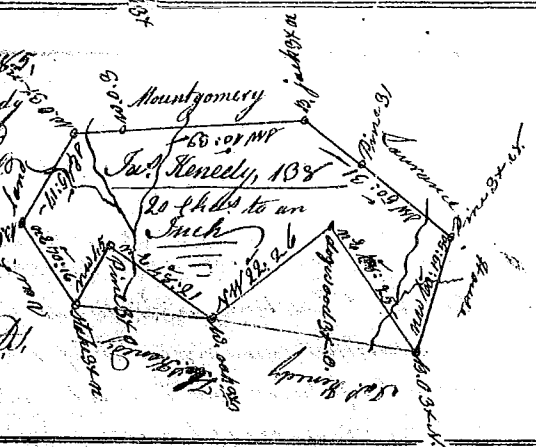

S. Carolina Pursuant to a warrant Dated 28th April 1785
 from John Thomas Commissioner of locations on the side
 Saluda I have admeasured and laid out unto Robert Mount-
 gomery a tract of two hundred and thirteen acres
 of Sublet, below the ancient boundary, on the head
 down Creek of Chickety, ~~East~~ bounding SW on
 Hagan's land N.E. on Cools & south on Safford's the other
 sides on vacant land, and hath such shape and Marks
 as the above Plat Represents, Survey, the 20th May 1785.

Recorded 8th July 1785, by J. Martin Esq,
 Del. Cap. Thomson

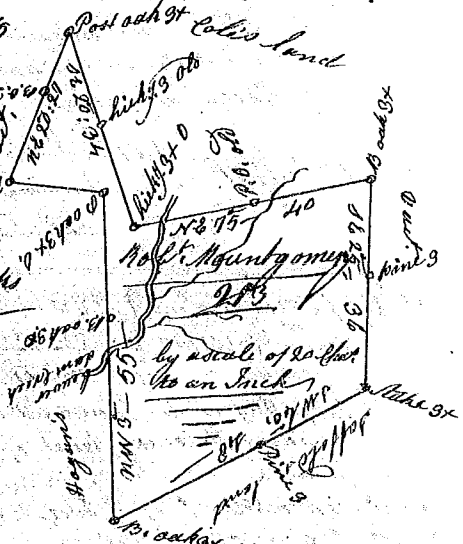

State of S. Carolina Pursuant to a warrant from
 John Thomas Commissioner of locations, dated 20th day
 of June, I have admeasured and laid out unto John
 Martin a tract one hundred and thirty six acres of land
 below the ancient boundary, situate in 96 district, in the
 forks of Needy and Meborb's Creek N. of Saluda river
 bounding NW on widow Roman's land NE on granted land
 all other sides on vacant land, and hath such shape and
 Marks as the above plat Represents, Survey, the 23rd June 1785.

Recorded the 8th July 1785, by J. Martin Esq,
 Del. Cap. Thomson

