

State of South Carolina  
 Pursuant to a Warrant from John Thomas Esq. Commissioner of Locations Dated the 17<sup>th</sup> day of May 1785. I have admeasured and laid out unto John Thomas a tract of land containing 400 Acres situate in the District West of the Ancient Boundary, on the Long Branch of Reddy River, Putting & Bounding as to the Luck Shape & marks as the annexed Plat Represents. Surveyed this 11<sup>th</sup> July 1785  
 Recorded 1<sup>st</sup> August 1785  
 Wm. Benson

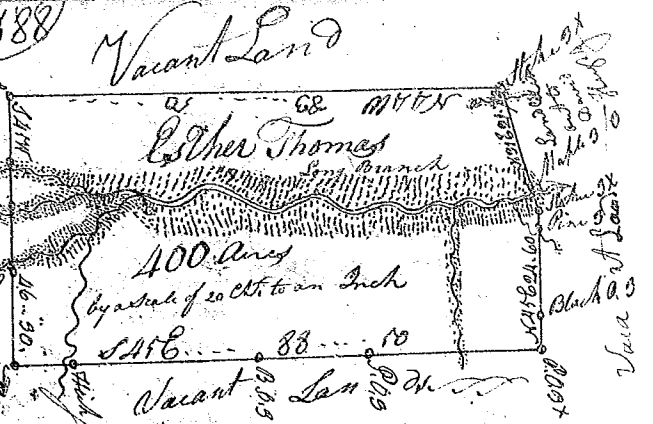

State of South Carolina  
 Pursuant to a Warrant from John Thomas Esq. Commissioner of Locations Dated the 13<sup>th</sup> day of May 1785 I have admeasured & laid out unto Eleanor Goodwin a tract of land containing Two Hundred & Twenty four Acres, situate in the District East of the Old boundary On the Branches of Middle Tigar River & the upper part of Branch of Camer's Creek of North Tigar River & hath such Shape & marks as Cuttings & Boundings as the above Plat Represents. Surveyed this 29<sup>th</sup> June 1785  
 Recorded the 5<sup>th</sup> Aug. 1785  
 Wm. Benson

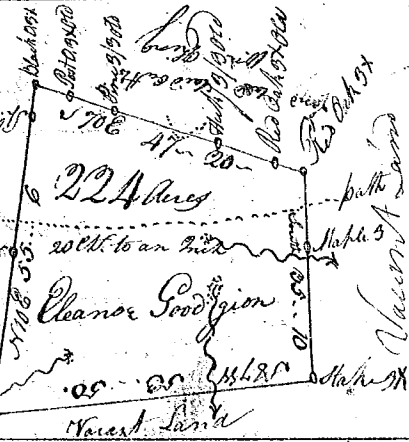

State of South Carolina  
 Pursuant to a Warrant from John Thomas Esq. Com. of Locations in the District N. of Saluda I have admeasured & laid out unto Samuel Crafford a tract of Two Hundred & Seventy and one Acres, on the Hurricane Branch of the Olden Grove, Bounding N.W. & N.E. on Sam. L. Porter & Joseph Reed's Lands & E. & S.W. on John Wilson & Mine's Land all other sides on Vacant Land & hath such Shape & marks as the annexed Plat Represents. Surveyed this 17<sup>th</sup> June 1785  
 Recorded this 1<sup>st</sup> August 1785  
 Rob. Hanna



State of S. Carolina Pursuant to a Warrant from John Thomas Esq. Com. of Locations Date the 24<sup>th</sup> May 1785. I have admeasured & laid out unto Sham Lafford a tract of 640 Acres of Land on Thickly & the water there of being N. of Saluda below the Indian Boundary & E. by M. Bice's land NW by M. Bice's land & by Tom's name before land all other parts on Vac. Land & hath such Shape and mark both Natural & artificial as the above Plat Represents & Surveyed this 25<sup>th</sup> May 1785  
 Recorded the 1<sup>st</sup> day of August 1785  
 John Bullcock

