

State of South Carolina Ninety six District on the East side of the ancient Boundary, Pursuant to a Warrant from John Thomas Esq. Comr. of Locations Dated the 11th June 1785. I have measured & laid out unto Thomas Greer a tract of three hundred & thirteen acres of Land, situated lying & being on the N. side of Tyger River, Bounded W. by the P. Thomas Greer & E. by Tyger River Et. S. by William Young's land and North South & East West marks as the annexed plat Represents Surveyed this 11th June 1785 Andrew Thomson Deputy Surveyor Recorded this 3rd day of August 1785



State of South Carolina 36 District East of the ancient Boundary Pursuant to a warrant from John Thomas Esq. Comr. of Locations dated the 22nd June 1785. I have measured & laid out unto John Prince a tract of land containing three hundred acres lying on the S. side of Tyger River, on the Branches of Sparks Creek Bounded NW by William Shelton S. by Thomas Putman E. by William Gist & Easterly by John Howard & S. by Lewis Prince & hath such shape & marks as the annexed plat Represents Surveyed this 22nd June 1785 Andrew Thomson Deputy Surveyor Recorded this 9th day of August 1785



State of South Carolina Ninety six District East of the Old Boundary Pursuant to a warrant from John Thomas Esq. Commissioner of Locations dated the 22nd June 1785. I have measured and laid out unto John Prince a tract of land containing one hundred & twenty one acres lying on the N. side of Tyger River and on the small Branches of Sparks Creek Bounded N. by Robert Jackson & Acres Kirshland lands S. by Robert Prince's land E. by Edward Prince's land all other sides vacant & hath such shape & marks as the annexed plat Represents Surveyed this 22nd day of June 1785 by Andrew Thomson Deputy Surveyor Recorded this 9th August 1785

State of South Carolina 96 District East of the Old Boundary line, Pursuant to a warrant from John Thomas Esq. Comr. of Locations Dated the 22nd June 1785. I have measured & laid out unto John Prince a tract of land containing 640 acres, on both sides of Holcomms creek of Tyger River, Bounded S. by Jacob Dueset Henry Clark & John Campbell's lands W. by land laid out for John Howard N. by Berry's land & West by Underwood land & E. by Robert Prince's land East by Vacant land & hath such shape & marks as the above plat Represents Surveyed this 24th June 1785 Andrew Thomson Deputy Surveyor

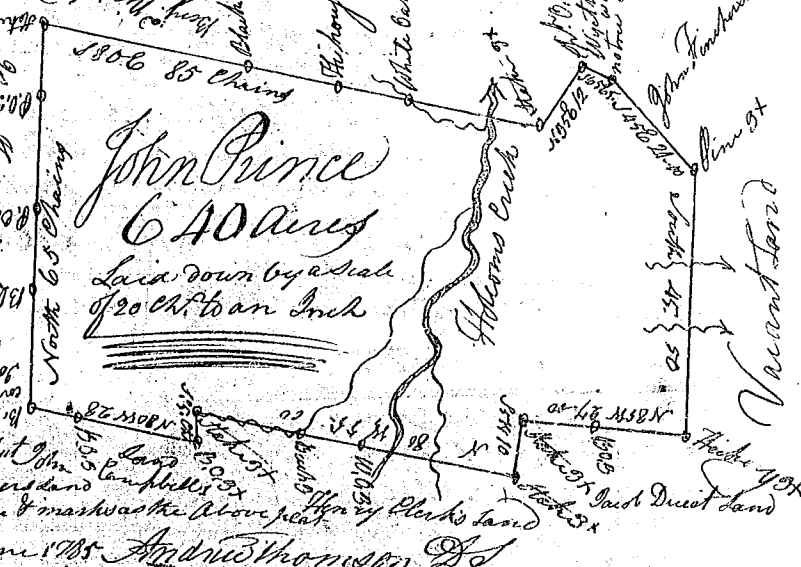

Recorded the 4th day of August 1785