

State of South Carolina of District East of the
 Ancient Boundary Line. Pursuant to a Warrant
 from John Thomas Esq: Com: Dated this
 21st July 1785. I have admeasured &
 laid out unto Joseph Cones a tract
 of Land containing Three Hundred
 & Forty six acres, Situate lying by
 being on a Creek call'd Bufflow Creek
 Bounded to the N: by Evan Thomas
 Land and Vacant Land all other sides
 Unknown. I hath laid shape & marks as the above Plat Represents
 Survey'd this 20th August 1785
 Recorded this 6th Sept: 1785.

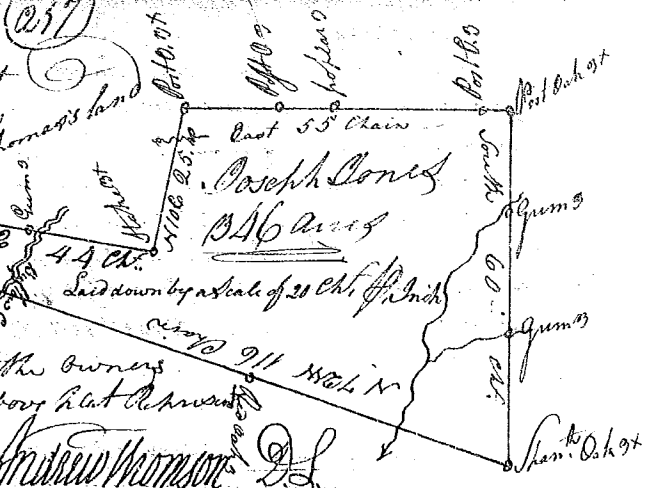

State of South Carolina Pursuant to a
 Warrant from John Thomas Esq: Commissioner
 of locations Dated the 25th day of July 1785,
 I have admeasured and laid out unto
 John Hampton Harrison a tract of four hundred
 - dead and nine acres, of land, situate in
 Ninety six district, on the branches of
 fairforest creek of Sugar river, and
 hath such shape, Marks, buttings and
 boundings as the above Plat Represents,
 Certified the 16th Aug: 1785,
 by George Salmon D: S.
 Recorded the 17th Sept: 1785.

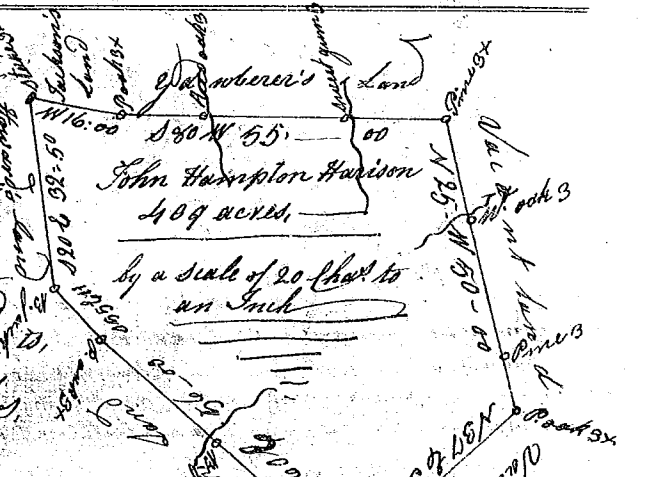

State of South Carolina
 Pursuant to a warrant from John
 Thomas Esq: Commissioner of locations
 dated 25th July 1785, I have admeasured and laid
 out unto John Hampton Harrison a tract of one Hundred Sixty
 acres of land, situate in Ninety six district, on a branch of
 fairforest creek waters of Sugar River and hath such shape
 Marks, buttings and boundings as the above Plat Represents
 Certified 16th Aug: 1785,
 by George Salmon D: S.
 Recorded 17th Sept: 1785.

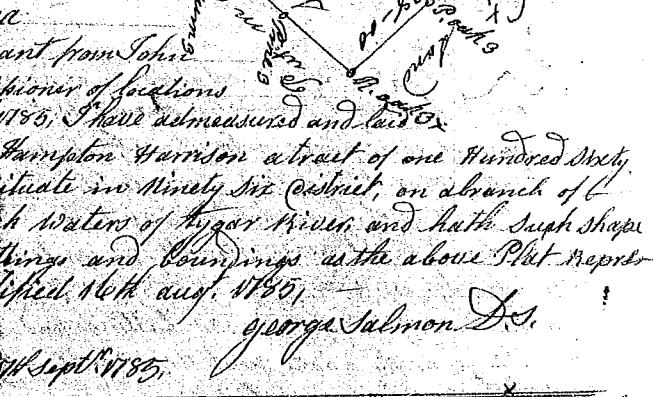

State of South Carolina
 Pursuant to a
 warrant from John
 Thomas Esq: Com: D:
 of locations dated the 27th Nov: 1785, I have ad-
 measured and laid out unto John Portman Esq:
 a
 Tract of one hundred and thirty eight acres of land, situate in Ninety six District
 on both sides of the middle fork of Saluda River, and hath such shape, Marks,
 buttings and boundings as the above plat Represents, survey: 26 July 1785
 Recorded 7th Sept: 1785,
 by George Salmon D: S.



State of S: Carolina Pursuant to a warrant from John Thomas Esq:
 Com: D: of locations in 96th district N: Saluda river, I have admeasured
 and laid out unto Solomon Nichols a tract of fifty acres of land on
 gilders creek, a branch of Indian creek in Newberry County, bounding
 on Anthony Park's land, W part on John Holston's land & Part on
 James Sherick's land N: E on land laid out to Daniel Golick, and hath
 such shape and Marks as the above Plat Represents
 Survey'd 20th July 1785,
 Recorded 16th day Sept: 1785, D: S. Hugh Boyd

