

State of South Carolina

Pursuant to a warrant from John Thomas Esq. Commissioner of locations dated the 20 day of April 1785, I have admeasured and laid out unto John Pyle Junr. a tract of land containing six hundred and forty acres, situate in Ninety six district on a branch of the Needy fork of Needy River called Pyles branch above the ancient boundary line, bounded S.E. on home lands land, all other sides on vacant land, and hath such shape and Marks as the above Plat represents,

Surveyd the 1<sup>st</sup> day of May 1785.

by South<sup>th</sup> Downs De.  
Recorded 9 Sept<sup>r</sup> 1785.

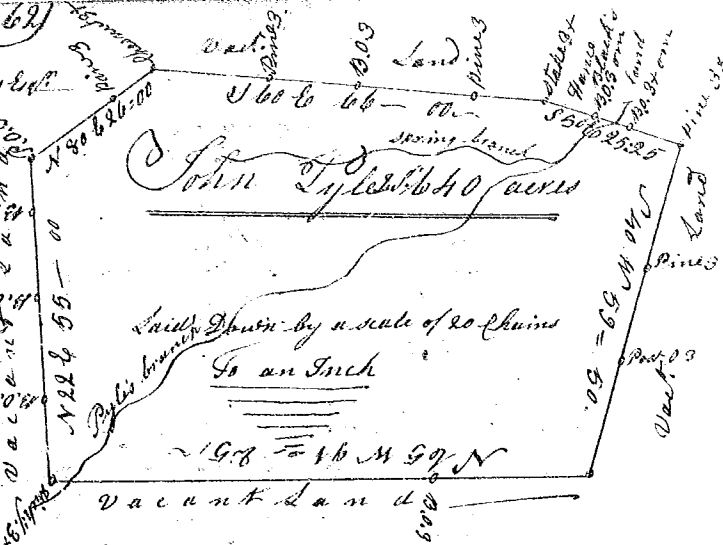

State of South Carolina Pursuant to a warrant from John Thomas Esq. Commissioner of locations dated 20<sup>th</sup> April 1785, I have admeasured and laid out unto John Pyle Junr. a tract of land containing three hundred acres situate in 96<sup>th</sup> District on a branch of Needy River call<sup>d</sup> the spring branch above the ancient boundary line, bounded on all sides as above mentioned, and hath such shape and Marks as the above Plat represents,

Surveyd the 26<sup>th</sup> June 1785.

Recorded 9 Sept<sup>r</sup> 1785.  
by South<sup>th</sup> Downs De.

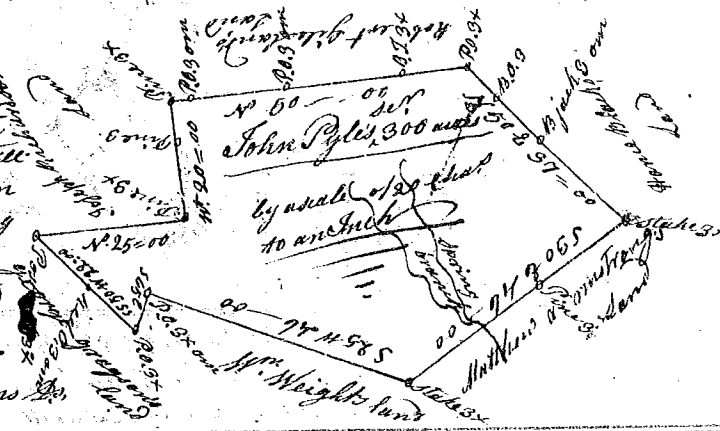

State of South Carolina

Pursuant to a warrant from John Thomas Esq. Commissioner of locations dated the 29<sup>th</sup> June 1785, I have admeasured and laid out unto James Floyd a tract of land containing four hundred and seventy five acres, situate in Ninety six district above the ancient boundary line, upon the Millstone and Cabin branch, waters of Needy River bounded on all sides as above mentioned, and hath such shape and Marks as the above Plat represents, Surveyd this day July 1785.

Recorded 10<sup>th</sup> Sept<sup>r</sup> 1785.  
by South<sup>th</sup> Downs De.

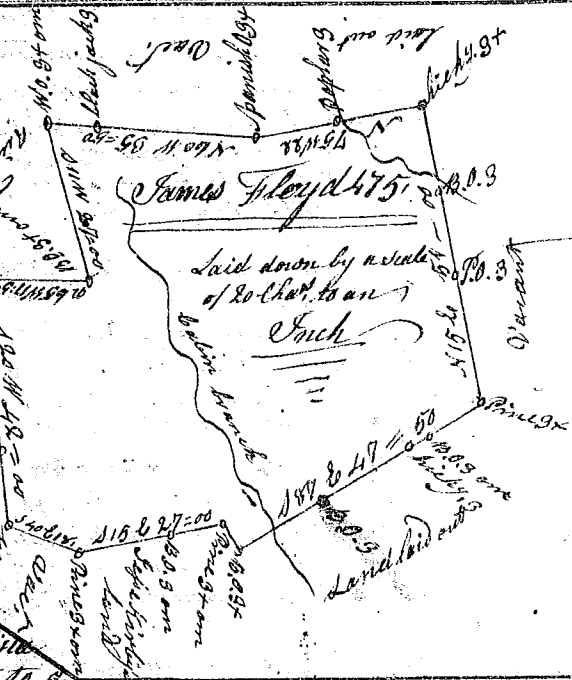

State of South Carolina

Pursuant to a warrant from John Thomas Esq. Commissioner of locations dated the 23 day of April 1785, I have admeasured and laid out unto James Black a tract containing two hundred and twenty acres of land, situate in the District of 96 above the ancient boundary line, on the Pigeon-Hoast branch, waters of Needy River, bounded N.W. on Matthew Armstrong's land, all other sides on vacant land, and hath such shape and Marks as the above Plat represents, Surveyd the 1<sup>st</sup> June 1785.

Recorded the 10<sup>th</sup> Sept<sup>r</sup> 1785.

by South<sup>th</sup> Downs De.