

State of S^c Carolina Pursuant to a warrant from John Thomas Esq^r Commissioner of locations dated the 27th June 1785, I have admeasured and laid out unto Mercedes Hodgdon a tract of one hundred and thirty five acres of land situate in 6th District N^o side of Saluda River, above the old boundary, on the east branches of S^c River, all sides on Vacant Land, and hath such and Marks as the above Plat represents,

Surveyed the 6th day of August 1785,

Recorded the 15th Sept^r, — by J. Whitmer D^s,

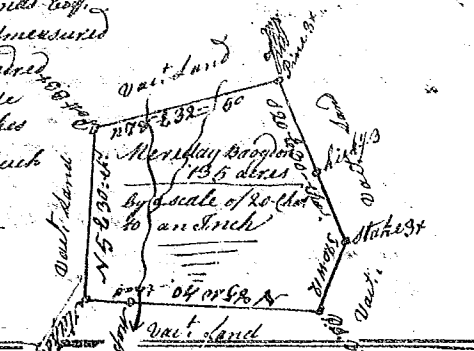

State of S^c Carolina Pursuant to a warrant from John Thomas Esq^r Commissioner of locations dated the 9th May 1785, I have admeasured and laid out unto John Lufferty a tract containing three hundred acres of land, situate in 6th District above the ancient boundary line on a branch of Reedy River called the Reedy Branch, bounded on all sides as above mentioned, and hath such shape and Marks the above Plat represents,

Surveyed the 31 day of May 1785

Recorded the 16th Sept^r 1785,

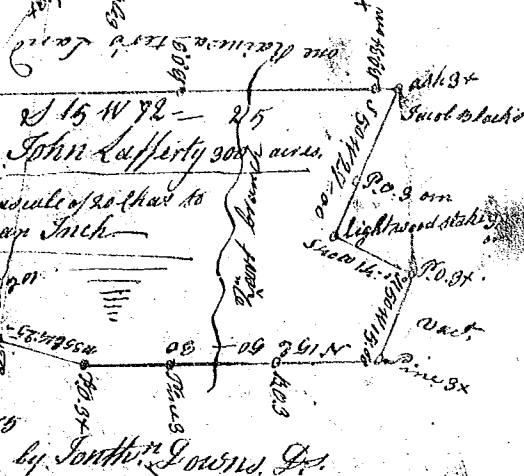

by Jonathan Gowen D^s,

State of S^c Carolina Pursuant to a warrant from John Thomas Commissioner of locations, I have admeasured and laid out unto George Little a tract of land of Ninety Two acres, situate in Ninety six District on S^c side of Tigar River, and hath such shape, Marks, buttings and boundings as the above Plat represents, Surveyed 9th June 1785,

Recorded 16th Sept^r 1785,

Bar^r Glenn D^s,

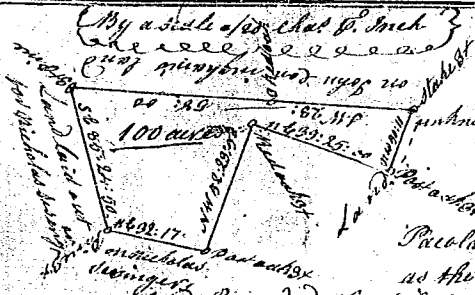
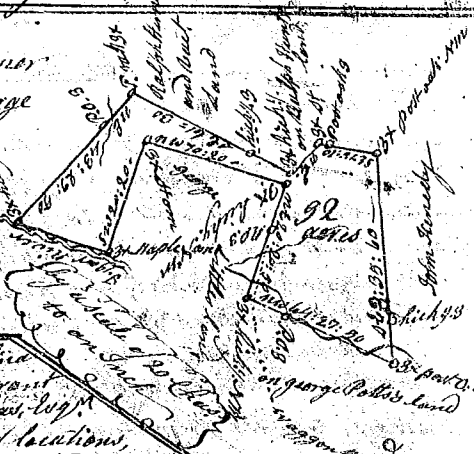

State of South Carolina Pursuant to a warrant from John Thomas Esq^r Commissioner of locations, I have admeasured and laid out unto John Philpitt a tract of 100 acres of land, situate in Ninety six District on a small branch of the south side of Pacolati, and hath such shape, form, Marks, buttings & boundings as the above Plat represents, Surveyed 30th Aug^t 1785,

Recorded the 16th Sept^r 1785,

Det. John Philpitt,

Charles Sims D^s,

State of S^c Carolina Pursuant to a warrant from John Thomas Esq^r Commissioner of locations dated North of Saluda River, I have admeasured and laid out unto Reubin Warren a tract of two hundred and seventy seven acres of land situate in Ninety six District on home Creek of Broad^r and hath such shape, buttings and boundings, other shape and Marks as the above Plat represents,

Surveyed the 24th June 1785,

Recorded the 16th Sept^r 1785, Rich^d Spindle D^s,

