

State of South Carolina Pursuant to a warrant from John Thomas Esq. Commissioner of Locations, I have admeasured and laid out unto Thomas Lamb a tract of 1000 acres of land, situate in Ninety six District, below the ancient Limits on N.E. side of Enoree river and hath such shape, Marks, buttings and boundings, as the above Plat represents, Survey, 7 Sept. 1785

Recorded 15th Oct. 1785, Abel Pearson, D.P. Archelus Family

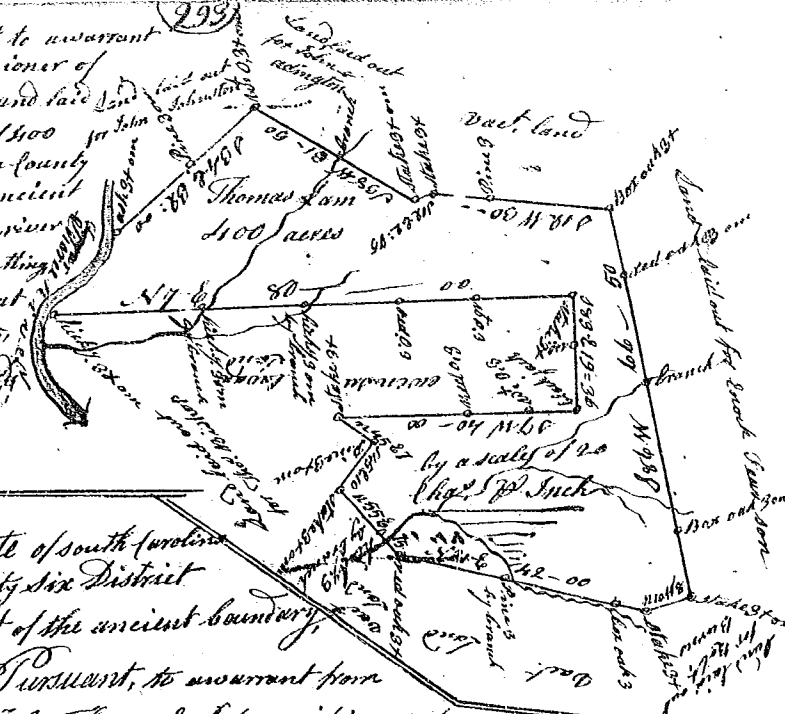

State of South Carolina Ninety six District East of the ancient boundary,

Pursuant, to a warrant from John Thomas Esq. Commissioner of Locations, Dated the 10th day of Sept. 1785, I have admeasured and laid out unto Charles Waters a tract of land containing four hundred and fifty acres, situate in Spartanburg County, on the north side of Enoree River, and hath such shape, Marks, buttings and boundings as the above Plat represents, Survey, the 27th Sept. 1785, by Andrew Thomson Esq.

Recorded 18 Oct. 1785

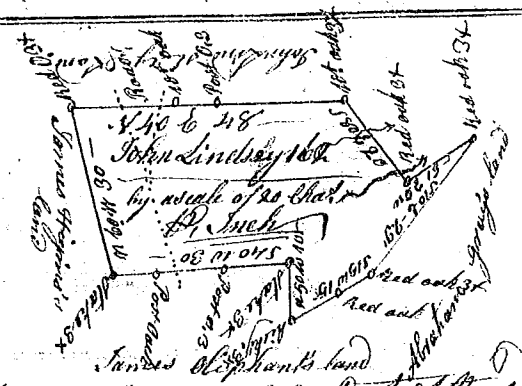
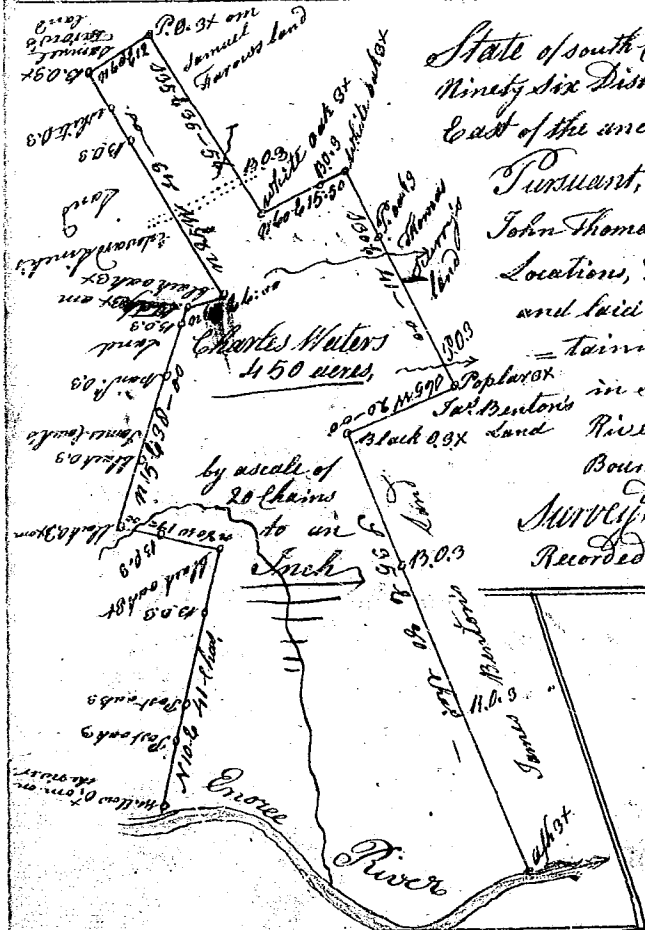

State of South Carolina Ninety six District the north of Lake & part of the old Line Pursuant to a warrant from under the Hand & Seal of John Thomas Esq. Comr of Locations Dated the 20th of Oct. 1785 I have admeasured & laid out unto John Lindsey a tract of land containing one hundred & sixty two acres situate on a small Branch the waters of Enoree River bounded northwardly by John Lindsey lands westwardly by James Hizens land south eastwardly by Abraham Gays land & James Alehant's land & hath such shape form & marks as the above Plat represents Survey, the 21st Oct. 1785 James Wofford, D.P. Recorded 21st Oct. 1785 John Lindsey

State of South Carolina Pursuant to a warrant from John Thomas Esq. Comr of Locations Dated the 19th of Oct. 1785 I have admeasured & laid out unto Benis Duff a tract of one hundred & four acres situate in Ninety six District above the old boundary on the north side of Lake & the river under the tableman's line all sides on vacant land & hath such shape & marks as the above Plat represents Survey, the 20th of Oct. 1785 William Wofford, D.P. Recorded the 24th Oct. 1785

