

(310)
 State of S^c Carolina Pursuant to a warrant from John Thomas Esq^r Commissioner of Locations dated the 14th of Nov^r 1785 I have admeasured & laid out unto John Taylor a tract of 200 Acres of Land on the Bounty (as a sea lot) situate in 9th District on the Branch of Lady River of Brushy Creek of Lady River & North such shape marks & boundaries as the above Plat represents Surveyed the 2^d of Nov^r 1785 & Whether D^r Recorded the 5th of Dec^r 1785

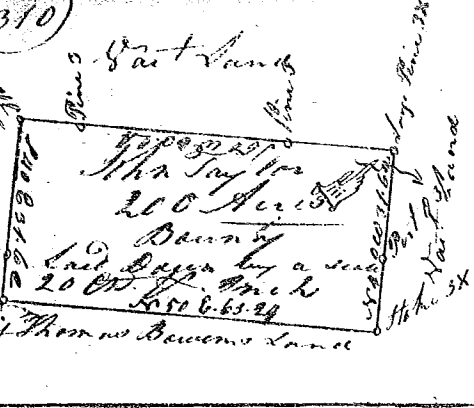

State of South Carolina Pursuant to a warrant from John Thomas Esq^r Commissioner of Locations dated the 25th of Nov^r 1785 I have admeasured & laid out unto Thomas Bowen a tract of 200 Acres of Land on the Bounty (as a sea lot) situate in 9th District on the west Branch of Lady River & North such shape marks & boundaries as the above Plat represents Surveyed the 25th of Nov^r 1785 & Whether D^r Recorded the 5th of Dec^r 1785

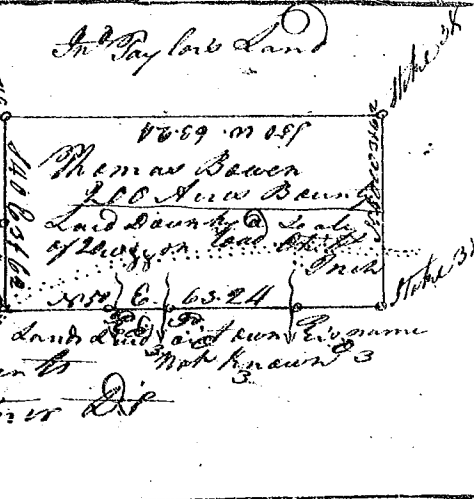

State of S^c Carolina Pursuant to a warrant from John Thomas Esq^r Commissioner of Locations 18th of Saluda River, I have admeasured and laid out John Adair of one hundred and three acres of land Laurans County & hath such shape and boundaries as the above Plat represents, Surveyed 18th Nov^r 1785 Recorded 2^d Nov^r 1785 Rob^t Hanna D^r Del. John Adair



State of S^c Carolina Pursuant to a warrant from John Thomas Esq^r Commissioner of Locations dated the 1st of Oct^r 1785, I have admeasured and laid out unto Bartlet Brooks a tract of Two hundred and Eight acres of land, below the old Indian boundary on the North of Saluda river on the waters thereof bounding S^e on Benja^l Cobb, Snd and Srd on Rob^t Gillum N^e on Thomas Eastland S^W on of Berry Harris, and hath such shape form and marks as the above Plat represents, Surveyed 1st Oct^r 1785 Recorded 1st Dec^r 1785

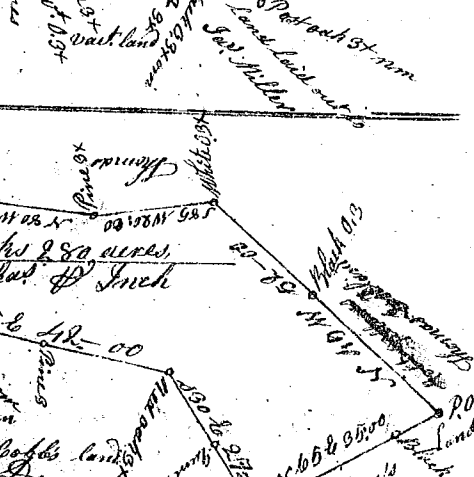

State of South Carolina Pursuant to a warrant from John Thomas Esq^r Commissioner of Locations dated 26th Aug^t 1785 I have admeasured and laid out unto Isaac Green a tract of Two hundred and Seventy Eight acres of land, situate in 9th District on the south side of mountain Creek of Enoree River, and hath such shape, marks, boundaries and boundaries as the above Plat represents Surveyed 27th Aug^t 1785 John R. G. Patrick D^r Recorded 1st Dec^r 1785

