

State of South Carolina, (313)  
 Pursuant to a warrant from John Thomas Esq.  
 Commissioner of locations Dated 30 Aug<sup>r</sup> 1785, I have  
 admeasured and laid out unto William Cornelious  
 a tract of two hundred acres of land, situate in  
 ninety six District, on Gap Creek of the North  
 forke of Saluda River, and hath such shape, Marks,  
 buttings and boundings as the above Plat represents.  
 Survey, 29<sup>th</sup> Sept<sup>r</sup> 1785, by John Youngh<sup>r</sup> Esq. D.  
 Recorded 15<sup>th</sup> Dec<sup>r</sup> 1785.

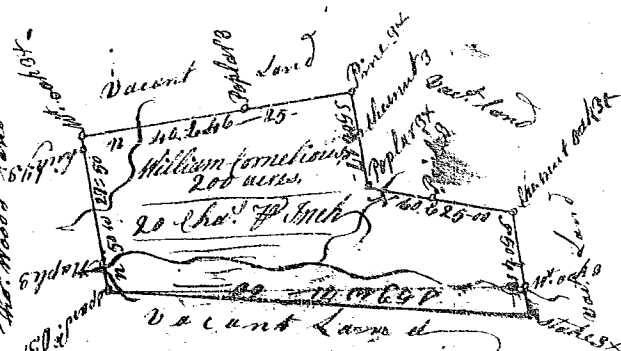

State of S<sup>c</sup> Carolina Pursuant to a warrant from John  
 Thomas Esq. Commissioner of locations dated 22<sup>nd</sup> Oct<sup>r</sup> 1785  
 I have admeasured and laid out unto Joseph Maxwell a  
 tract of one hundred and three acres of land, situate in 96  
 District on both sides of Thomsons beaverdam of the middle  
 forke of Tugger river, all sides on Vacant land, and hath  
 such shape and Marks as the above Plat represents.  
 Survey, 24 Oct<sup>r</sup> 1785 Joseph Schiefer Esq. D.  
 Recorded 15<sup>th</sup> Dec<sup>r</sup> 1785.

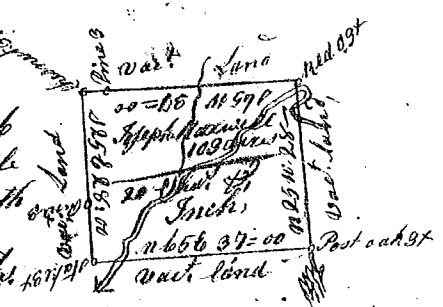

State of South Carolina Ninety six District N<sup>o</sup> Saluda East  
 of the old Boundary line

Pursuant to a warrant from John Thomas Esq.  
 Commissioner of locations dated the 9<sup>th</sup> Day  
 of Dec<sup>r</sup> 1785 I have admeasured &  
 laid out unto George Bratton a  
 tract of land containing  
 three hundred & thirty one  
 Acres situate on the South  
 side of the South forke of  
 Tugger River & began  
 Northwardly by said River  
 Westwardly by George Bratton's  
 & John McCalby's Land Eastwardly by John Thomas's Land all other sides by  
 Vacant Land & hath such shape form & Marks as the above Plat  
 Represents Survey, the 13<sup>th</sup> Day of Dec<sup>r</sup> 1785 by James Coffey Esq. D.  
 Recorded 15<sup>th</sup> Dec<sup>r</sup> 1785 Del. J. Bratton

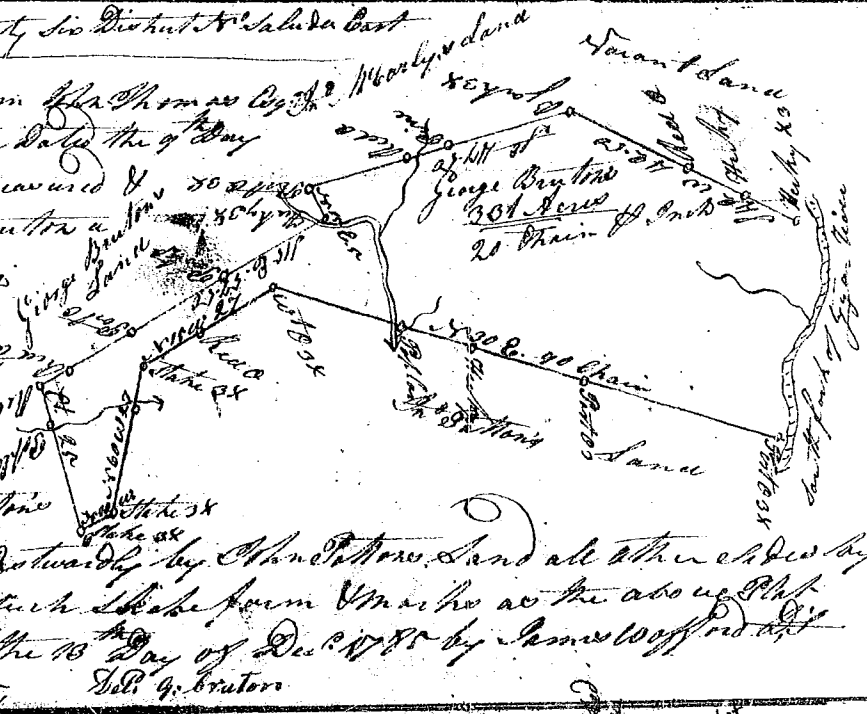

State of South Carolina,  
 Pursuant to a warrant from John Thomas Esq.  
 Commissioner of locations dated the 10<sup>th</sup> Nov<sup>r</sup> 1785, I have  
 admeasured and laid out unto Isaac Minson a tract of  
 one hundred and twenty seven acres of land, situate in  
 ninety six District, on the East branches of South Tugger river, and  
 hath such shape, Marks, buttings & boundings as the above  
 Plat represents, Survey, the 14<sup>th</sup> Nov<sup>r</sup> 1785, Joseph Whitner Esq. D.  
 Recorded 16<sup>th</sup> Dec<sup>r</sup> 1785, Del. Doct<sup>r</sup> Nelson

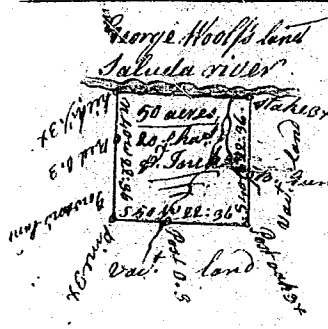
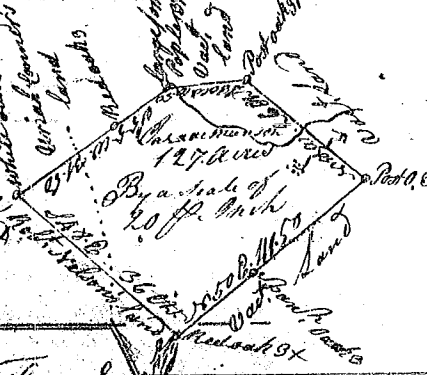

State of South Carolina,  
 Pursuant to a warrant from John Thomas Esq.  
 Commissioner of locations Dated 13<sup>th</sup> Sept<sup>r</sup> 1785, I have admeasured  
 and laid out unto John Burns a tract of fifty acres of land, situate in  
 ninety six District on Saluda river, and hath such shape and  
 Marks, buttings and boundings as the above plat represents,  
 Survey, 26<sup>th</sup> Sept<sup>r</sup> 1785, by John Young Esq. D.  
 Recorded 16<sup>th</sup> Dec<sup>r</sup> 1785,