

East 880 Chains

North 84

Wade Hampton Esq. 131166 acres

Laid Down by a scale of 120 Cha. to an Inch

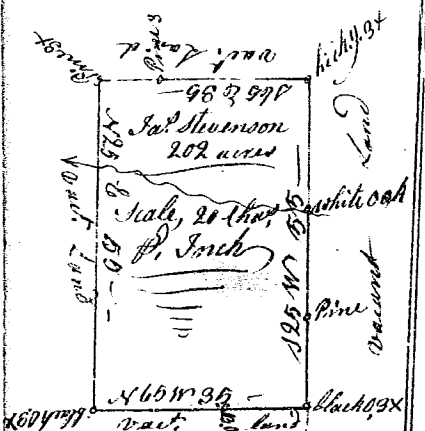

State of S^c Carolina,

Pursuant to a warrant from John Thomas Esq. Commr. of locations dated 7th Dec. 1785, I have measured and laid out unto James Stevenson a tract of land containing two hundred & two acres of situate in 96th District east of the Indian boundary line on the N^o 10th of Cherokee Creek a branch of Pacolet river bounded on all sides by vacant land, and hath such shape and marks as the above plat represents,

Surveyed 1st Dec. 1785,
 J. S. Connell D^y.
 Recorded 3rd Dec. 1785.

North 1680 Chains

South 1440 Chains

West 880 Chains

State of South Carolina, Pursuant to a warrant from John Thomas Esq. I have measured and laid out unto Wade Hampton Esq. a tract of land containing 131160 acres, situate on the north east waters of Alabama or mobile rivers, extending across Emos road highway a river including an Indian town called Highroasa beginning on a sweet gum which is also the beginning corner for an other tract of Wade Hampton Esq. and a station for an other tract of Wade Hampton & Mark Mitchell, bounded to the south by road Hampton & Mark Mitchell W. by Wade Hampton & on every other side by vacant land, and hath such shape and marks as the above Plat represents

Surveyed 2nd Nov. 1785, by Mich. Harrison D^y.
 Recorded 20 Dec. 1785, Det. Col. Hampton