

State of South Carolina Pursuant to
 a warrant from John Thomas Esq. Commissioner
 of locations, I have admeasured and laid out
 unto Charles Sims a tract of 399 acres of land
 in ninety six District, on the branches of
 Parsons Creek, south side of Broad river, and
 hath such shape and marks, buttings and
 boundings as the above Plat Represents,
 Survey, 4th January 1786,

Recorded 27th Jan'y 1786,
 Charles Sims Del.

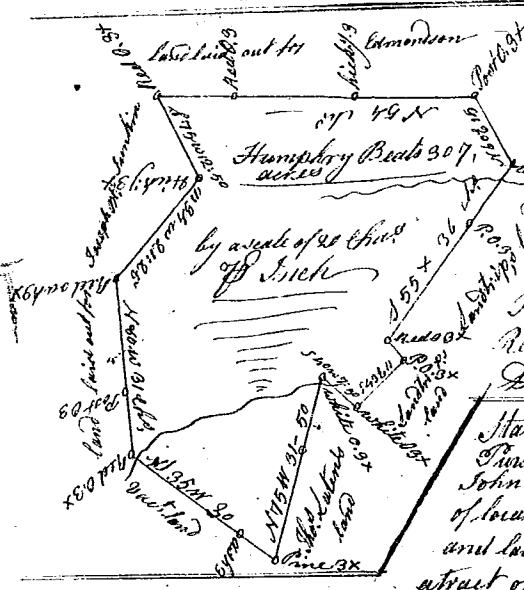
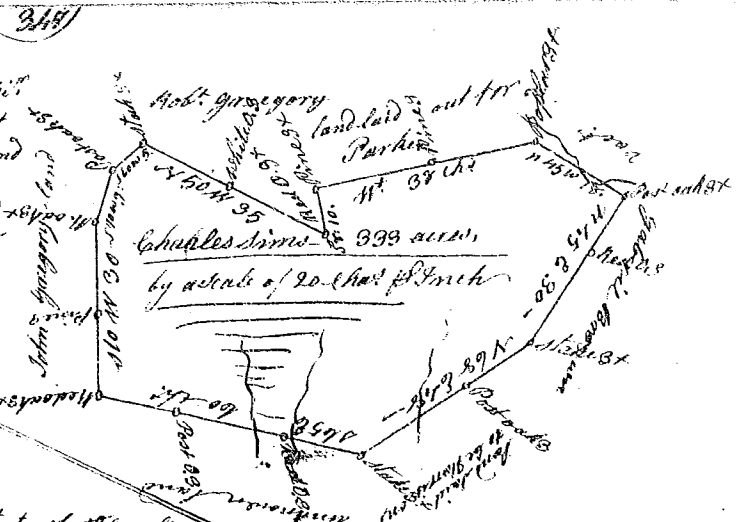

State of S^c Carolina,
 Pursuant to a warrant from John Thomas Commissioner
 of locations, I have admeasured and laid out unto
 Humphrey Beate a tract of 307 acres of land, in ninety
 six District, on the North side of Tygar river, and hath such
 shape from & marks, buttings & boundings as the above
 Plat Represents, Survey, 27th Dec^r 1785
 Recorded the 27th Jan'y 1786
 Del. McCracken

County, Ninety six District below the ancient line on three
 small branches running into Duncans Creek, and hath such
 shapes, marks, buttings & boundings as the annexed Plat
 Represents, - Survey, 30 Nov^r 1785, by Abel Pearson Del.
 Recorded 27th Jan'y 1786.



State of South Carolina Pursuant to a
 warrant from John Thomas Esq. Commissioner
 of locations, I have admeasured and laid out
 unto Reubin Higgins a tract of one hundred acres of land on a small
 branch of Sawyers Creek in Lawrence County, bounded on all sides on
 vacant land, Survey, 29th Dec^r 1785, by Rob^t Hanna Del.
 Recorded 27th Jan'y 1786, Del. W. Higgins

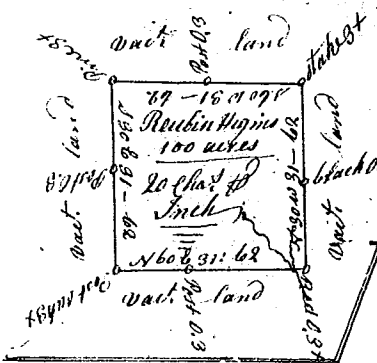

State of S^c Carolina
 Pursuant to a warrant from John
 Thomas Esq. Commissioner of locations
 in 96 District N. Saluda river, I have
 admeasured and laid out unto William Higgins a tract of
 one hundred & thirty acres of land, on a small branch of
 Adams Creek a branch of Enoree river in Lawrence County
 having such shape, marks & boundaries, as the annexed plat
 Represents, - Survey, the 20th Dec^r 1785, by Rob^t Hanna Del.
 Recorded 27th Jan'y 1786, Del. W. Higgins

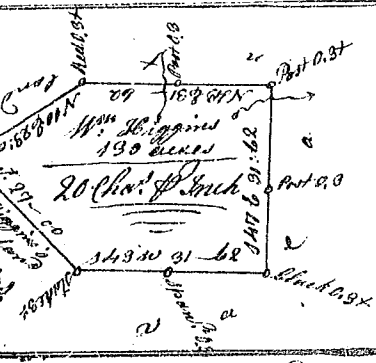

State of S^c Carolina Pursuant to a warrant from John Thomas Esq.
 Commissioner of locations Dated 23 Jan'y 1786, I have admeasured
 and laid out unto George Branton a tract of 176 acres of land on
 branches of Forquerss Creek, waters of Tygar river, bounded
 on all sides as Described in the annexed Plat.
 Survey, 26th Jan'y 1786 James Wofford Del.
 Recorded 27th Jan'y 1786
 Del. Jarr. Branton

