

State of S^c Carolina Pursuant to a warrant from John Thomas Esq. Commissioner of locations Dated 6th Jan^y 1786. I have admeasured and laid out unto James Megoun a tract of three hundred and thirty one acres of land situate between Tygar and Snowe rivers on both sides of two mile creek a branch of Snowe river, Bounded E^t by John Fords land, N^e by vacant land W^e by Burvel Pries land, S^e by Elizah Hendricks Land, and hath such shape and Marks as the annexed Plat Represents, Survey^d 12th Jan^y 1786.

Recorded 11th March 1786, Andrew Thomson Esq.

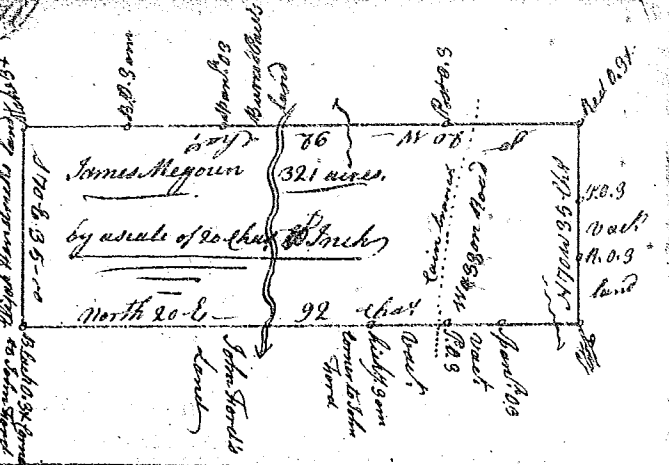

State of South Carolina Pursuant to a warrant from John Thomas Esq. Commissioner of locations Dated 6th District N^e Saluda River, I have admeasured and laid out unto Reubin Stringer a tract of Three hundred acres of land on Saluda river West of the old boundary, Bounding N^e on land laid out to Andrew Wood, S^e all other sides on vacant land, and hath such shape and Marks as the above Plat Represents, Survey^d 14th Feb^r 1786.

Recorded 11th March 1786, Robt Hanna Esq. 18th Stringer



State of South Carolina Pursuant to a warrant from John Thomas Esq. Commissioner of locations dated 10th Feb^r 1785. I have admeasured and laid out unto Alexander Collins a tract of Two hundred and fifty five acres of land, Situate in ninety six District on the SW branches of North Tygar River, and hath such shape, Marks, buttings & boardings as the above Plat Represents, Survey^d 15th Feb^r 1786.

Recorded 13th March 1786, W^m Benson Esq.

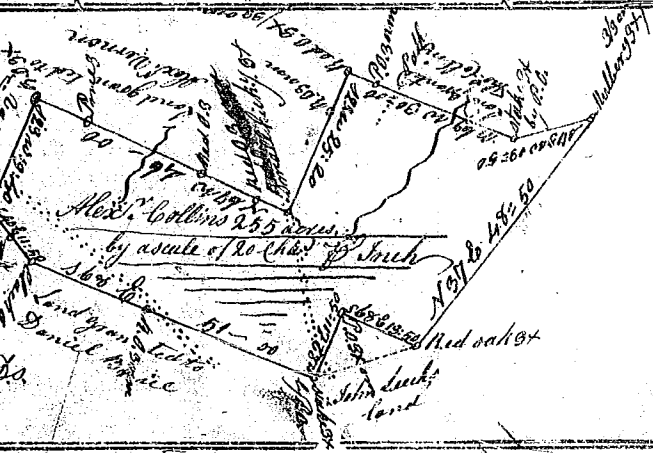

State of S^c Carolina Pursuant from John Thomas Esq. Com^r of Locations Dated the 3rd of March 1786. I have admeasured and laid out unto Major Parsons a tract of One thousand five hundred & forty two acres of Land, Situate in 6th District above the ancient P^rowenary line On both sides of Beannadam Creek of Middle Tygar River, and hath such shape Marks Buttings & Boardings as the annexed Plat Represents Survey^d the 13th of March 1786.

Recorded this 15th of March 1786, by J. Mather Esq.

