

State of South Carolina

(3177)

Pursuant to a warrant from John Thomas Esq. Commissioner of locations, I have admeasured and laid out unto Patrick Carmichael a tract of Two hundred and Ninety four acres of land, in Ninety six district, on the waters of Buffalo & Company Creeks & hath such shape, Marks, buttings and Boundings as the above Plat Represents, Surveyed 15th March 1796 by James Dougherty Esq. Recorded 29th March 1796, Del. South Carolina

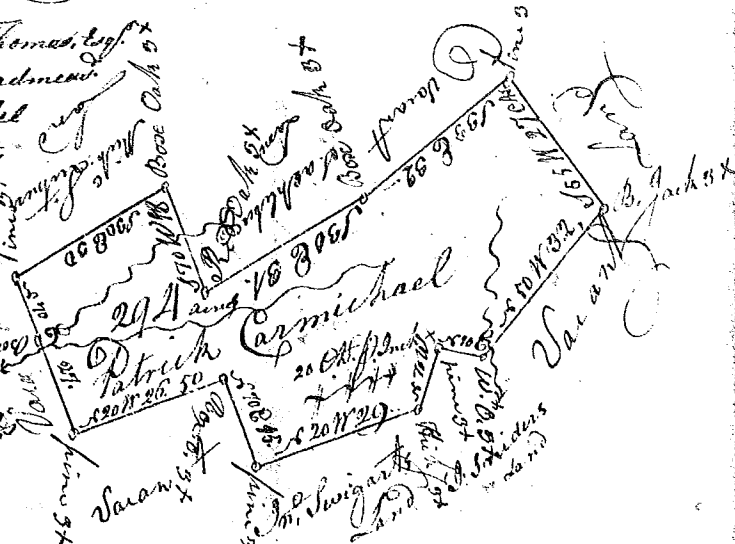

State of South Carolina

Pursuant to a warrant from John Thomas Esq. Commissioner of locations, I have admeasured and laid out unto John M. Clelland a tract of one hundred acres of land, in Ninety six District, below the ancient boundary, on the waters of Cannon's Creek, and hath such shape, Marks, buttings & boundings as the above Plat Represents, Surveyed 16th Febr'y 1796 Recorded 29th March 1796, Del. James Dougherty Esq.



State of South Carolina Pursuant to a warrant from John Thomas Esq. Commissioner of locations dated 10th February 1796, I have admeasured and laid out unto George Stays a tract of one hundred & seventy five acres of land, in Ninety six district, on the branches of Wolf's Creek waters of Enoree River, one mile south of Moses woods land, and hath such shape, Marks, buttings and boundings as the above Plat Represents, Surveyed 20 March 1796 John Young Esq. Recorded 30th March 1796, Del.



State of South Carolina Pursuant to a warrant from John Thomas Esq. Commissioner of locations dated 8th March 1796, I have admeasured and laid out unto Thomas Wood a tract of one thousand acres of land, in Ninety six District above the old boundary, on both sides of beaverdam Creek of Enoree river, and hath such shape, Marks, buttings & boundings as the above Plat Represents, Surveyed 16th March 1796 Recorded 31st March 1796, Del. Joseph Walker Esq.

