

State of South Carolina 96 District John Alexander's
 Pursuant to a warrant from John Thomas Esq. Commissioner of locations dated 11th Sept. 1786, I have admeasured and laid out unto Absolom Cramer a tract of two hundred acres of land on the Needy fork of Needy River, bounded W. by John Alexander's land E. by Robert Baker's land, all other sides by vacant land, and hath such shape, form and marks as the above Plat represents, Surveyed 19th Oct. 1786, Recorded 30th Oct. 1786, Det. self, James Wofford D.S.

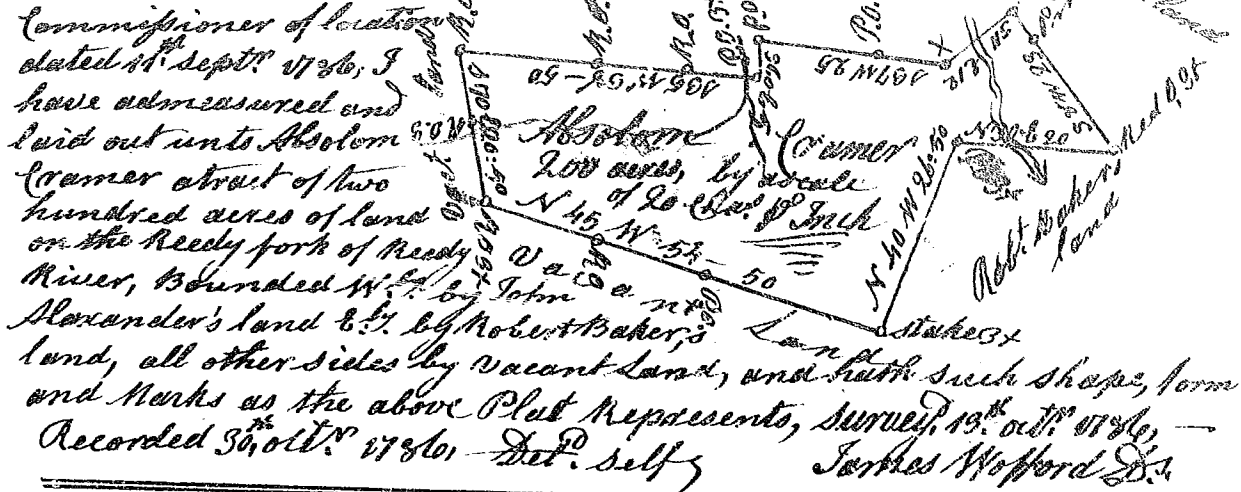

State of S^c Carolina

Pursuant to a warrant from John Thomas Commissioner of locations, S. Sabuda, dated 16th Oct. 1786 I have admeasured and laid out unto John Means a tract of one hundred & twenty five acres of land, in Richland County 96 District, on two small branches of Williams's Creek Waters of Broad River, and hath such shape, marks, settings & Boundings as the above Plat represents, Surveyed 27th Oct. 1786, Recorded 30th Oct. 1786, Det. Tho. Means, Abel Pearson D.S.

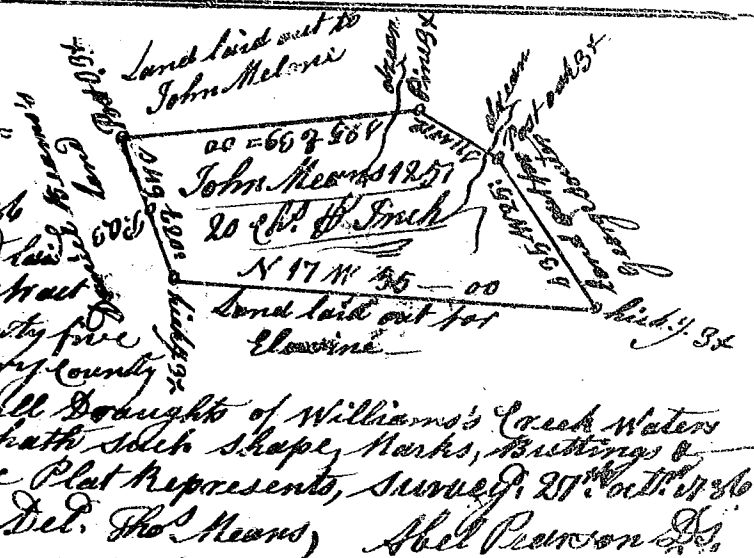

State of S^c Carolina

Pursuant to a warrant from John Thomas Esq. Dated the 13th July 1786, I have admeasured & laid out unto William Davis a tract of ninety four acres of land, situated in Ninety Six District N^o of Saluda West of the Old Boundary, on both sides the S^e Fork of the S^e fork of Sugar River. & hath such form marks & Boundings as the above Plat represents, Surveyed the 10th July 1786, Recorded 30th Oct. 1786, Det. self, J. W. Thomas D.S.

