

S. Carolina

Pursuant to a
Warrant from

John Thomas Esq.
C. S. Dated the
11th Oct. 1786

I have Admeas-
ured & laid out
unto Maasworth & Terbin
a tract of 1112 Acres
of Land & situated in 90th
District & County of Spartanburg
beneath on the South fork
of Lawson's fork creek of the
River of South Carolina & marked
as the above tract represents
Surveyed the 15th Oct. 1786

Wm. Benson D.

Recorded this 11th Nov. 1786 Dist. the Recorder

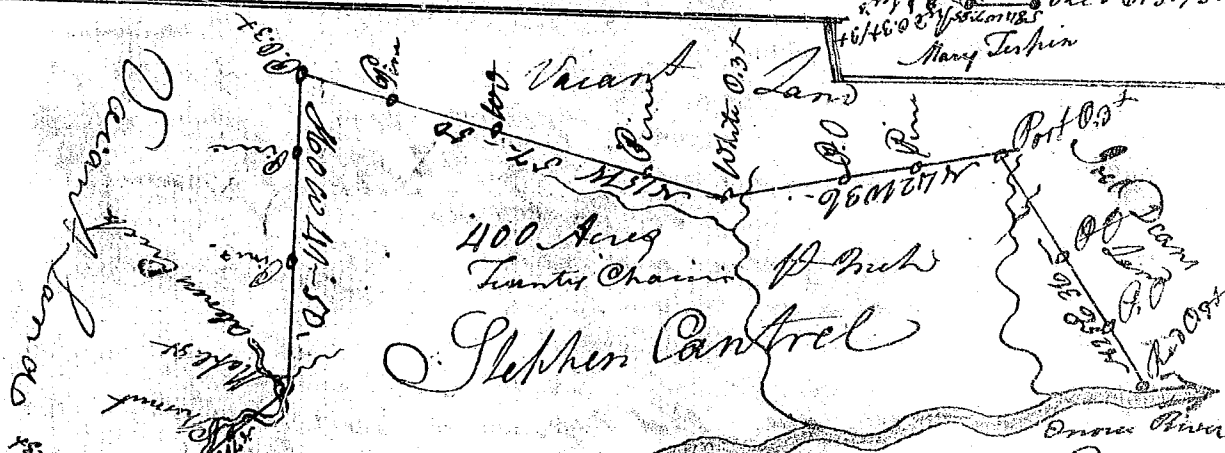

S. Carolina Pursuant
to a warrant from John Thomas Esq.
C. S. Dated the 11th Aug. 1786. I have
admeasured & laid out unto Stephen Cantrel
a tract of 400 Acres of Land. situated on the
West side of Snow River
Dated land by South fork of the
River of South Carolina & marked
as the above tract represents
Surveyed the 10th Aug. 1786
Recorded the 11th Nov. 1786
by James Wofford D.S.