

State of S^c Carolina

Pursuant to a warrant from John Thomas Esq. Com^r of locations dated 20th Sept. 1786,

I have admeasured and laid out unto Turner Thomason a tract of more or less one thousand acres of land in 96 District Spartanburg County, on the branches of Lawson's fork of Peters Creek, and hath such shape and Marks as the above Plat represents to

Survey 2^d Oct. 1786
John Cornell Esq.

Recorded & Eapsed for Col. Richard Richardson, Rob^t H. Hughes & Co. the 7th Febr^y 1787

Turner Thomason 1000 acres
By a scale of 20 Ch. P. Inch

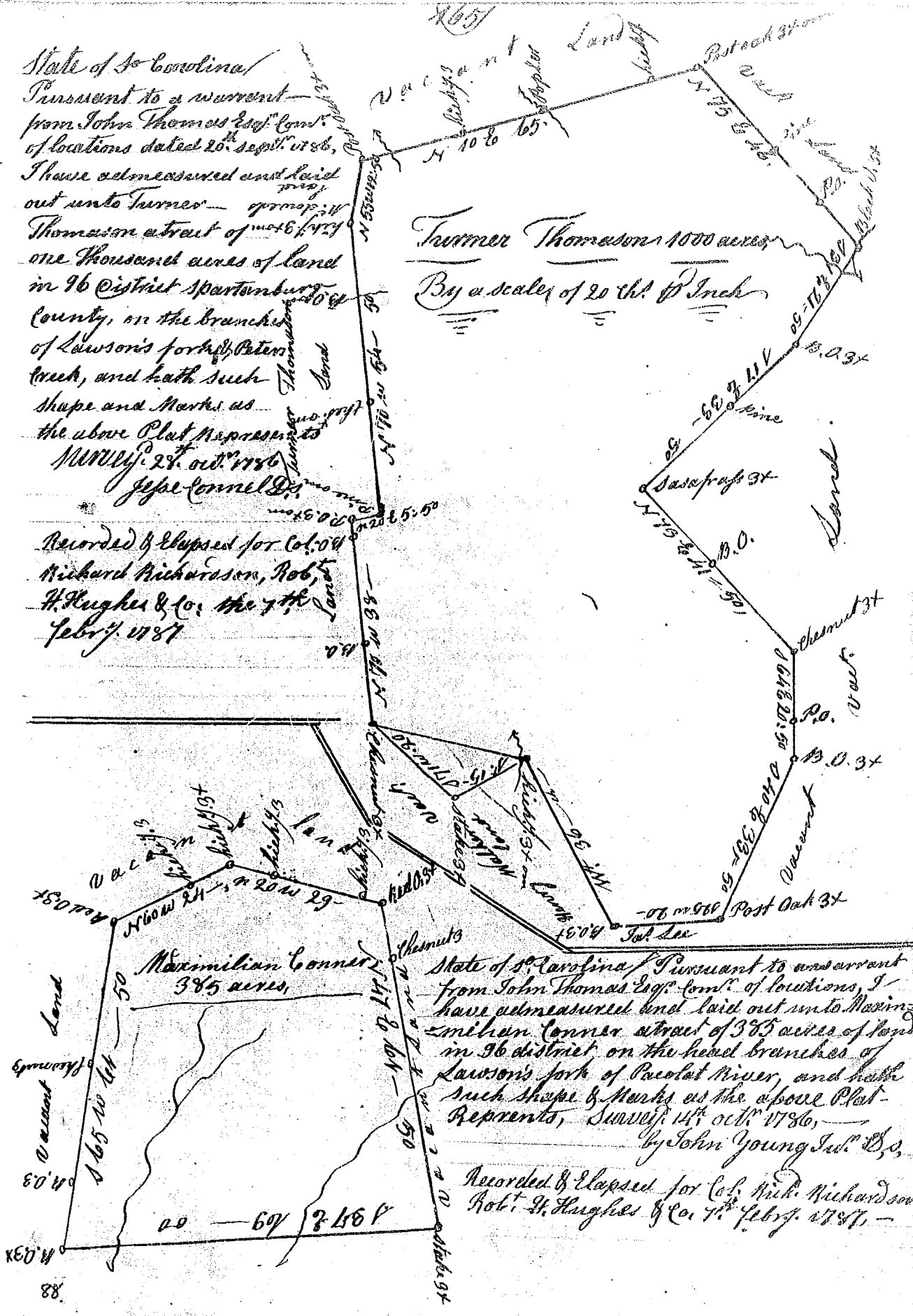

State of S^c Carolina Pursuant to a warrant from John Thomas Esq. Com^r of locations, I have admeasured and laid out unto Maximilian Conner a tract of 385 acres of land in 96 District on the head branches of Lawson's fork of Peolat River, and hath such shape & Marks as the above Plat represents, Survey 14th Oct. 1786,
By John Young Esq. S.

Recorded & Eapsed for Col. Rich. Richardson Rob^t H. Hughes & Co. the 7th Febr^y 1787.