

State of S. Carolina Pursuant to a warrant  
 from John Thomas Esq. Comm. Location  
 N. of Saluda Dated the 11<sup>th</sup> Nov. 1786

I have admeasured & laid out  
 unto William Woodhewer a tract  
 of 163 acres of land in Union  
 County below the ancient limits  
 On Frenchmans Creek of Snow  
 River and hath set forth marks  
 Bettings & Boundings as the above  
 represents Surveyed the 23<sup>rd</sup> Dec. 1786

Recorded 21<sup>st</sup> Dec. 1787  
 Elapsed by Jeremiah Cooper Esq.



Pursuant to a warrant from John Thomas  
 Esq. Commissioner of Locations N. of Saluda  
 I have admeasured & laid out unto John  
 Young a tract of 60 acres of land lying on  
 Harris Creek of Fairforest, bounded on  
 the NW on Parkers land N. on Bullards land SW on Samuel  
 Thomsons land and hath set forth marks on the above  
 real represents Surveyed the 1<sup>st</sup> October 1784

Recorded 21<sup>st</sup> Dec. 1787  
 S. Carolina

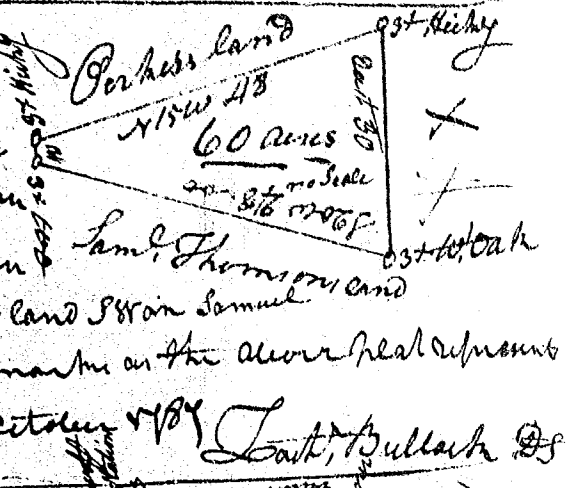

Pursuant to a warrant  
 from John Thomas Esq. Esq.  
 dated the 1<sup>st</sup> Dec. 1786 I have  
 have admeasured & laid out  
 unto Elias Hollingsworth a tract  
 of 300 acres of land situated  
 in 96 District on Carolina  
 Creek of Long Run  
 and hath set forth marks  
 Bettings & Boundings  
 as the above  
 real represents  
 Surveyed the 18 January 1787

Recorded 21<sup>st</sup> Dec. 1787  
 Ber. Glenn Esq.

