

3<sup>rd</sup> Carolina Pursuant to a warrant (289)  
 from John Thomas Com<sup>r</sup> of locations N<sup>o</sup> 146  
 Dated 1<sup>st</sup> Oct<sup>r</sup> 1787 I have admeasured and laid out  
 unto John Dawson a tract of one hundred acres of  
 land, on the S<sup>o</sup> side of the glucky Mountain,  
 on the small branches of Sugar & Pacolite rivers,  
 bounded on all sides by vacant land, and  
 hath such form and Marks as the above  
 Plat represents, Survey<sup>d</sup> 6<sup>th</sup> Oct<sup>r</sup> 1787.

Recorded 2<sup>d</sup> Jan<sup>y</sup> 1788, by Aud<sup>r</sup> Thomas De

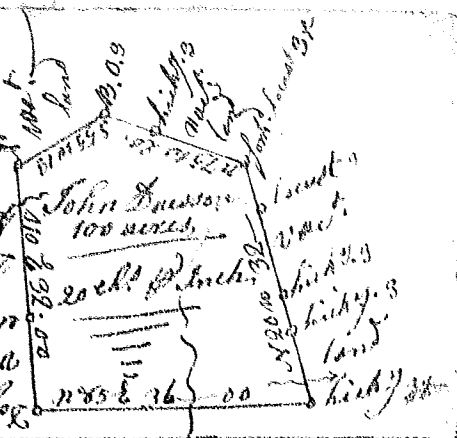

3<sup>rd</sup> Carolina Pursuant to a warrant from  
 John Thomas Com<sup>r</sup> of locations 96 District  
 N<sup>o</sup> 146, dated 25<sup>th</sup> Dec<sup>r</sup> 1787 I have  
 admeasured & laid out unto Alex<sup>r</sup>  
 Hamilton a tract of 650 acres of  
 land in D<sup>o</sup> District on Pacolat river  
 bounding by a line running NW by  
 land survey for Geo. Moore by a line  
 running NW by land survey for  
 Phil. Pikes by a line running N.E. w<sup>th</sup>  
 by lands survey for one Tidner and  
 John Weedingman other side Pacolat  
 river, and hath such shape and  
 Marks as the above Plat represents

Recorded 5<sup>th</sup> Jan<sup>y</sup> 1788, by Del<sup>t</sup>



3<sup>rd</sup> Carolina Pursuant to a warrant from John  
 Thomas Com<sup>r</sup> of loc<sup>o</sup> 96 District N<sup>o</sup> 146  
 dated 25<sup>th</sup> Dec<sup>r</sup> 1787, I have admeasured  
 and laid out unto Alex<sup>r</sup> Hamilton a tract  
 of 600 acres of land in D<sup>o</sup> District on Pacolat  
 river, bounding by a line running NW. by  
 land survey for John Weedingman all other  
 sides on Pacolat river, and hath such shape and marks  
 as the above Plat represents Survey<sup>d</sup> 31<sup>st</sup> Dec<sup>r</sup> 1787,

Recorded 5<sup>th</sup> Jan<sup>y</sup> 1788.

