

State of Carolina. Pursuant to a warrant from John Thomas Esq. I have admeasured & laid out unto Tilman Bobo a tract of One Hundred and fifty acres of land joining on the North side of Enoree River in Union County and hath such shape & marks as the above head Represents

Surveyed the 14<sup>th</sup> Feb<sup>ry</sup> 1787  
Recorded the 4<sup>th</sup> July 1788

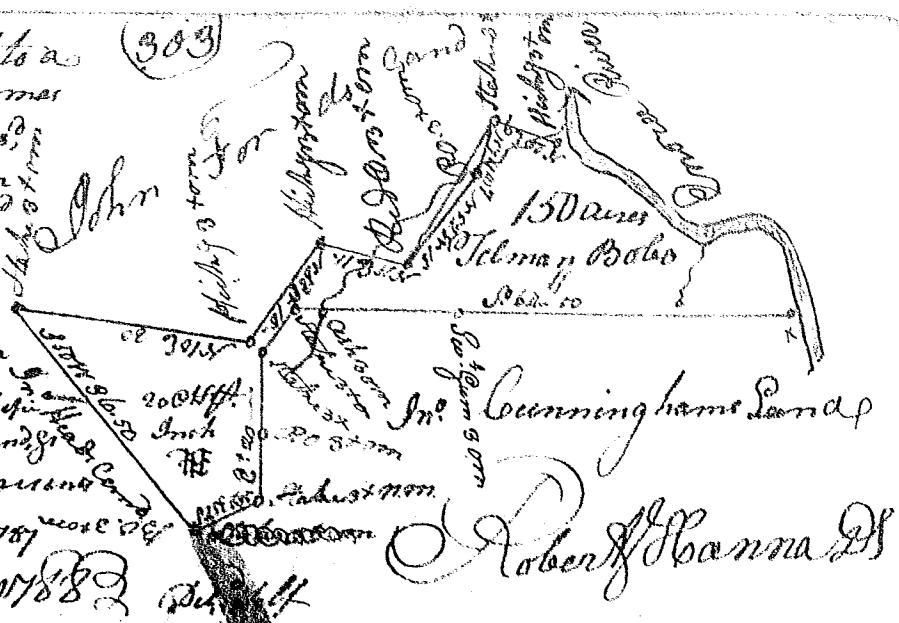

State of Carolina

Pursuant to a warrant from John Thomas Esq. Comm. I have admeasured & laid out unto Bayce Rather a tract of 510 acres of land on the waters of Duncan's creek in Laurens County having such shape & marks as the above head Represents

Surveyed the 29<sup>th</sup> Jan<sup>y</sup> 1788  
Recorded the 4<sup>th</sup> July 1788

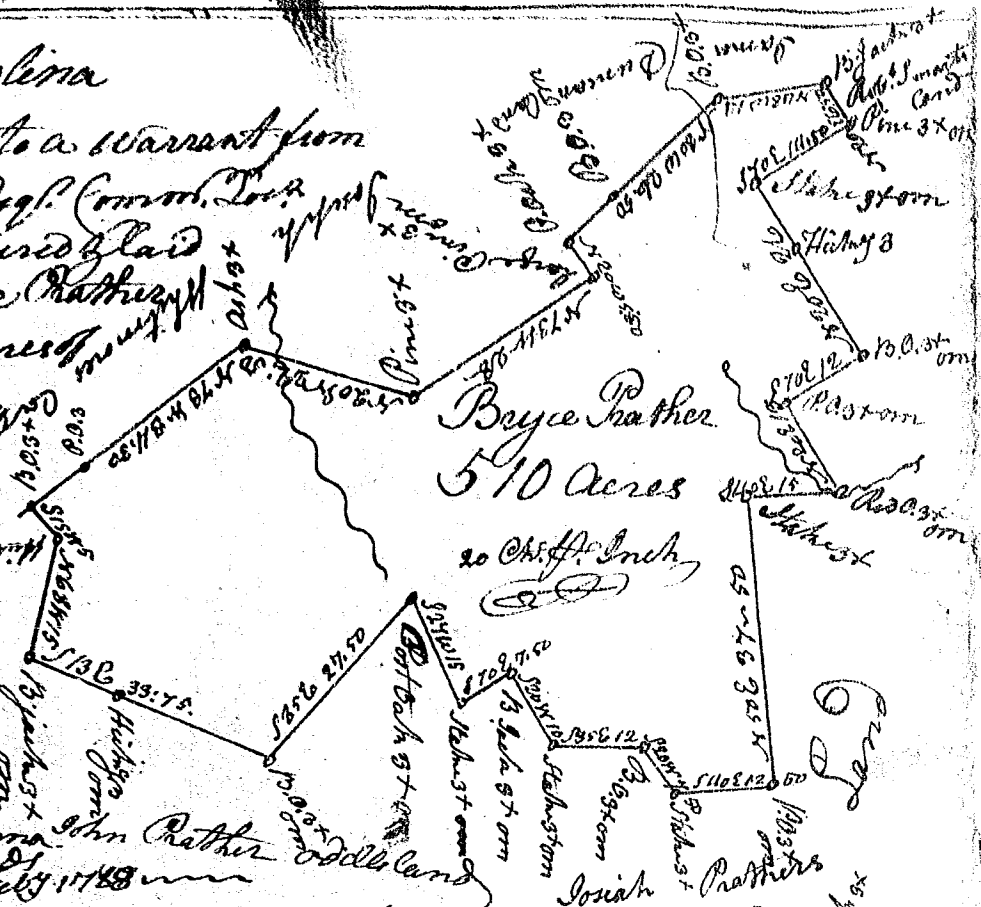

State of Carolina Pursuant to a warrant from John Thomas Esq. Comm. of locations. I have admeasured & laid out unto Bayce Rather a tract of Fifty acres of land on a small branch of Enoree River in Union County bounding S. & E. on Caleb Edmundson's land all other sides on vacant land and hath such shape & marks as the above head Represents

Surveyed the 22<sup>nd</sup> Jan<sup>y</sup> 1788  
Recorded the 4<sup>th</sup> July 1788

