

(38)  
 South Carolina Pursuant to a warrant from John Thomas Esq. Comr. of locat. dated 30<sup>th</sup> June 1783, I have admeasured and laid out unto Ephraim Ellis a tract of 172 acres of land in Greenville County on both sides of the Devils fork of the Middle fork of Saluda river, bounded by lines running N 75 E 26:00 by land laid out for Ephraim Ellis all other sides on vacant lands and hath such form and Marks as the above Plat represents.

Surveyed 2<sup>nd</sup> July 1784.  
 Recorded 6<sup>th</sup> Sept. 1785. George Saimen D.  
 Sub. sur.

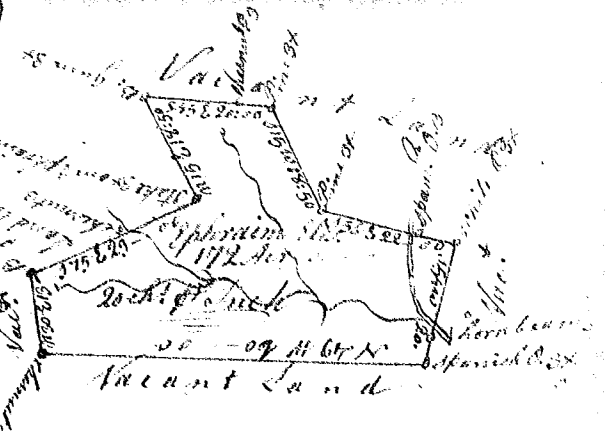

South Carolina, Pursuant to a warrant from John Thomas Esq. Comr. of locat. for 96 District of Saluda, I have admeasured and laid out unto Edward Moore a tract of five hundred & fifty acres of land in said District, on Cain creek of Tugar river, and hath such shape, form & Marks, buttings and Boundings as the above Plat represents.

Surveyed 4<sup>th</sup> Sept. 1785.  
 Recorded 9<sup>th</sup> Sept. 1785. Lewis D.  
 Sub. sur.

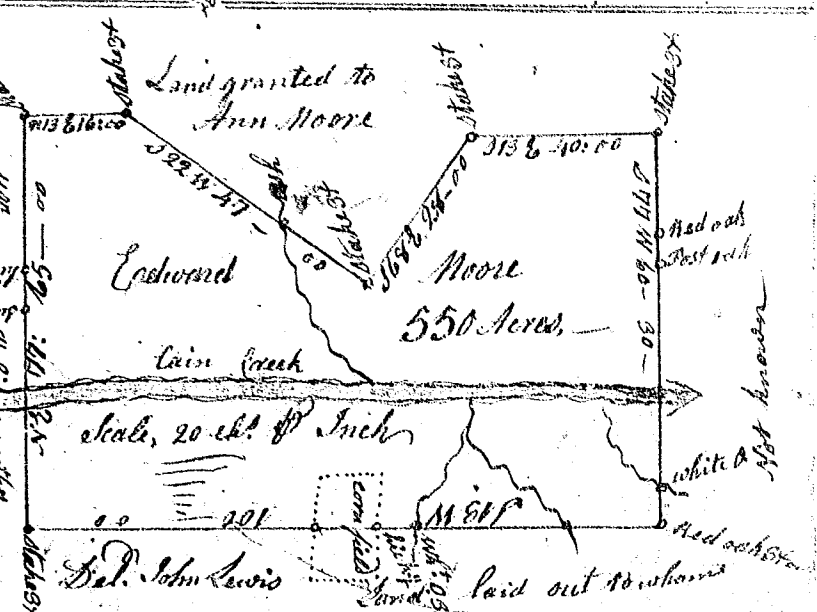

State of S<sup>c</sup> Carolina Pursuant to a warrant from John Thomas Esq. Comr. of locatens ninety six Dist. of Saluda river dated 9<sup>th</sup> June 1783, I have admeasured and laid out unto Daniel Dutton a tract of 185 acres of land, in s<sup>d</sup>. District on a branch of wildcat creek of S<sup>c</sup> Tugar river in Greenville County, bounded by a line running S 84 E 30 by land survey, for Patrick Shaw, N 75 E 26 by land survey, for James Gray, N 70 W, by land unknown, all other sides Vacant Land, and hath such form and Marks as the above Plat represents. Surveyed 10<sup>th</sup> June 1786.  
 Recorded 13<sup>th</sup> Sept. 1786.



South Carolina Pursuant to a warrant from John Thomas Esq. Comr. of locatens ninety six Dist. of Saluda river dated 9<sup>th</sup> June 1783, I have admeasured and laid out unto Daniel Dutton a tract of 185 acres of land, in s<sup>d</sup>. District on a branch of wildcat creek of S<sup>c</sup> Tugar river in Greenville County, bounded by a line running S 84 E 30 by land survey, for Patrick Shaw, N 75 E 26 by land survey, for James Gray, N 70 W, by land unknown, all other sides Vacant Land, and hath such form and Marks as the above Plat represents. Surveyed 10<sup>th</sup> June 1786.  
 Recorded 13<sup>th</sup> Sept. 1786.