

South Carolina

Pursuant to a warrant from John Thomas Esq. Comr. of loc. & sur. No. Saluda, dated 24th Sept 1788, I have advertised & laid out unto Thomas Houde a tract of 298 acres of land, S^e side broad river on Quintens branch, bounded by a line running N 44^o E by Dawson's line, S 44^o W by J. Kennedy's line, S 40^o E by Alan Davis's line, all other sides vacant and hath such shape and marks as the above Plat represents, Survey 28th Oct. 1788
 Recorded 10th Jan^y 1789, Del. J. Davis

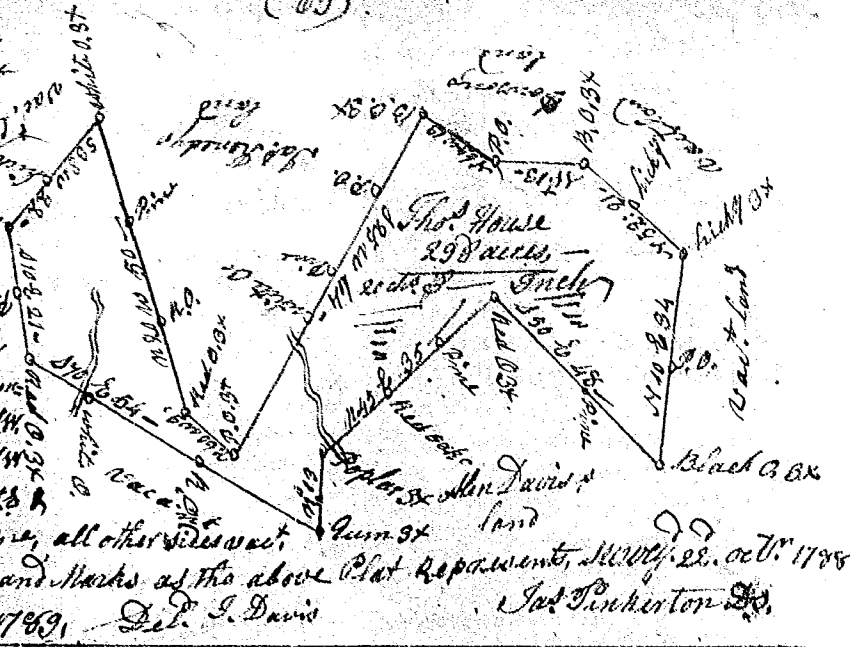

State of South Carolina Pursuant to a warrant from John Thomas Esq. Comr. of locations, I have laid out unto Land lot Porter a tract of 424 acres of land in 9th District, on Paco's lat river, and hath such shape form, marks, buttings & boundings as the annexed Plat represents, Survey 2nd Nov. 1788
 Charles Sims Esq.
 Recorded 16th Jan^y 1789, Del. A. Pearson



State of S. Carolina Pursuant to a warrant from John Thomas Esq. Comr. of locs, I have laid out unto Land lot Porter a tract of 256 acres of land in 9th District, the N^o side of Paco's river, and hath such shape, marks, buttings and boundings as the annexed Plat represents, Survey 27th Oct. 1788,
 Charles Sims Esq.
 Recorded 16th Jan^y 1789, Del. A. Pearson

