

State of South Carolina Pursuant to (173)

a warrant from John Thomas Comr of
 Loc 1st of Saluda river dated 24th Jan 1789
 I have measured and
 laid out unto Michael Beatts
 about of Three hundred &
 Seventy five acres of land,
 in 9th District, below the
 ancient limits, on the
 waters of Buffalo, and
 Camping Creek waters,
 and hath such shape,
 Marks, cuttings and
 boundaries as the a-
 bove Plat represents,
 Surveyed 10th March 1789,

Petermiah Cooper De.
 Recorded 21st March 1789,
 De P. Self,

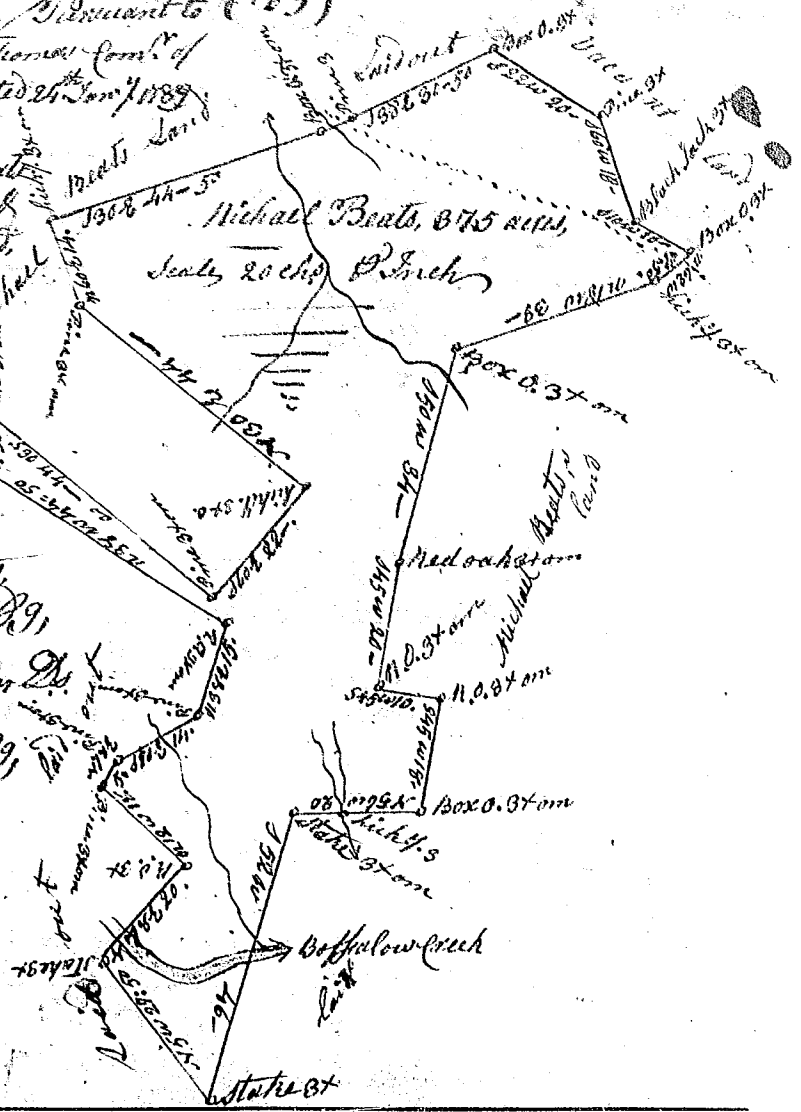

South Carolina } Pursuant to a
 Greenville County }

Warrant from John Thomas Esq. Comr
 for County 1st District of Saluda River,
 I have measured and laid out unto Thomp-
 son Bristol a part of Four hundred & forty
 six Acres of Land, in the district aforesaid
 on the N^o of Saluda River, on the waters of
 Horse Creek & hath such shape form Marks
 cuttings & boundaries as the above Plat
 Represents

Surveyed this 1st day of Aug 1789
 In Lewis Orr
 Recorded the 5th of March 1789 Delivered to the Owner

