

South Carolina Pursuant to a warrant from John Thomas Esq. of loc. of 100th 1808 Saluda, I have admeasured & laid out unto John Ware a tract of 304 acres of land in said District, on branches of the goldenrove creek, water of saluda river, on hath such shape, buttings and boundings as the above Plat represents,

Certified for the 6th May 1789,
John Lewis Esq.
Recorded 27th Oct. 1789, Del. M. Pollard



State of S. Carolina Pursuant to a warrant from John Thomas Esq. Commissioner of locations 96th District of Saluda, I have admeasured and laid out unto John Ware a tract of 174 acres of land, in said District on Saluda River, and hath such shape, Marks, buttings & boundings as the above Plat represents. Survey, 6th May 1789,
John Lewis Esq.

Recorded 27th Oct. 1789, Del. M. Pollard

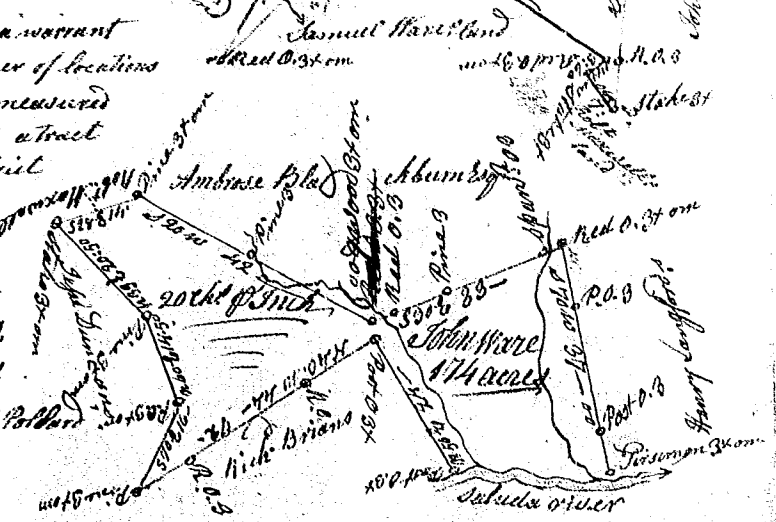

State of S. Carolina Pursuant to a warrant from John Thomas Esq. Com. of locations Cated 13th febr. 1788, I have admeasured and laid out unto John M. Coole a tract of 40 1/2 acres of land in 96th District on the waters of Timber Creek a branch of Eggars river, and hath such shape form & marks as the above Plat represents

Survey, 18th March 1788,
Gen. Hopkins Esq.
Recorded 3. 8th 1789
Gen. S. Hopkins

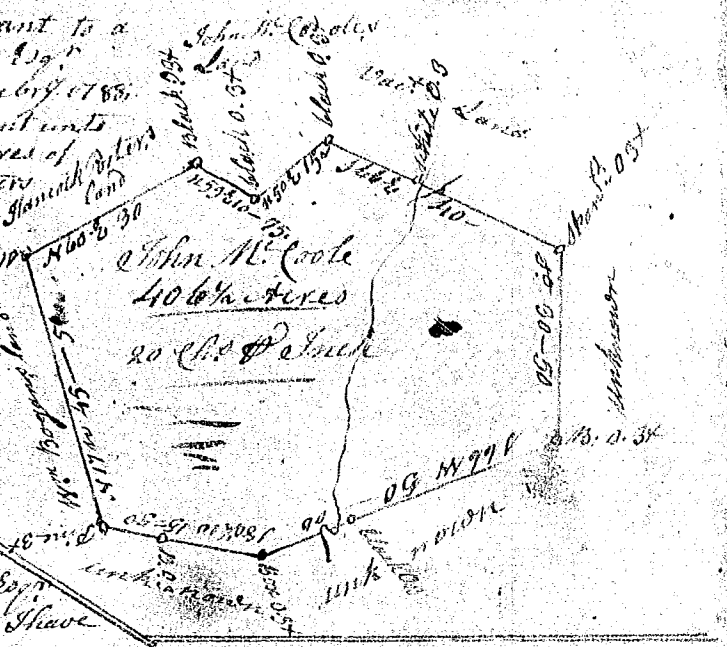

State of S. Carolina Pursuant to a warrant from John Thomas Esq. Com. of loc. Dated 11th May 1789, I have admeasured and laid out unto John Jones a tract of one hundred and forty acres of land, in Laurens County 96th District on Keyburns Creek, bounded on Mary Jones's land, W. on Samuel Dunlop's land, S. by William Daniels land Et. on John Richeys land, & vacant Land, and hath such shape form & Marks as the above Plat represents, Survey, 28th July 1789,

Forth. Courts Esq.
Recorded 4th November 1789
Gen. Self

