

State of S. Carolina  
Laurens County

Pursuant to a warrant from John Thomas Esq. Comr. of loc<sup>ns</sup> Saluda dated 9<sup>th</sup> Nov<sup>r</sup> 1790 I have admeasured and laid out unto William Anderson a tract of two hundred and five acres of land in said District on branches of Saluda river & Needy rivers, bounding N on Isaac Hendricks & Robert Long S. and S.E. on lands of William Anderson, Morgans & Hains, Hendrick, and with such shape form and marks as the above Plat represents, SURVEY 8<sup>th</sup> febr<sup>y</sup> 1791, Recorded 14<sup>th</sup> febr<sup>y</sup> 1791, De Witt, John Rodgers Esq.

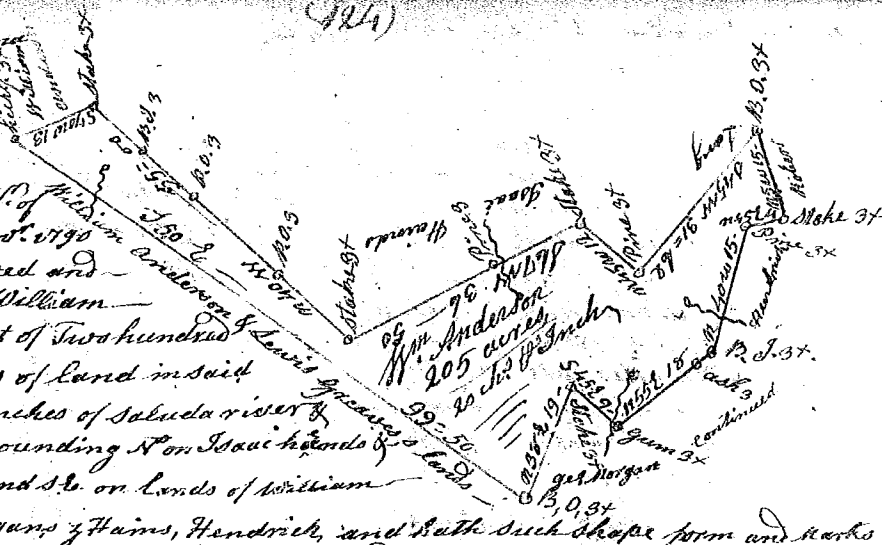

State of S. Carolina Pursuant to a warrant from John Thomas Esq. Comr. of loc<sup>ns</sup> Saluda dated 30 sept<sup>r</sup> 1790, I have admeasured and laid out unto James Amos a tract of 400 acres of land in 96<sup>th</sup> District on the S. fork of the Sugar River in Spartanburg County bounding by a line running N.W. & N.E. by Edson's land N.W. & John Brooks land N.W. by Young Griffins land all other sides vacant, and with such form and marks as the above Plat represents, SURVEY 22<sup>nd</sup> Oct<sup>r</sup> 1790, by W.D. Thomas Esq. Recorded 16<sup>th</sup> febr<sup>y</sup> 1791, De Witt, J. A. Griffin

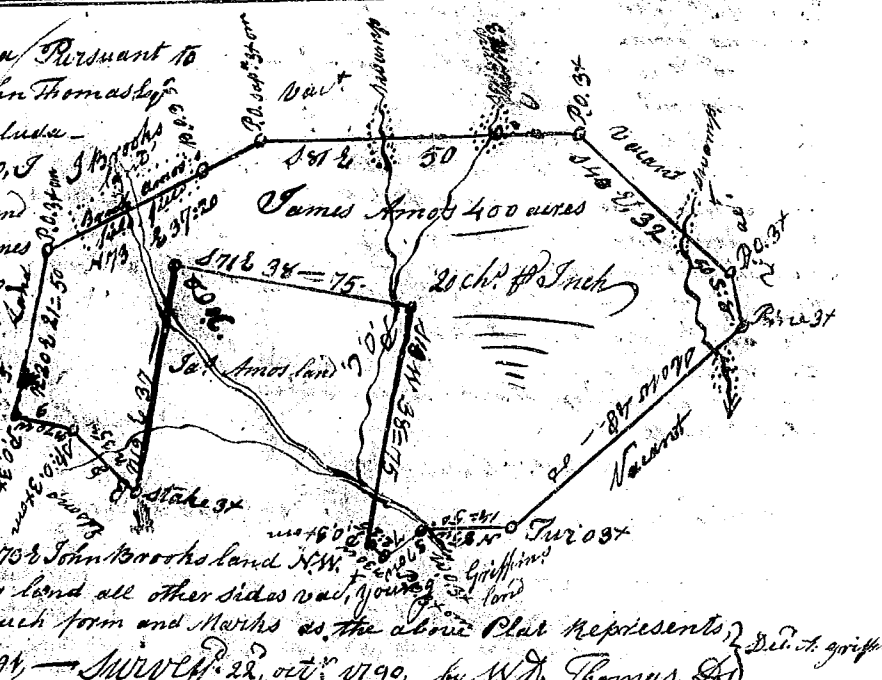

State of S. Carolina Pursuant to a warrant from John Thomas Esq. Comr. of loc<sup>ns</sup> Saluda dated 17<sup>th</sup> Oct<sup>r</sup> 1790 I have admeasured and laid out unto Young Griffin a tract of two hundred & eighty six acres of land in said District on branches of the N. & Middle fork of Sugar river in Spartanburg County near Lees's mills, bounding SW & N.W. by Young Griffins land N.E. east or near Wm Davis land all other sides vacant, and with such form and marks as the above Plat represents, SURVEY 18<sup>th</sup> Nov<sup>r</sup> 1790, W.D. Thomas Esq. Recorded 16<sup>th</sup> febr<sup>y</sup> 1791, De Witt, J. A. Griffin

