

State of South Carolina Pursuant to a warrant from
 John Thomas Esq. Com. of loc. dated the 15th febr. 1791
 I have admeasured and laid out unto John Strunge
 a tract of one hundred & fifty acres of land, in 36th District on the waters of Snow
 = lat river, bounding by a line running
 S. E. N. E. on land surveyed for John Strunge
 by a line N. W. on land surveyed for
 W. Sison, all other sides on vacant
 land, or unknown lands, and hath
 such form and marks as the above
 Plat represents, Surveyed the 15th febr. 1791
 Recorded the 12th of april 1791. Del. self.

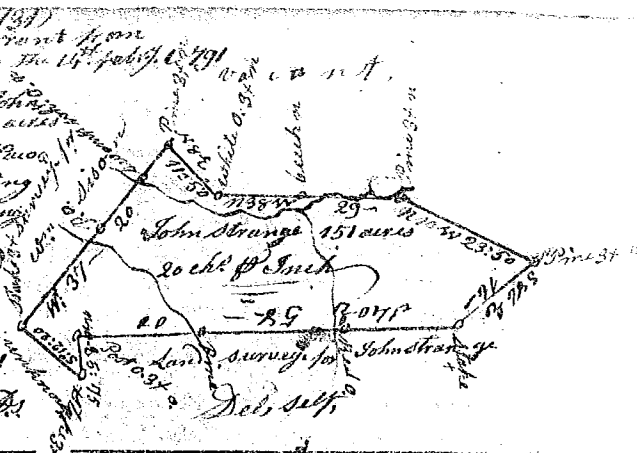

State of South Carolina Pursuant to a warrant
 from John Thomas Esq. Com. of loc. dated
 14th febr. 1791, I have admeasured and laid out
 unto John Strunge a tract of Two hundred and
 seventy five acres of land in 36th District on the
 waters of thickety creek, bounding by a line
 running S. by land surveyed for John Strunge,
 by a line N. S. W. by land surveyed for W.
 Cotton, by a line N. S. E. by land surveyed
 for John M. Whorles, all other sides on vacant
 or unknown lands, and hath such form
 and marks as the above Plat represents,
 Surveyed the 14th febr. 1791,
 Recorded the 12th of april 1791. Del. self.

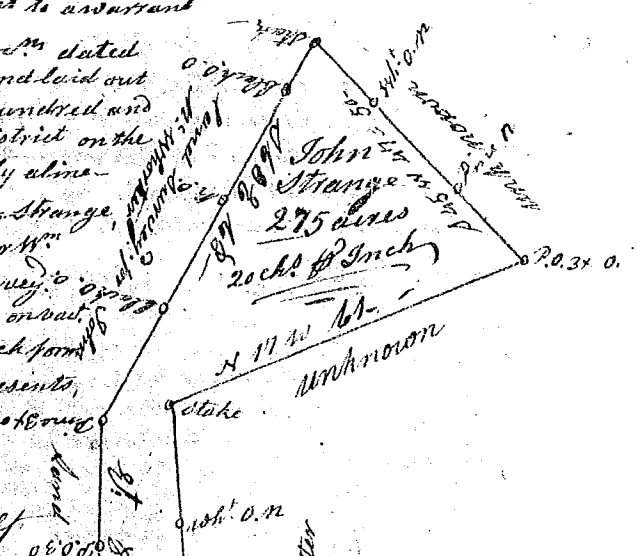

South Carolina Pursuant to
 a warrant from John Thomas Esq.
 Com. of loc. in 36th district Asulaka
 dated 1st febr. 1791, I have adme-
 = asured and laid out unto David
 Qualls a tract of Two hundred
 and sixty five acres of land in
 said District lying on the N. side
 of Snow river, bounded S. ward
 by said river, running N. E. with
 James Daniel's land, S. E. with
 Wanderhorst's land, S. W. with Thos. Scott's land,
 all other sides by vacant land, and hath such
 shape and marks as the above Plat represents,
 Surveyed the 3rd febr. 1791, James Wofford Esq.
 Recorded the 10th of april 1791, Del. self.

