

State South Carolina

Pursuant to a warrant

from John Thomas Esquire Commr. of Land. Dated the 11th June 1791. I have admeasured & laid out unto Michael Purkle a tract of One Hundred & Ninety five acres of land. Situate in Greenville County, on a branch of Reedy River called the Reedy fork - Bounded to the N.W. by Jonathan Downs's land S.E. by Drury Sims land, and Mary Barrow's land. South by land laid out as known, and the other side by vacant land - and hath such form & marks as the above plat represents. Survey, 10th July 1791

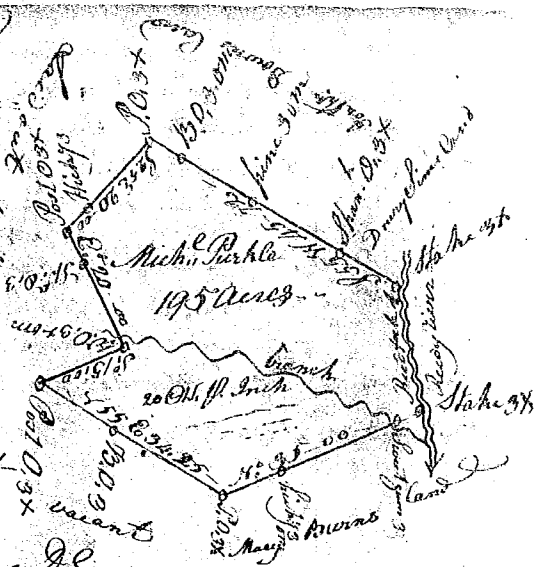

Recorded the 20th Augt 1791. Del. self - J. Downs

South Carolina Pursuant to a warrant from John Thomas Esq. Comr. of loc. & Saluda dated 17th May 1791, I have admeasured and laid out unto Samuel Miller a tract of one hundred and eighty five acres of land in 96th District in Spartanburg on a branch of Little Sycamore River, bounding by a line running S. on land granted to Robert Miller, 100. by James Pedon S.E. S.W. by James Miller, and hath such shape and marks as the above Plat represents, Survey, 21st May 1791. Wm. Benbow Recorder 20th Augt 1791

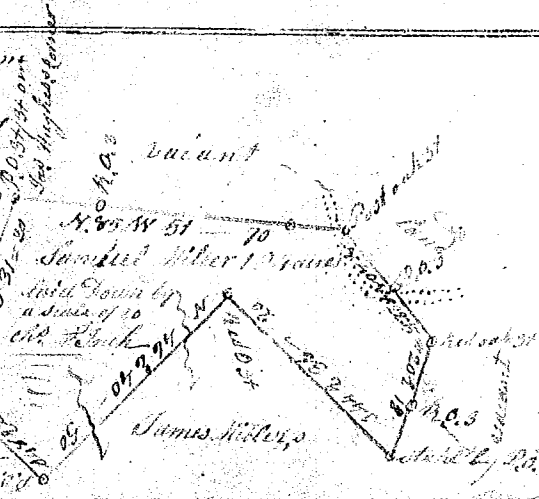

South Carolina Pursuant to a warrant from Laurens County John Thomas Esq. Comr. of loc. in 96th District & Saluda dated the 18th August 1791, I have admeasured and laid out unto James Hodgers a tract of three hundred and seven acres of land in said District on a branch of Tweedy's Creek and Little River, bounded by on J. H. Moore and Robert Tweedy N. not known E. on Michael Waldrop & Robert Cooper S. Highcamp and Shadrick Martin, and hath such shape form & marks as the above Plat represents. Survey, 19th Augt 1791. Recorded 23rd Augt 1791. John Rodgers

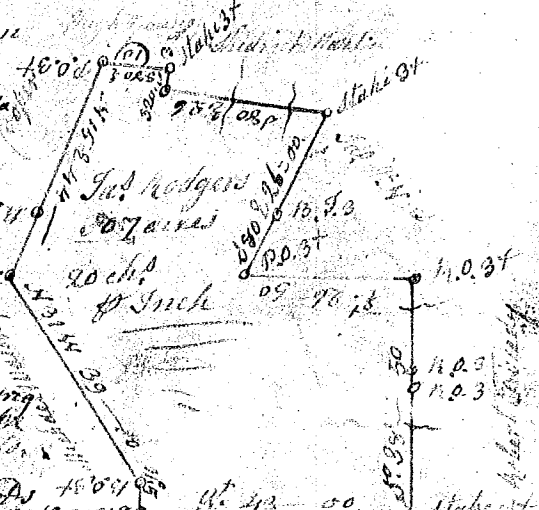

South Carolina Pursuant to a warrant Laurens County from John Thomas Esq. Comr. of location in 96th District & Saluda dated 18 Augt 1791. I have admeasured and laid out unto James Hodgers a tract of 173 acres of land in S. District on a branch of North Creek & Little River waters of Saluda, bounded by lines N. of Shadrick Martin and John Boyce E. on Robert Cooper N.W. by Richard Hicks, and hath such shape form and marks as the above Plat represents. Survey, 19th Augt 1791. Recorded the 23rd Augt 1791. Del. self - J. W. Rodgers

