

State of S^c Carolina

(190)

Pursuant to a warrant from John Thomas Esq Com^r of loc^l in 96th District N^c Saluda dated 27th July 1791, I have admeasured and laid out into 500 acres of land in said District on the S^c fork of bruskey Creek of Needy River in Greenville County bounding by a line running N^W N^E 80^o E by Hugh Neash's land N^E by Daniel James Alton's land N^W by Daniel Simons' land S^E by Turpins and Part unknown lands the other lines on Grants Land and both form and Marks as the above Plat represents

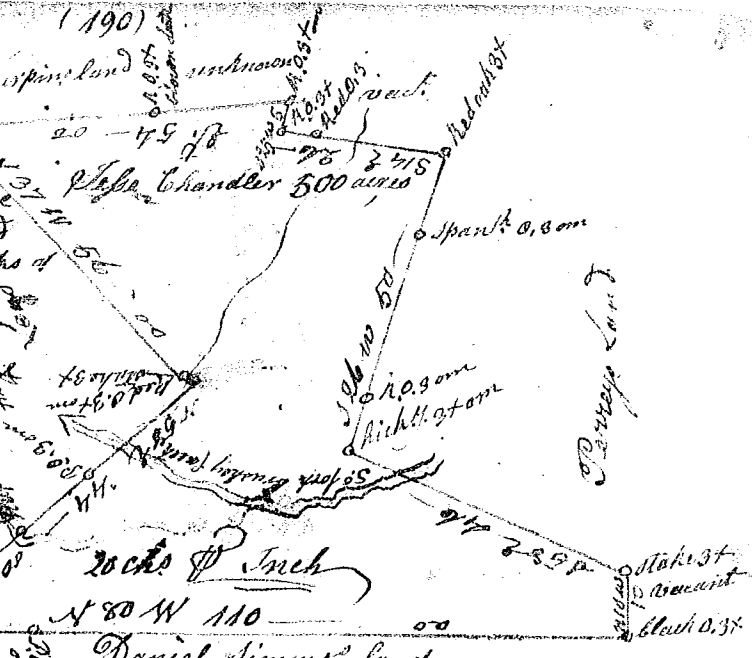

Recorded 13th May 1792 Survey 14th Aug 1791 J. W. D. Thomas Del

State of S^c Carolina Ninety Six District

Pursuant to a warrant from John Thomas Com^r of loc^l for the N^c Side Saluda dated 29th March 1792, I have laid out unto John Hunt a tract of land containing 955 acres of land in Greenville County on both sides of bruskey Creek of Needy river bounding S^E on Salodenganes land N^E on wards land N^E on tract land N^W on land laid out to William Darnel S^W on Hunts land and has such form, Marks & boundaries as the above Plat represents

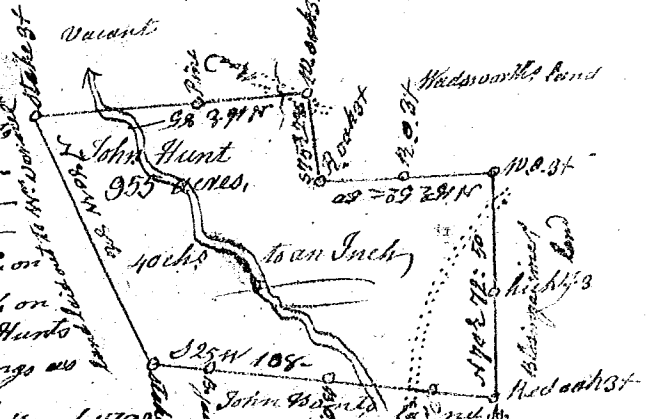

Recorded 13th May 1792 Survey 30th March 1792 J. W. D. Thomas Del

State of S^c Carolina Ninety Six District

Pursuant to a warrant from John Thomas Com^r of loc^l N^c Saluda, I have admeasured and laid out unto John Hunt a tract of 703 acres of land in Greenville County on both sides bruskey Creek of Needy river bounding N^W N^E N^W on Verne's land S^W on Seal's land S^E on Hunts land S^W on Alston's land S^E on land laid out to Young S^W on Light's land S^E on Seal's land and has such shape form Marks & boundaries as the above Plat represents



Recorded 13th May 1792 Survey 30th March 1792 J. W. D. Thomas Del

Recorded 13th May 1792 Survey 21st April 1792 J. W. D. Thomas Del

Pursuant to a warrant from John Thomas Com^r of loc^l in the District of N^c Saluda dated 23rd April 1792, I have admeasured and laid out unto John Hunt a tract of 703 acres of land in Greenville County on both sides bruskey Creek of Needy river bounding by lines running S^W on Seal's land S^W on Seal's land S^E on Hunts land and has such shape form Marks & boundaries as the above Plat represents

Recorded 13th May 1792 Survey 21st April 1792 J. W. D. Thomas Del