

Pursuant to a warrant from John Thomas Esq. Commissioner of Examinations dated the 25th day of February 1793 I have measured and laid out unto James Bruce a tract of five hundred acres of Land situate in Greenville County on both sides of Sprigs Branch of Checharba River waters of Muddy River Bounded Norwardly on land laid unto George Salmon and on William Collins Land N. Wardly on land laid unto Major John Ford and on land laid unto Henderson N. Ewardly on vacant Land and hath such shape and marks as the above Plat Represents.

Surveyed the 13th day of March 1793
George Salmon Esq.
Recorded 8th Aug. 1793
Del. C. Sullivan

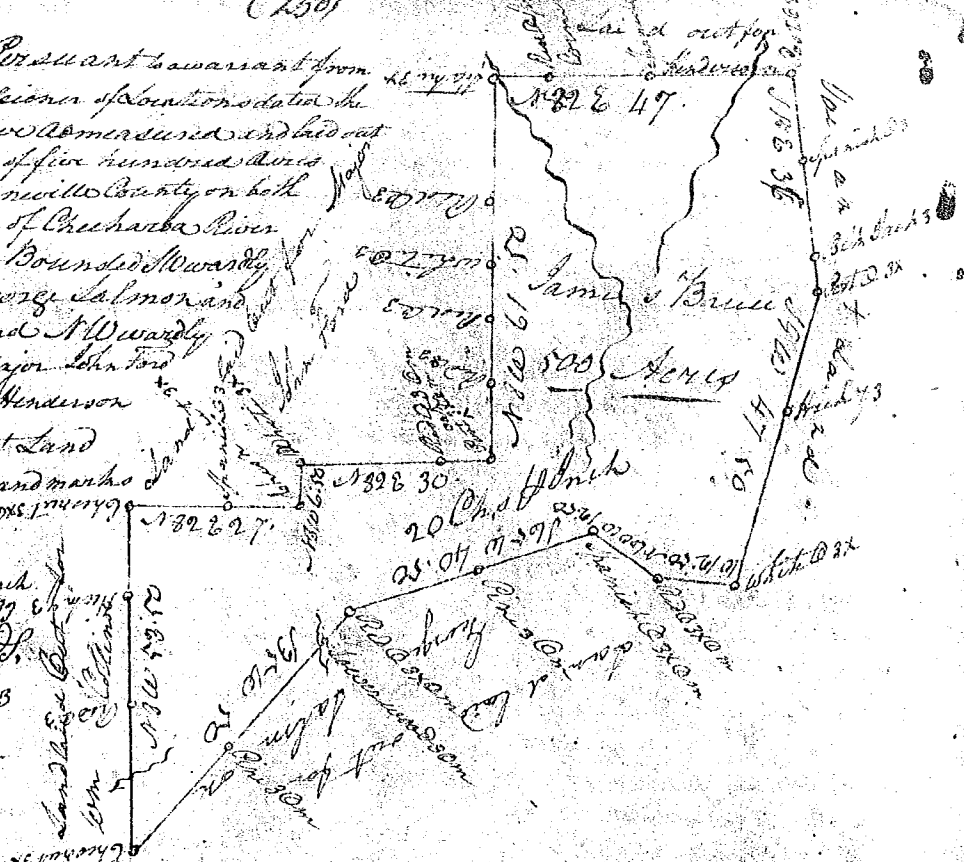

South Carolina Pursuant to a warrant from John Thomas Esq. Comr. of Exams. dated 7th Aug. 1793. I have measured and laid out unto John Leach a tract of three hundred & forty acres of land in Spartanburg County on both sides of Obacht Creek waters of N. Pacolet river bounded N. by and to the Hillins Land, W. by John Youngs Land, S. E. by John Daniels Land, S. by North Pacolet river, and hath such shape and marks as the above Plat Represents.

Recorded 12th Aug. 1793. Del. J. Young



State of S. Carolina Pursuant to a warrant from John Thomas Esq. Comr. of Exams. dated 7th Aug. 1793. I have measured and laid out unto William Roe a tract of sixty two acres of land in Greenville County on the waters of Muddy River bounded Norwardly by a line running S. W. by land laid out for Joseph Box, S. Westward by a line running S. 82 E. 112 10 by land laid out for Joseph Box, S. Ewardly by a line running N. 82 E. by land laid out for Joseph Box, and N. Ewardly on Muddy River, and hath such shape and marks as the above Plat Represents.

Recorded 13th Aug. 1793. Del. C. Sullivan

