

State of Carolina Pursuant to a warrant from John Thomas Esq. 29th July 1793. I have determined & laid out unto John Benson a tract of land containing three thousand acres situate in the District of Washington & County of Greenock on Mother's creek of the South fork of Saluda River bounding by lines running N 88° W Jersey for N 1/2 mile the also lines running S 88° W by Doubt's land, all other sides by vacant land & hath such shape & marks as the above plat represents. Witness my hand the 28th Aug 1793

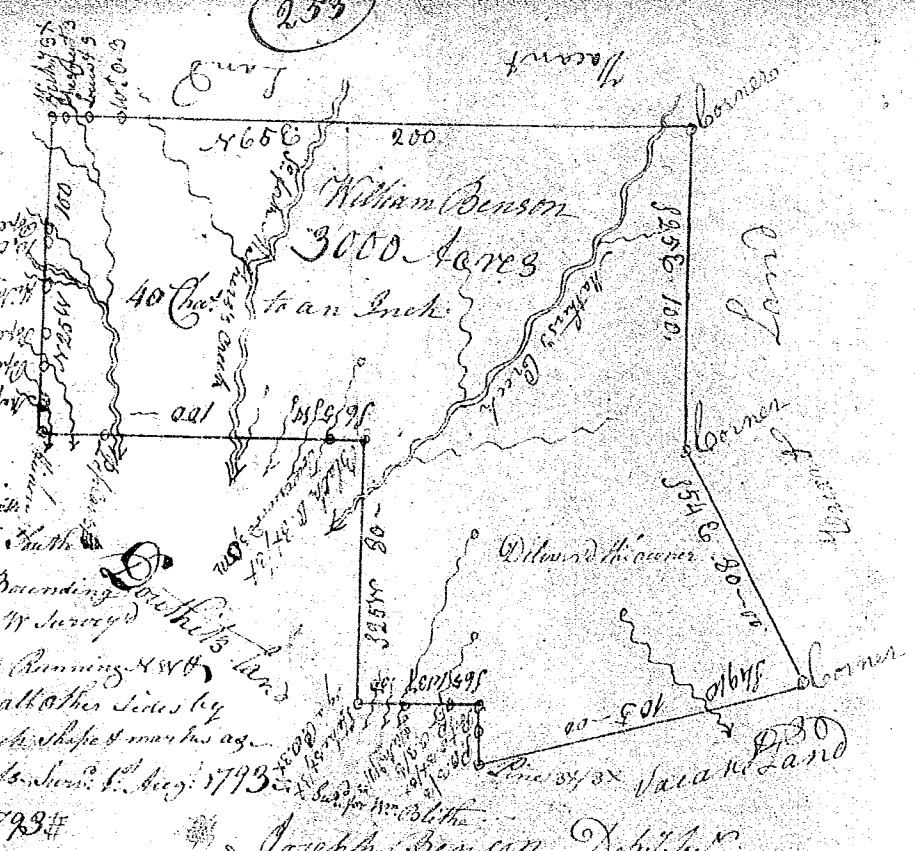

Joseph Benson Deput Sur.

State of Carolina Pursuant to a warrant from John Thomas Esq. 18th March 1793. I have determined & laid out unto John Lewis a tract of one hundred acres of land situate in the District of Spartan County on both sides of Middle Creek of the South fork of Saluda River bounded by a line running thence S 12° W 12 chains to a stake thence S 72° W 12 chains to a stake thence S 15° W 19 chains to a stake S 80° West corner, all other sides on mean land and hath such shape & form & marks as the above plat represents. Witness my hand the 30th Oct 1793

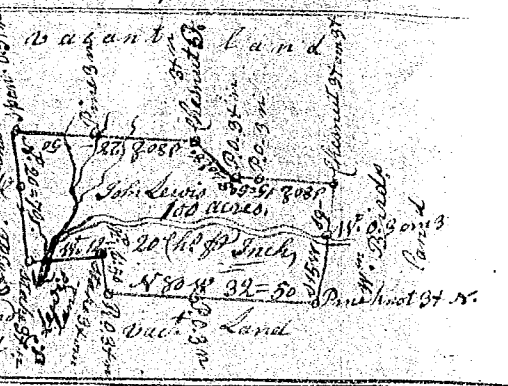

John Young Junr Deput Sur.

State of Carolina Pursuant to a warrant from John Thomas Esq. 18th March 1793. I have determined & laid out unto John Scott a tract of one hundred acres of land situate in the District of Spartan County on both sides of Middle Creek of the South fork of Saluda River bounded by a line running thence S 12° W 12 chains to a stake thence S 72° W 12 chains to a stake thence S 15° W 19 chains to a stake S 80° West corner, all other sides on mean land and hath such shape & form & marks as the above plat represents. Witness my hand the 20th of March 1793

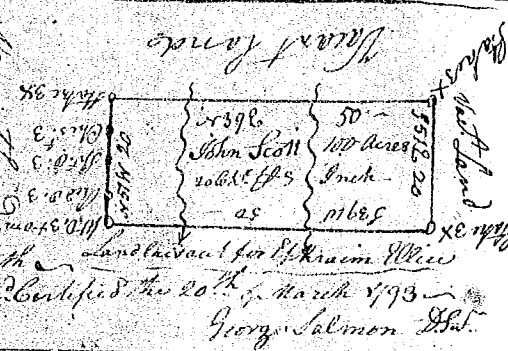

George Salmon Deput Sur.

State of Carolina Pursuant to a warrant from John Thomas Esq. 29th Aug 1793. I have determined & laid out unto David Goodlett a tract of one hundred acres of land situate in the District of Spartan County on both sides of a branch of Cypress Creek thence S 12° W 12 chains to a stake thence S 72° W 12 chains to a stake thence S 15° W 19 chains to a stake S 80° West corner, all other sides on mean land and hath such shape & form & marks as the above plat represents. Witness my hand the 29th Aug 1793

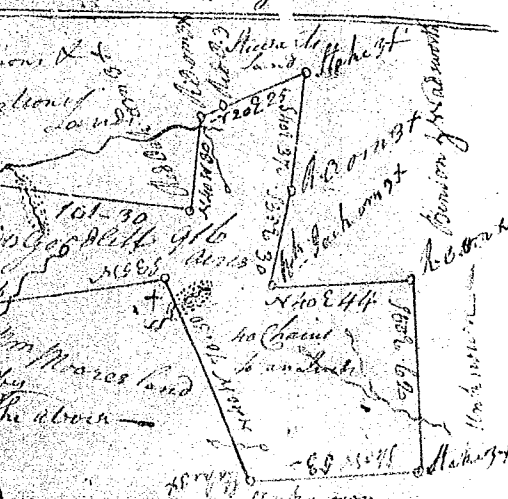

John Young Junr Deput Sur.

Recorded the 23rd Sept 1793