

South Carolina - Pursuant to a warrant from John Thomas Esq. Sheriff of the County of Greenville, a tract of One thousand acres of land situated in Greenville County on a branch of Saluda River bounded on all sides on Robert Middleton's land, & hath such shape & marks as the above plat represents. Certified the 5<sup>th</sup> Nov. 1793

Recorded the 11<sup>th</sup> Nov. 1793 - James Pitt Esq. Sheriff of the County of Greenville, a tract of One thousand acres of land situated in Greenville County on a branch of Saluda River bounded on all sides on the said Robert Middleton's land, & hath such shape & marks as the above plat represents - Certified the 5<sup>th</sup> Nov. 1793

Recorded the 11<sup>th</sup> Nov. 1793 - Pursuant to a warrant from John Thomas Esq. Sheriff of the County of Greenville, a tract of One thousand acres of land situated in Greenville County on a branch of Saluda River bounded on all sides by the said Robert Middleton's land, & hath such shape & marks as the above plat represents. Certified the 5<sup>th</sup> Nov. 1793

Recorded the 11<sup>th</sup> Nov. 1793 - Pursuant to a warrant from John Thomas Esq. Sheriff of the County of Greenville, a tract of One thousand acres of land situated in Greenville County on a branch of Saluda River bounded on all sides by the said Robert Middleton's land, & hath such shape & marks as the above plat represents. Certified the 5<sup>th</sup> Nov. 1793

Recorded the 11<sup>th</sup> Nov. 1793 - Pursuant to a warrant from John Thomas Esq. Sheriff of the County of Greenville, a tract of One thousand acres of land situated in Greenville County on a branch of Saluda River bounded on all sides on the said Robert Middleton's land, & hath such shape & marks as the above plat represents. Certified the 5<sup>th</sup> Nov. 1793

Recorded the 11<sup>th</sup> Nov. 1793 - Pursuant to a warrant from John Thomas Esq. Sheriff of the County of Greenville, a tract of One thousand acres of land situated in Greenville County on a branch of Saluda River bounded on all sides on the said Robert Middleton's land, & hath such shape & marks as the above plat represents. Certified the 5<sup>th</sup> Nov. 1793

Recorded the 11<sup>th</sup> Nov. 1793 - Pursuant to a warrant from John Thomas Esq. Sheriff of the County of Greenville, a tract of One thousand acres of land situated in Greenville County on a branch of Saluda River bounded on all sides on the said Robert Middleton's land, & hath such shape & marks as the above plat represents. Certified the 5<sup>th</sup> Nov. 1793

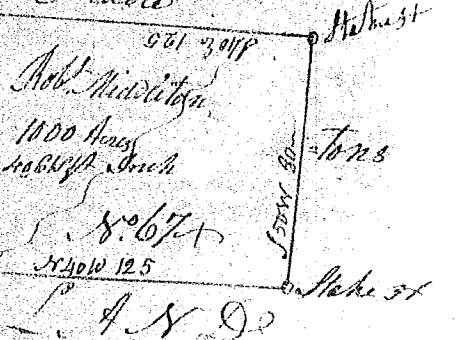
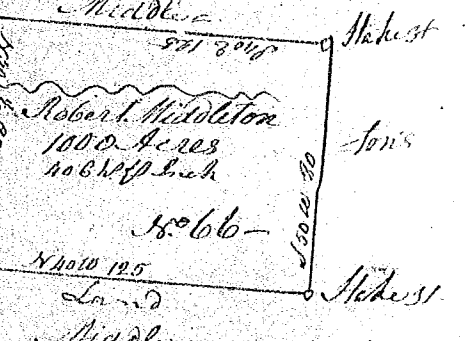
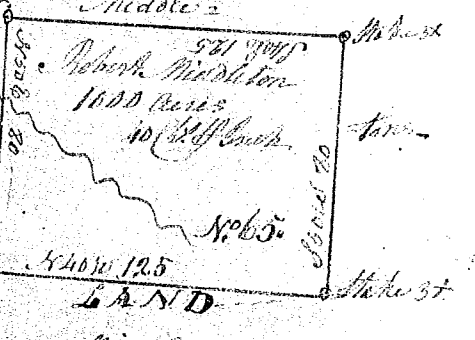
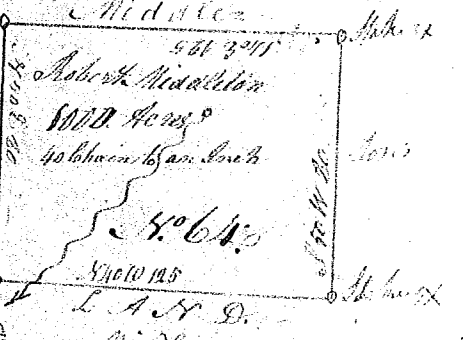
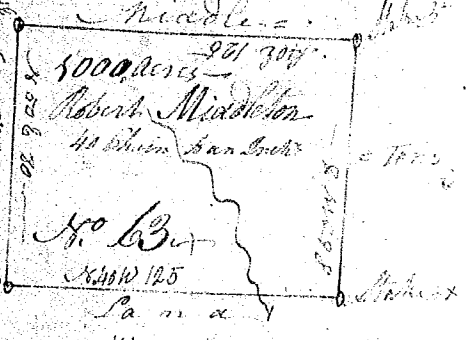
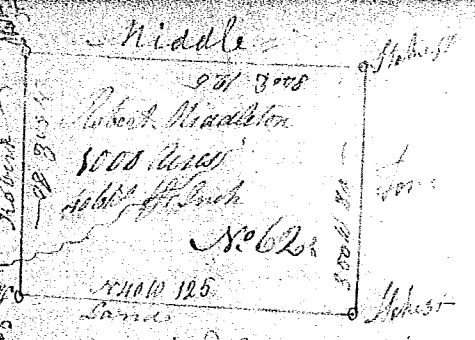

Robert Middleton

Middle No. 62  
Middle No. 63  
Middle No. 64  
Middle No. 65  
Middle No. 66  
Middle No. 67