

St. Carolina Pursuant to a warrant from John Thomas Esq. Comr. of loc. dated 7th Aug. 1793. I have admeasured and laid out unto George Salmon a tract of Two hundred & forty six acres of land, in Greenville County on both side of Small branch of fall creek water of the Charon river of Saluda Including Part of the Mountain, bounded south by John Dacles land, all other sides vacant land, and hath such form & marks as the above Plat represents.

Witness my hand & Seal the 10th Sept. 1793.
 Recorded 27th Nov. 1793. John Young Esq. George Salmon Esq.

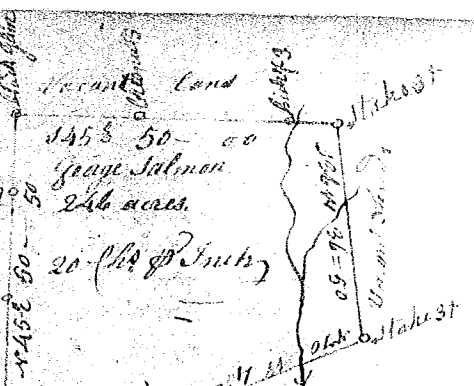

St. Carolina Pursuant to a warrant from John Thomas Esq. Comr. of Locations dated the 4th October 1793 I have admeasured and laid out unto William Burson a tract of land containing Thirty six acres, situated in Spartanburg County on a small branch of North Sygar river, Bounding by a line running S. 60 on land granted to John McEllhenny, S. W. 1/4 S. E. on Thomas Collins, S. W. on Rich. Lewis, N. W. on James Bernors N. E. on John Dacles and hath such shape and marks as the above Plat represents.

Witness my hand & Seal the 11 November 1793
 Recorded the 11 of January 1794

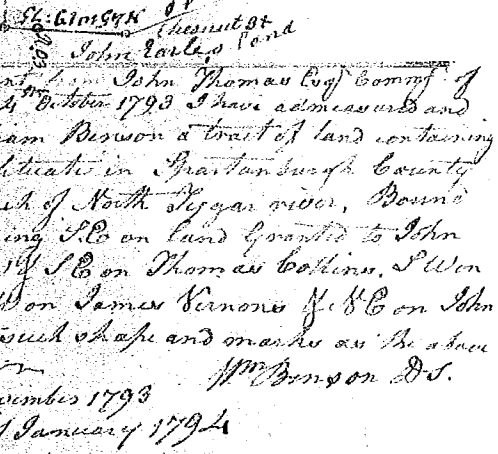

Laid down by a scale
 20 to chain of Inchs

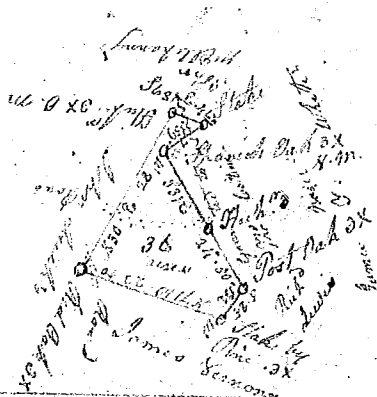

St. Carolina Pursuant to a warrant from John Thomas Esq. Comr. of loc. dated 7th Sept. 1792. I have admeasured and laid out unto Robert M. Howell a tract of Two hundred and twelve acres of land, in District of Pickens, Spartanburg County on both sides of Little creek, waters of Lawson's fork, bounded by lands laid out to Alex. Ross by a line running thence N. 46-00, and on David Lewis, S. by a line running thence S. 11-05-50, all other sides vacant and hath such shape form & marks as the above Plat represents.

Witness my hand & Seal the 25th Nov. 1792. John Young Esq. Robert M. Howell Esq.

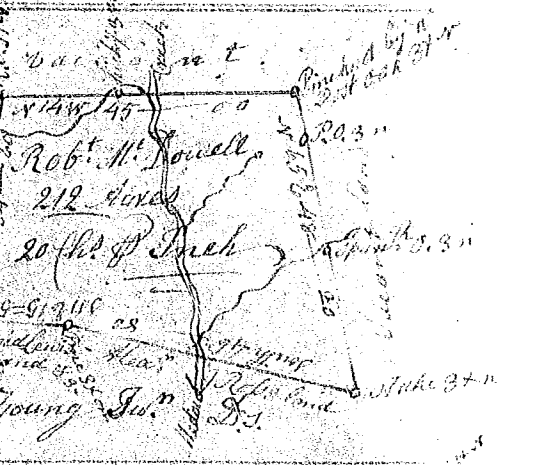

St. Carolina Pursuant to a warrant from John Thomas Esq. Comr. of Locations dated 27th Decr. 1793, I have admeasured and laid out unto William Harris a tract of one hundred acres of land in Spartanburg County on a branch of the Middle fork of Sygar river, on both sides of the great Market Road leading from Greenville County to Charleston bounding by a line running S. 70 W. by land of J. Dacles, N. E. by land said to belong to Hungerford, S. E. by land surveyed for William Hager, and hath such form & marks as the above Plat represents.

Witness my hand & Seal the 27th Decr. 1793. John Young Esq. William Harris Esq.



Recorded 31st Jan. 1794. John Young Esq. William Harris Esq.