

40
20
To Carolina Pursuant (392)
from John Thomas Esq. dated 24th
oct^r 1793, I have admeasured and
laid out unto Robert Middleton a tract
of 1000 acres of land in Greenville
County on the waters of Saluda River
on all sides by said Middleton's land
and hath such form and marks
as the above Plat represents.
Certified 31st oct^r 1793 Jas. Tell Esq.
Recorded 9th Nov^r 1793.

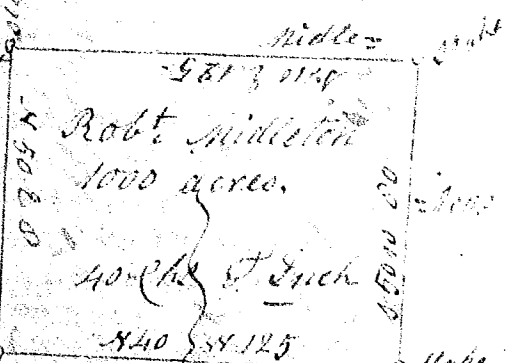

40
21
To Carolina Pursuant to order
from John Thomas Esq. dated 24th oct^r 1793 I have
admeasured & laid out unto Robert
Middleton a tract of 1000 acres of land in
Greenville County on fork of Saluda
bounded on all sides by said Middleton's
land & hath such form & mark as
the above Plat represents.
Certified 31st oct^r 1793 Jas. Tell
Recorded 9th Nov^r 1793.

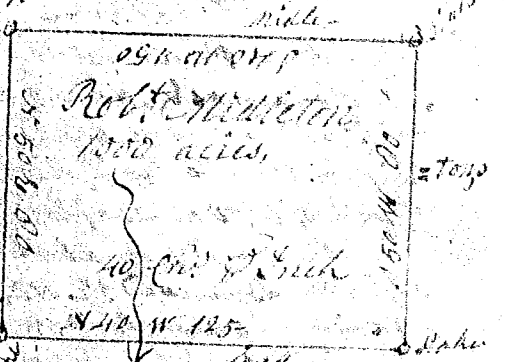

40
22
To Carolina Pursuant to order
from John Thomas Esq. dated 24th oct^r
1793, I have admeasured and laid
out unto Robert Middleton a tract of 1000
acres in Greenville County on bank
of Saluda River. Bounded on all sides
by said Middleton's land, and hath
such form & marks as the above
Plat represents. Certified 31st oct^r 1793
Jas. Tell Esq.
Recorded 9th Nov^r 1793.

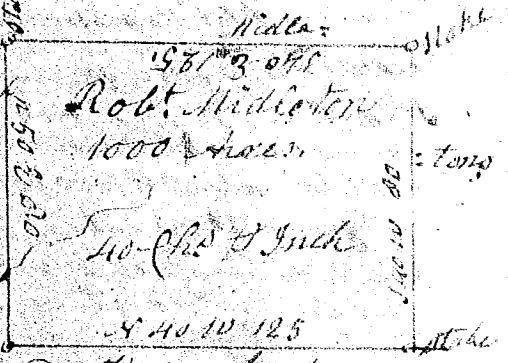

40
23
To Carolina Pursuant to a
warrant from John Thomas Esq. dated 24th oct^r 1793
I have admeasured and laid out unto
Robert Middleton a tract of 1000 acres of
land in Greenville County on a
branch of Saluda bounded on
all sides by said Middleton's land
and hath such shape form and
marks as the above Plat repre-
sents. Certified 31st oct^r 1793
Recorded 11th Nov^r 1793

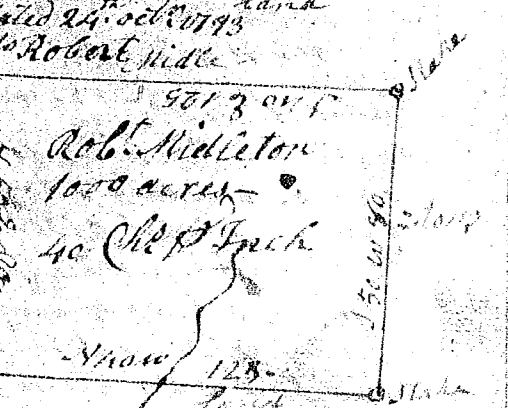

by James Tell Esq.