

(340)
 S^c Carolina Pursuant to a warrant
 from John Thomas Com^r of loc^y
 dated 19th May 1793, I have admeasured
 and laid out unto William & John
 Young a tract of 1000 acres of land
 in Washington district, Greenville
 County on both sides of water of full
 waters of the S^c fork of Saluda river
 bounded N.E. & S.W. by said Young's land
 S.E. & S.W. by vacant land, and hath such
 shape form & Marks as the above Plat
 Represents. Surveij. 15th May 1793.
 John Young Jun^r D^s
 Recorded 24th Sept^r 1794 D^s Self

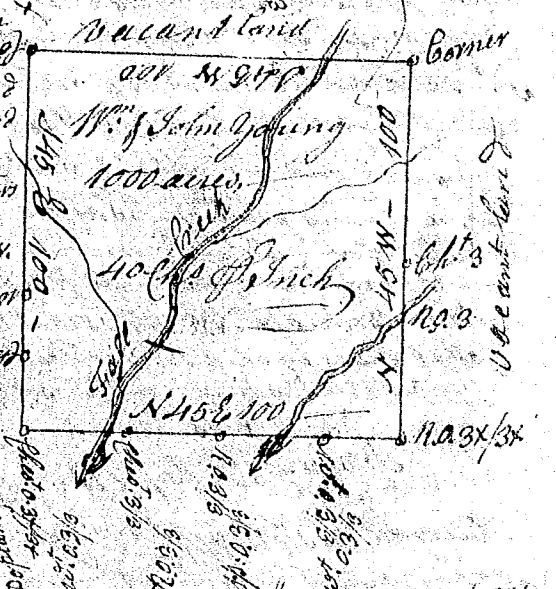

S^c Carolina Pursuant to a warrant from
 John Thomas Com^r of loc^y I have admeasured
 and laid out unto William and
 John Young a tract of 1000 acres of land
 in Washington district, Greenville
 County on both sides of full creek waters
 of Middle fork of Saluda river bounded
 S.E. & S.W. by said Young's lands N.E. & S.W.
 by vacant lands, and hath such shape form
 & Marks as the above Plat Represents. Surveij. 17th May 1793.
 John Young Jun^r D^s
 Recorded 24th Sept^r 1794 D^s Self



S^c Carolina Pursuant to a warrant
 from John Thomas Com^r of loc^y I
 have admeasured and laid out un-
 to William & John Young a tract
 of 1000 acres of land in Washington
 district Greenville County on both
 sides of full creek of the East
 fork of full creek waters of Saluda
 river bounded N.E. & S.W. by said
 Young's land, N.E. & S.E. by vacant
 land, and hath such shape form
 and Marks as the above plat
 Represents, Surveij. 18th May 1793.
 John Young Jun^r D^s
 Recorded 24th Sept^r 1794 D^s Self

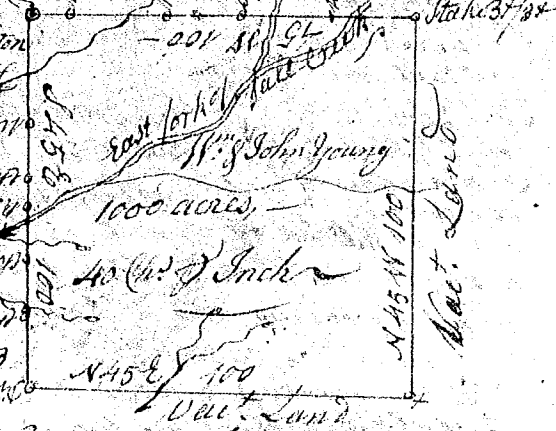

John Young Jun^r D^s
 Recorded 24th Sept^r 1794 D^s Self