

Pursuant to a warrant from John Thomas Esq. Commissioner of Locations in Washington District dated the 24 day of August 1793 I have admeasured and laid out unto Col. Middleton a tract of land in said District containing one thousand acres lying on a branch of Saluda River Greenville County and hath such shapes & marks & bearings as the above Plat represents. Surveyed this 29th day of August 1793 By Tho. L. of Lon. Esq. Recorded this 15 day of December 1794 S. Carolina

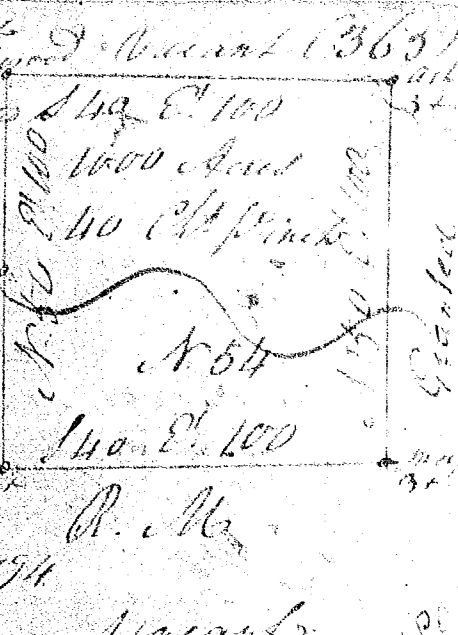

Pursuant to a warrant from John Thomas Esq. Commissioner of Locations in Washington District dated the 24 day of August 1793 I have admeasured and laid out unto Col. Middleton a tract of land in said District containing one thousand acres lying on a branch of Saluda River Greenville County and hath such shapes & marks as the above Plat represents. Surveyed this 29th day of August 1793 By Tho. L. of Lon. Esq. Recorded this 15 day of December 1794 S. Carolina

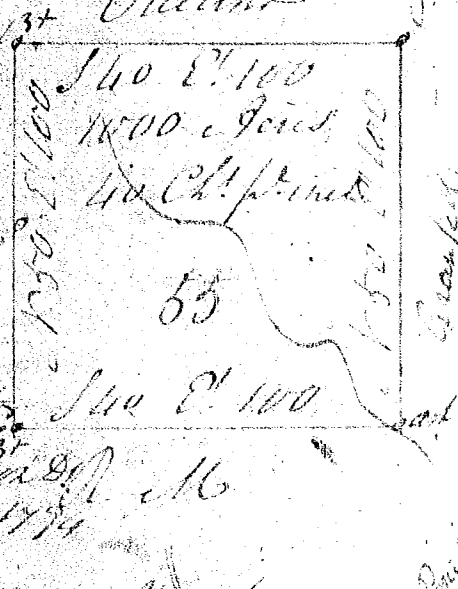

Pursuant to a warrant from John Thomas Esq. Commissioner of Locations in Washington District dated the 24 day of August 1793 I have admeasured and laid out unto Col. Middleton a tract of land in said District containing one thousand acres lying on a branch of Saluda River Greenville County and hath such shapes and marks & bearings as the above Plat represents. Surveyed this 29th day of August 1793 By Tho. L. of Lon. Esq. Recorded this 15 day of December 1794 S. Carolina

